

**SONY**<sup>®</sup>

Professional Flat Panel Monitors  
**PFM Series**  
PFM-500A3W/PFM-510A2W

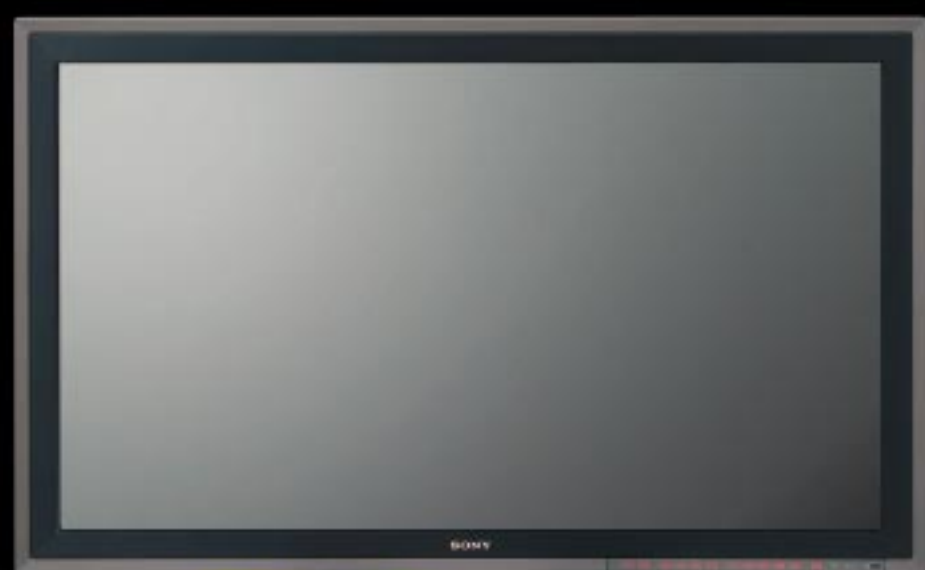



Professional  
Monitors That Will  
Capture Your  
Imagination



Present in the style and manner you've always dreamed of - not the way you've always had to - with the Sony PFM Series.

The Sony PFM Series monitors incorporate thin, lightweight 42-inch\*<sup>1</sup> flat panels with 16:9 aspect ratios to extend the flexibility of monitor applications beyond those previously imaginable. As always, Sony delivers the special features that professionals rely on - improved picture resolution with Sony's unique I/P conversion technology, a wide range of signal support, including a variety of DTV formats and computer signals, via a new high performance scan converter, and extra versatility with an option slot to accept optional adaptors.

The PFM Series includes two models\*<sup>2</sup>: the PFM-500A3W, with a resolution of 852 x 480 pixels, and the PFM-510A2W, with a resolution of 1024 x 1024 pixels. Whether used as multi-source information monitors, presentation monitors, or wall-mounted video displays, the PFM Series monitors are exciting visual tools that will expand your application horizons.

\*<sup>1</sup> Viewable area, measured diagonally.

\*<sup>2</sup> The PFM-500A3W and PFM-510A2W are each available in two models: the U models (PFM-500A3WU/510A2WU) for countries operating at AC 100-120 V, and the G models (PFM-500A3WG/510A2WG) for countries operating at AC 220-240 V.

# PFM-500A3W

## Versatile and Flat Information Solution

With its lightweight and flat design, the PFM-500A3W offers you a more versatile information solution.



### Bright Flat Panel

The PFM-500A3W incorporates a bright flat panel, allowing you to view clearer, brighter images than ever before. The front filter glass has an anti-reflection finish to reduce diffused light reflection on the panel.

852  
x  
480  
pixels

# PFM-510A2W

## Bright and Precise Visual Experience

Incorporating the superior features of the Sony PFM Series, the PFM-510A2W provides an impressive visual experience with its high-resolution, bright flat panel.



### High Resolution Flat Panel

The PFM-510A2W incorporates a high resolution flat panel with 1024 x 1024 pixels, providing an impressive visual experience with bright, sharp clarity and dramatic fine detail. The high-resolution panel used in the PFM-510A2W also achieves even higher brightness.

1024  
x  
1024  
pixels



# PFM Series Features for Superior Performance

## High Performance Scan Converter

The PFM Series monitors utilize a new, high-performance scan converter to increase the range of supported signals, including a variety of DTV formats and computer signals up to UXGA\*. Exact pixel sampling from the original input source enables high quality pixel-by-pixel image reproduction. Combined with Sony's new I/P conversion technology, the result will be higher resolution pictures with enhanced details.

\* For a complete list of accepted signals, please refer to the preset signals chart.



## Option Slot

The option slot gives the PFM Series tremendous flexibility in combination with the optional adaptor.

Since optional plug and play adaptors can be added, the range of PFM Series applications will continue to grow.

## Easy Handling

Each PFM Series monitor is equipped with four carrying handles on the rear side. With unique retractable feet, the monitor can be moved and installed with a minimum of effort and with no additional devices.



## Additional Features

In addition to the above features, the PFM Series offers a range of features that are of key importance to professional applications.

- Six-Language On-Screen Display  
English, French, German, Italian, Japanese and Spanish
- Picture Control
- Size Control  
Picture size is adjustable, both horizontally and vertically
- Selectable Aspect Ratio  
The aspect ratio is selectable between widescreen 16:9, wide zoom and standard 4:3 aspect ratios
- Picture ZOOM
- Easy Maintenance Access
  - Self diagnosis function  
STATUS menu / service code indicator / RS-232C port
  - Detachable power supply block
  - Easily accessible cooling fan, enabling quick and easy maintenance
- Memory Save/Load  
Up to 20 picture settings can be saved and named individually
- Various Remote Control Capabilities  
The PFM Series can be controlled by the Sony RM-921 remote control unit (supplied) or via CONTROL S or RS-232C
- Wide Power Supply Range  
Accepts AC 100 to 120 V, 220 to 240 V  
(UL listed for 100 to 120 V operation)
- 7 W + 7 W Built-in Amplifier
- Audio Monitor Out  
For connection to external audio equipment
- Precise Temperature Adjustment  
Up to six color temperature settings can be registered and named
- Dot Phase Adjustment  
Optimizes the scan converter sampling phase to the input signal for more detailed pictures
- 24 hour On/Off Timer
- Closed Caption Decoder
- Screen Saver Function  
Picture Orbiting and Picture Inversion are available



PFM-500A3W/510A2W  
Connector Panel



On-Screen Display



RM-921 Remote Control Unit



Control Panel

# Flat Panel Advantages

These monitors adopt Plasma Display Panels - innovative flat panel technology that is sure to exceed your expectations.

- Lightweight & compact design**

The thin and lightweight flat panel gives PFM Series monitors a compact body. Thus, superb images can be enjoyed with a minimal space requirement.

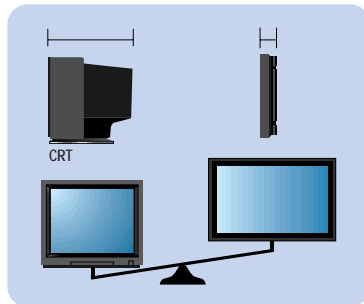

- Clear and even pictures**

Because of the linear alignment of the light-emitting pixels, accurate pictures are reproduced without distortion.

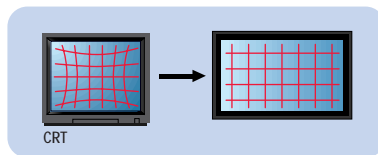

- Wide viewing angle**

There is a wide viewing angle of 160 degrees in all directions. The clear pixel-by-pixel images appeal to large audiences in many different applications.

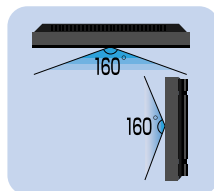

- Resistance to magnetic influence**

Flat panel monitors can be installed in areas where the effects of magnetic field are prevalent, without experiencing interference such as color uniformity drift. These effects are caused by equipment employing magnets such as motors or speakers, or high-tension electrical wires. Unlike conventional CRTs, flat panels are free from such disturbances.

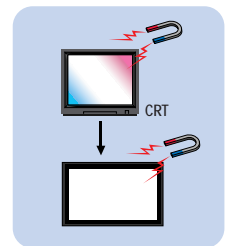

# Optional Accessories



## SS-X500A

Speaker System (PAIR)

- Can be attached to the monitor or mounted separately in a variety of positions
- Effective frequency range: 70 Hz to 20000 Hz
- Characteristic sensitivity level: 88 dB (1 W, 1 m)
- Input capability: 120 W

Dimensions: 159 (W) x 634 (H) x 90.3 (D) mm  
(2 1/4 x 25 x 3 5/8 inches)

Mass: Approx. 3.5 kg per speaker  
(Approx. 7 lb 11 oz)



## BKM-501D

SDI 4:2:2 Input Adaptor

- Enables SDI video and audio decoding in compliance with SMPTE 259M/ITU-R BT.656
- Analog input capability: VIDEO (composite, Y/C, YUV, RGB), HDTV (Y/PB/PR) and PC (RGB, HD/VD (5 BNC))
- Self-diagnosis function

## Dimensions

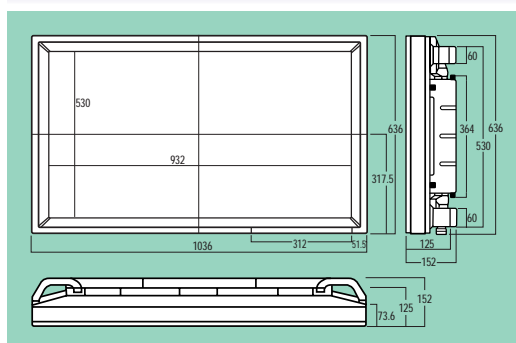

## MB-514

Mounting Bracket

- For wall-mounting installation
- Monitors can be tilted 0 to 20 degrees downward from the wall in 7 locking steps for added safety
- Separate parts for easy installation
- Shock-absorbing gas damper for safety operation

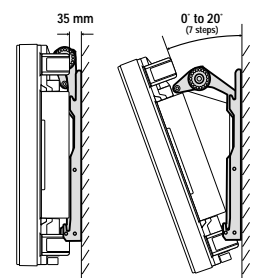

# Specifications

		PFM-500A3W	PFM-510A2W
<b>Picture performance</b>			
<b>Panel</b>	<b>Resolution</b>	852 x 480 pixels	1024 x 1024 pixels
	<b>Pixel pitch</b>	1.08 x 1.08 mm	0.90 x 0.51 mm
	<b>Active area (W/H)</b>	920 x 518 mm	
	<b>Viewable picture area</b>	42-inch/1,056 mm (measured diagonally)	42-inch/1,058 mm (measured diagonally)
	<b>Driver</b>	8-bit RGB	10-bit RGB
	<b>Colors</b>	16.8 million colors simultaneously	
	<b>Type</b>	AC-type plasma display panel with anti-reflection screen	
<b>Color system</b>		NTSC/PAL/SECAM/NTSC4.43/PAL60	
<b>Sampling rate</b>		13.5 to 140 MHz	
<b>Input/Output</b>			
<b>RGB 1</b>	BNC connectors		
	<b>RGB</b>	0.714 Vp-p/non-composite, 1 Vp-p/composite, 75 Ω automatic termination, loop-through	
	<b>YUV</b>	0.7 Vp-p/non-composite (U/V), 1 Vp-p/composite (Y), 75 Ω automatic termination, loop-through	
	<b>HD/COMP, VD</b>	H (or composite) sync, V sync, 1 - 5 Vp-p, high impedance, loop-through	
	<b>Audio (L/R)</b>	Phono, 500 mV rms, high impedance, loop-through	
<b>RGB 2</b>	D-sub 15-pin connector		
	<b>RGB</b>	0.714 Vp-p/non-composite, 75 Ω, 1 Vp-p/composite	
	<b>External sync</b>	H (or composite) sync, V sync, 1 - 5 Vp-p, high impedance, loop-through	
	<b>Audio (L/R)</b>	Phono, 500 mV rms, high impedance, loop-through	
<b>LINE</b>	<b>Composite</b>	BNC connector, 1 Vp-p, sync negative, 75 Ω automatic termination, loop-through	
	<b>Y/C</b>	Mini DIN 4-pin connector, Y: 1 Vp-p, sync negative, C: 0.286 Vp-p (NTSC)/0.3 Vp-p (PAL), 75 Ω automatic termination, loop-through	
	<b>Audio (L/R)</b>	Phono, 500 mV rms, high impedance, loop-through	
<b>Sync signal</b>		External H/V separate sync or composite sync, Sync-on-Green (automatically selected) * Tri-level sync is available for HDTV	
<b>Audio output</b>	<b>Speakers terminal</b>	6 to 16 Ω, 7 W + 7 W (at 8 Ω)	
	<b>Monitor out (L/R)</b>	Phono, 500 mV rms at volume max., attenuation 0 dB to ∞ (variable), total harmonic distortion less than 1 %	
<b>Remote</b>	<b>RS-232C</b>	Mini DIN 8-pin	
	<b>Control S IN/OUT</b>	Stereo Mini jack, 5 Vp-p	
<b>General</b>			
<b>Power requirements/consumption</b>	AC 100 to 120 V, 220 to 240 V ± 10 %, 50/60 Hz		
		U model: 100 to 120 V, 3.9 A, 380 W G model: 220 to 240 V, 2.0 A, 360 W	U model: 100 to 120 V, 4.7 A, 410 W G model: 220 to 240 V, 2.2 A, 400 W
<b>Operating temperature</b>	0 to 35 °C (32 to 95 °F)		
<b>Storage temperature</b>	-10 to 40 °C (14° to 104 °F)		
<b>Humidity</b>	20 to 90%, no condensation		
<b>Dimensions (W/H/D)</b>	1036 x 636 x 152 mm (40 3/4 x 25 x 6 3/4 inches)		
<b>Mass</b>	Approx. 45 kg (Approx. 99 lb 3 oz)		
<b>Supplied accessories</b>			
AC power cord (1)/AC plug holder (1)/Remote commander RM-921 with two AA (R6) batteries (1)/Connector cover (2)/Foot support bracket (2)/Ferrite core (2)/Operation manual (1)			
<b>Regulation compliance</b>			
UL 1950 listed, CSA 22.2 No.950, TÜV EN 60 950 (CE LVD), C-Tick, FCC Class A, IC Class A, EN 55 022 Class-A/EN 50 082-2/EN 60 555-2(CE EMC), VCCI-A			

<b>Preset Signals</b>							
VIDEO	fH (kHz)	Frame rate* (Hz)	Resolution (Active)	COMPUTER INPUT	fH (kHz)	fV (Hz)	Resolution (Active)
NTSC	15.734	60	483 lines	VGA (VGA TEXT)	31.5	70	720 x 400 dots
PAL	15.625	50	575 lines	720 x 400 @85 (VESA STD)	37.9	85	720 x 400 dots
SECAM	15.625	50	575 lines	800 x 600 @56 (VESA STD)	35.2	56	800 x 600 dots
NTSC4.43	15.734	60	483 lines	800 x 600 @60 (VESA STD)	37.9	60	800 x 600 dots
PAL60	15.734	60	483 lines	800 x 600 @72 (VESA STD)	48.1	72	800 x 600 dots
1080/24PsF	27.000	24	1080 lines	800 x 600 @75 (VESA STD)	46.9	75	800 x 600 dots
1080/50I	28.125	50	1080 lines	800 x 600 @85 (VESA STD)	53.7	85	800 x 600 dots
575/50P	31.250	50	575 lines	Mac 16"	49.7	75	832 x 624 dots
480/60P	31.469	60	483 lines	1024 x 768 @60 (VESA STD)	48.4	60	1024 x 768 dots
1080/60I	33.750	60	1080 lines	1024 x 768 @70 (VESA STD)	56.5	70	1024 x 768 dots
720/60P	45.000	60	720 lines	1024 x 768 @75 (VESA STD)	60.0	75	1024 x 768 dots
<b>COMPUTER INPUT</b>	<b>fH (kHz)</b>	<b>fV (Hz)</b>	<b>Resolution (Active)</b>	1024 x 768 @85 (VESA STD)	68.7	85	1024 x 768 dots
VGA-1 (VGA 350)	31.5	70	640 x 480 dots	1152 x 864 @75 (VESA STD)	67.5	75	1152 x 864 dots
640 x 350 @85 (VESA STD)	37.9	85	640 x 350 dots	Mac 21"	68.7	75	1152 x 870 dots
640 x 400 @85 (VESA STD)	37.9	85	640 x 400 dots	1280 x 960 @60 (VESA STD)	60.0	60	1280 x 960 dots
640 x 480 @60 (VESA STD)	31.5	60	640 x 480 dots	1280 x 960 @85 (VESA STD)	85.9	85	1280 x 960 dots
Mac 13"	35.0	67	640 x 480 dots	1280 x 1024 @60 (VESA STD)	64.0	60	1280 x 1024 dots
640 x 480 @72 (VESA STD)	37.9	73	640 x 480 dots	1280 x 1024 @75 (VESA STD)	80.0	75	1280 x 1024 dots
640 x 480 @75 (VESA STD)	37.5	75	640 x 480 dots	1280 x 1024 @85 (VESA STD)	91.1	85	1280 x 1024 dots
640 x 480 @85 (VESA STD)	43.3	85	640 x 480 dots	1600 x 1200 @60 (VESA STD)**	75.0	60	1600 x 1200 dots

\* Compatible with 1/1.001.

\*\* Dot phase adjustment not applicable to UXGA (1600 x 1200).

## Distributed by

© 2000 Sony Corporation. All rights reserved.  
 Reproduction in whole or in part without permission is prohibited.  
 Features and specifications are subject to change without notice.  
 All non-metric weights and measures are approximate.  
 Sony is a registered trademark of Sony Corporation.  
 Mac is a registered trademark of Apple Computer, Inc.