

SONY®

SpectaProof
Digital Color Printer
UP-D9500



A Digital Color Printer with High Q

Dual mode versatility gives you the choice of vibrant color reproduction using dye sublimation technology or an economical simulation of off-set printing using variable



SpectaProof

Quality and Great Versatility

le dot printing.

Selectable Printing Methods

Dye Sublimation for Brilliant Color Prints

The Sony UP-D9500 with dye sublimation media provides full, 24-bit continuous tone CMYK printing. From your first color test to your final contract proof, advanced dye sublimation printing technology provides you vibrant, clear, reliable color reproduction on standard glossy paper.



Dye sublimation printing

Variable Dot Printing for Off-Set Print Matching

The UP-D9500 with variable dot printing technology produces a print that is similar in dot size, and finish to off-set printing. Ideal for proofing layouts, image data, color and off-set print work, variable dot printing is accurate, consistent and economical.



Variable dot printing

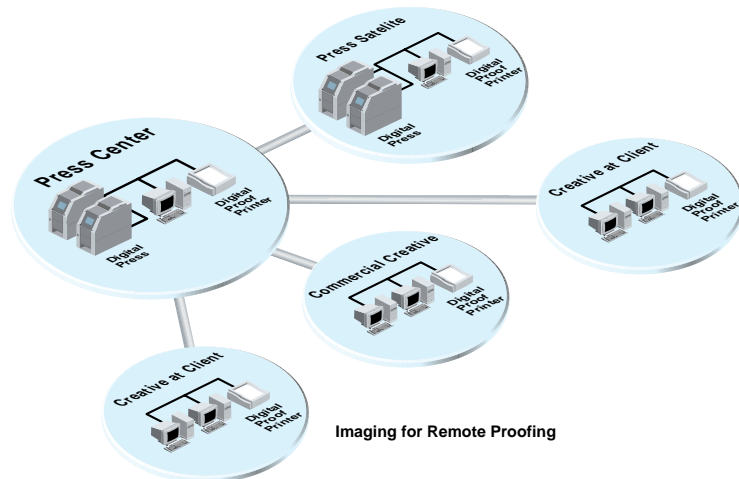

Imaging for Remote Proofing

Stable Color Reproduction

Consistent color reproduction is critical for any proofing application. From remote proofing applications with multiple matched printers to a single in-house system, the UP-D9500 delivers precise color registration and color consistency by utilizing two unique technologies: (1) a Sony Paper Chucking Drum which establishes precise paper registration during the printing process; and (2) automatic ribbon lot compensation which adjusts the printer for minor variation in media production lots. These two unique features coupled with the advanced design of the UP-D9500 ensure consistent, accurate color prints, print after print.

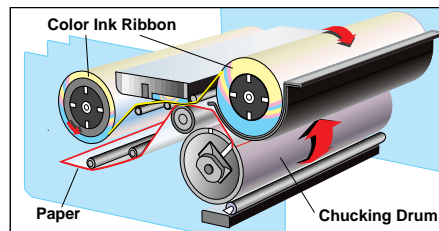

Large Print Area and Paper Size Ideal for Proofing

With an image size of 458 x 323 mm (18 1/8 x 12 3/4 inches) on paper measuring 523 x 330 mm (20 5/8 x 13 inches), half-inch registration marks and color patches can be easily printed alongside a standard two page spread. This gives you the color controls and versatility you need for professional proofing.

* A4++ print paper for A4 and letter size proof will soon be available.

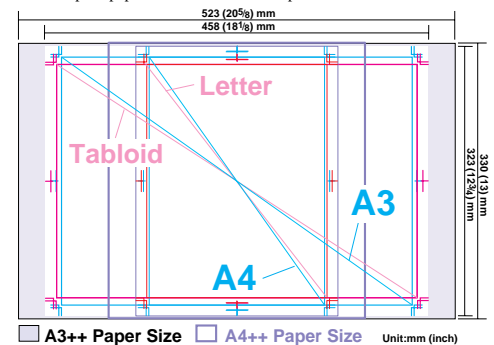

Flexible Color Matching

The UP-D9500 incorporates standard preset color tables such as SWOP, Commercial, JapanColor and EuroColor, ideal for press color matching. Beyond these standard color tables, you can achieve a precise simulation of a target press by creating an original color table. This is done measuring press proofs of IT8.7/3 color patches via a spectrophotometer, such as the Gretag Spectrolino & SpectroScan, and downloading this table to the UP-D9500.

A Variety of Professional Interfaces

- Compatibility with Macintosh™ and Windows™ 95/NT operation systems
- Quick Data Transfer supporting EtherTalk 10Base5 and 10Base-T
- Incorporates Adobe® PostScript® Level 2 Interpreter
- Large capacity HDD (Hard Disk Drive) for spool printing and font downloads
- Supports DCS (Desktop Color Separation) format file



Digital Color Printer UP-D9500

Specifications

Printing method:	Dye sublimation thermal transfer Variable dot thermal transfer
Resolution:	300 x 300 dpi, 300 x 600 dpi (dye sublimation only)
Gradation:	256 gradations for Yellow, Magenta, Cyan and Black
Printing paper size:	A3++ : 330 x 523 mm (13 x 20 5/8 inches) A4++ ^{*1} : 330 x 307 mm (13 x 12 1/8 inches)
Printed picture size:	A3++ : Max. 323 x 458 mm (12 3/4 x 18 1/8 inches) A4++ ^{*1} : Max. 323 x 242 mm (12 3/4 x 9 5/8 inches)
Picture elements:	Max. 3810 x 5408 dots (300 x 300 dpi mode), 3810 x 10816 dots (300 x 600 dpi mode)
Picture memory:	32 MB ^{*2}
HDD:	2 GB
Printing time:	A3++ : Approx. 250 seconds (300 x 300 dpi mode) A4++ ^{*1} : Approx. 170 seconds (300 x 300 dpi mode)
Interface port^{*3}:	LocalTalk, Parallel, 10 Base-T, 10 Base5, SCSI
Power requirements:	UC: 120 V, 50/60 Hz CE: 220 to 240 V, 50/60 Hz
Power consumption:	UC: 3.3 A CE: 1.8 A
Dimensions:	510 (W) x 310 (H) x 642(D)mm (20 1/8 x 12 1/4 x 25 3/8 inches)
Mass:	40 kg (88 lb 3 oz)
Safety regulations:	UC: UL1950, CSA C22.2 No.950 CE: EN60950
Supplied software:	(For Macintosh OS and Windows 95/NT OS) PS Printer driver, PPD file and PDF file for QuarkXPress™ Photoshop® Plug-in Module Network/Color Matching Utility and IT8.7/3 color patch digital data ICC profile (2) On-line Manual in Adobe Acrobat®'s PDF format
Supplied accessories:	Ink Ribbon Holder Paper Tray (1) AC Power Cable Operation Manual
Optional accessories:	A3++ Size Dye Sublimation Print Paper (60 sheets x 3 packs) UPP-9510 A3++ Size Dye Sublimation Color Ink Ribbon (180 prints) UPR-9510 A4++ Size Dye Sublimation Print Paper(60 sheets x 4 packs) UPP-9511 ^{*1} A4++ Size Dye Sublimation Color Ink Ribbon (240 prints) UPR-9511 ^{*1} A3++ Size Variable Dot Print Paper (60 sheets x 3 packs) UPP-9550 A3++ Size Variable Dot Color Ink Ribbon (180 prints) UPR-9550 A4++ Size Variable Dot Print Paper (60sheets x 4 packs) UPP-9551 ^{*1} A4++ Size Variable Dot Color Ink Ribbon (240 prints) UPR-9551 ^{*1} Ink Ribbon Holder (with cover) UPA-9500 Add-On Memory Kit (32 MB) UPK-9500

^{*1} Will soon be available.
^{*2} Using the optional UPK-9500 add-on Memory Kit, the picture memory of the UP-D9500 will be expandable up to 128 MB. In 300 x 600 dpi mode during dye sublimation printing, the UP-D9500 requires 64 MB of picture memory.

Windows is a trademark of Microsoft Corporation.
Macintosh, EtherTalk and LocalTalk are trademarks of Apple Computer Inc.
Adobe, PostScript, Photoshop and Acrobat are trademarks of Adobe Systems Incorporated.
QuarkXPress is a trademark of Quark, Inc.

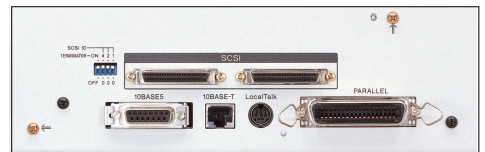

Rear Panel Connector Section

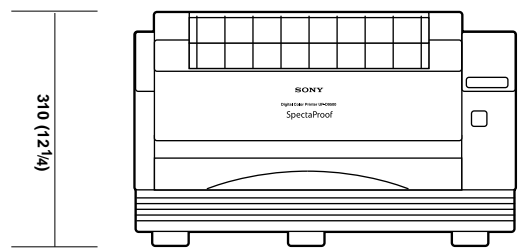
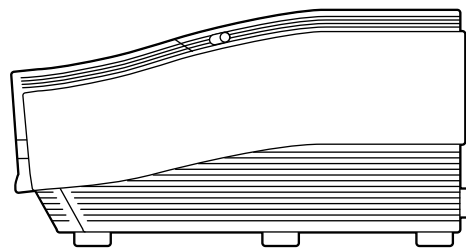
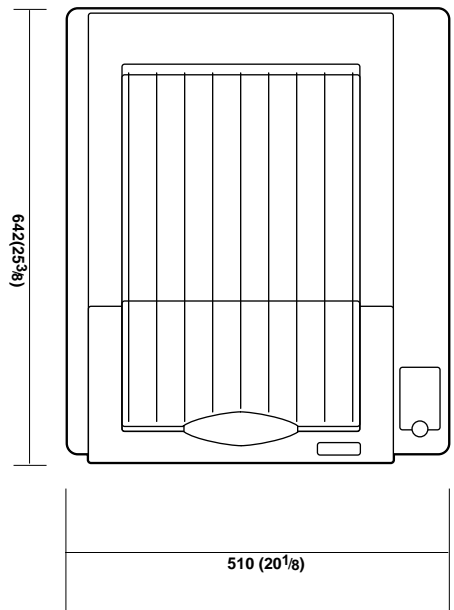

Unit:mm (inch)



Adobe PostScript

Distributed by

Features and specifications subject to change without notice.
Reproduction in whole or in part without written permission is prohibited. All rights reserved. Sony is a trademark of Sony Corporation.