



RRM18U

Good construction doesn't go out of style. That's our MO and that's why we create cases that are done right. Designed with a 10U slanted top rack for convenient mixer/CD controller placement and a 18U vertical rack for amp or effect units, the RRM6U is built right. The RRM18U features an 18" rack depth and 2 heavy-duty removable covers. To make a good thing even better we added a unique removable, rear hinged door for easy access to your gear. At last, connections without a hassle.

Rugged Road Ready

Features

- * Beefy, Stackable Ball Corners
- * Double Anchor Industrial Rivets
- * Recessed, Industrial Grade Latches
- * Recessed, Spring Loaded Handles
- * Industrial Grade Rubber Feet
- * Premium 3/8" Vinyl Laminated Plywood
- * Tongue and Groove Locking Fit
- * Heavy Duty rack rails
- * Hinged Rear Door
- * Mounting Hardware Included
- * ATA 300 Rating
- * Road Ready Limited Lifetime Warranty

Shipping Dimensions (inch): 21.9" X 24.2" X 55.1"

Shipping Weight (lbs): 77.9 lbs

Product Dimensions (inch): 21.5" x 23.9" x 43.3"

Product Weight (lbs): 65.3 lbs

Shipping Dimensions (cm): 55.5 x 61.5 x 140

Shipping Weight (kg): 35.4 kg

Product Dimensions (cm): 54.5 x 60.8 x 110.1

Product Weight (kg): 29.7 kg

3/2004

10U Slant /18U Vertical Rack Case

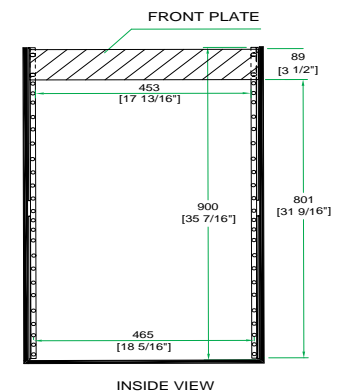
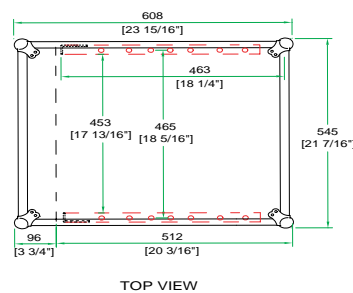
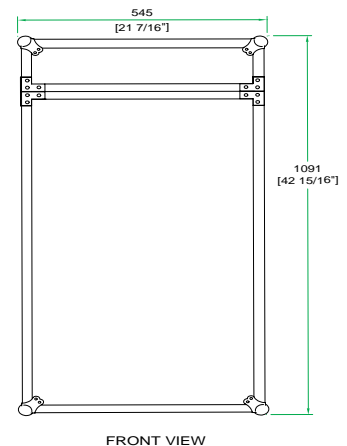
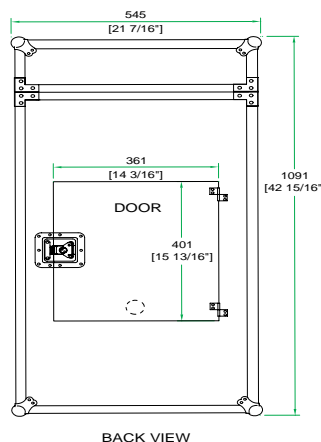
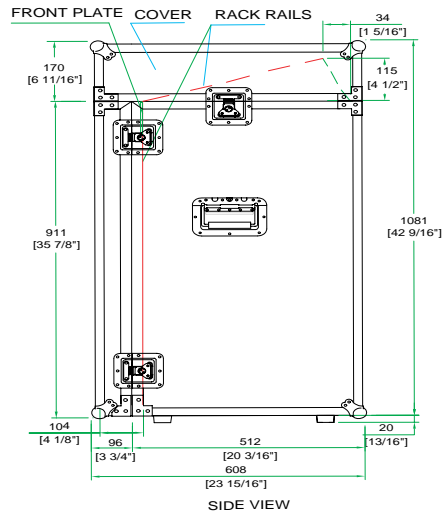

Need optional Road Ready Accessories to help outfit your Slant Rack? Check out our Road Ready Caster Kit (RRWAD) , Rolling Base with Storage Drawer (RR6WD) and Road Ready Side Wings (RRMW)

www.roadreadycases.com

Road Ready Cases 18120 S. Broadway St. Unit B Gardena, Ca. 90248-3536
ph: 310 767 1772 fax: 310 767 1798