



Built for the rigors
of the road

RRCD100

Raw-edged style and protection, the RRCD100, can handle it all. This rugged, ATA style case features a smart four row design that allows you to carry 100 CD's in jewel cases or 400 CD's in view packs. Rugged Road Ready features such as beefy, stackable ball corners, double anchor industrial rivets, recessed industrial grade latches, a spring loaded handle, and premium 3/8" vinyl laminated plywood construction, and tongue and groove locking fit seal the deal. The perfect storage solution!

Rugged Road Ready Features

- * Beefy, Stackable Ball Corners
- * Double Anchor Industrial Rivets
- * Recessed, Industrial Grade Latches
- * Recessed, Spring Loaded Handles
- * Industrial Grade Rubber Feet
- * Premium 3/8" Vinyl Laminated Plywood
- * Tongue and Groove Locking Fit
- * ATA 300 Rating
- * Road Ready Limited Lifetime Warranty

Shipping Dimensions (inch): 26.8" x 16.5" x 9.6"

Shipping Weight (lbs): 29.7 lbs

Product Dimensions (inch): 26.5" x 16.2" x 8.9"

Product Weight (lbs): 26.8 lbs

Shipping Dimensions (cm): 68 x 42 x 24.5

Shipping Weight (kg): 13.5 kg

Product Dimensions (cm): 67.2 x 41.2 x 22.7

Product Weight (kg): 12.2 kg

5/05

4 Row Deluxe CD Case Holds 100 Jewel Case CD's or 320 CD's in Sleeves

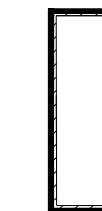
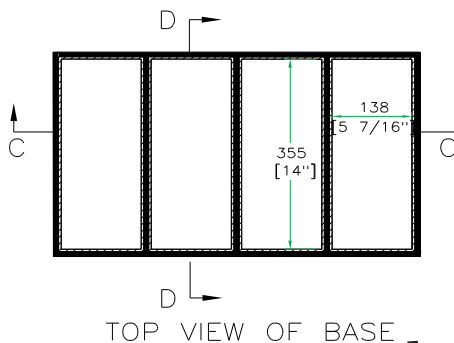
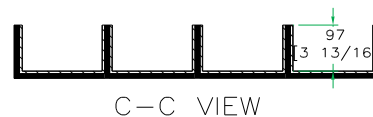
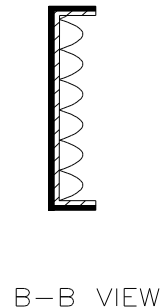
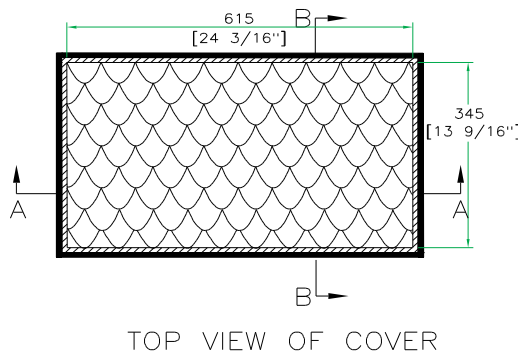
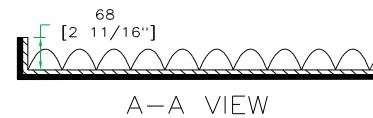
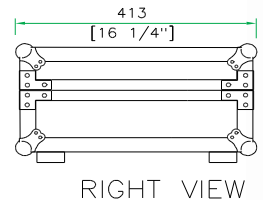
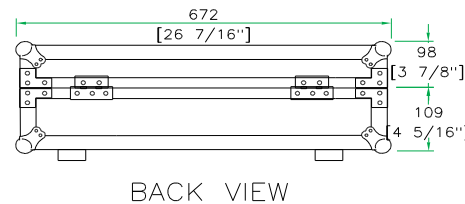
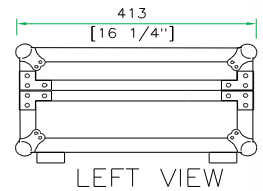
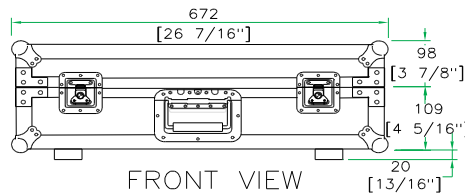

www.roadreadycases.com

Road Ready Cases 18120 S. Broadway St. Unit B Gardena, Ca. 90248- 3536
ph: 310 767 1772 fax: 310 767 1798