



RR4MMC

Lights, Sound, Action! Designed to protect and transport 4 moving mirrors, the RR4MMC makes sure that the show will go on. Our unique standing position design securely holds your moving mirrors in place and provides the ultimate protection during transport. And to make transporting a breeze we included a rugged caster kit for easy mobility. Let there be light!.

Rugged Road Ready Features

- * Beefy, Stackable Ball Corners
- * Double Anchor Industrial Rivets
- * Recessed, Industrial Grade Latches
- * Recessed, Spring Loaded Handles
- * Industrial Grade Rubber Feet
- * Premium 3/8" Vinyl Laminated Plywood
- * Tongue and Groove Locking Fit
- * Rugged Caster Kit
- * ATA 300 Rating
- * Road Ready Limited Lifetime Warranty

Fits the following models:

**ADJ 250 SCAN
CHAUVET INSIGNIA
CHAUVET INTIMIDATOR
MARTIN MX1
MARTIN MX2
AND OTHERS**

CASE FOR 4 MOVING MIRRORS IN STANDING POSITION WITH CASTER BOARD

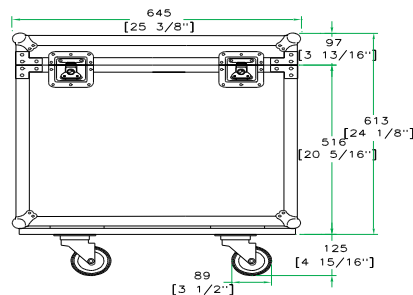

FRONT VIEW
BACK VIEW

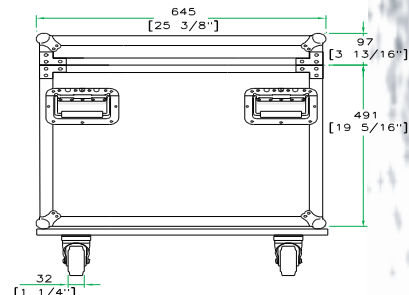

LEFT VIEW
RIGHT VIEW



A-A VIEW

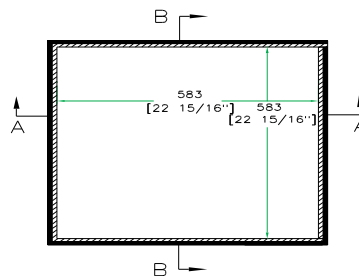

TOP VIEW OF COVER

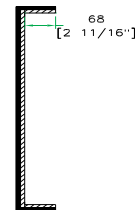

B-B VIEW

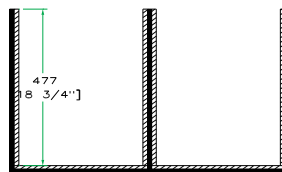

C-C VIEW

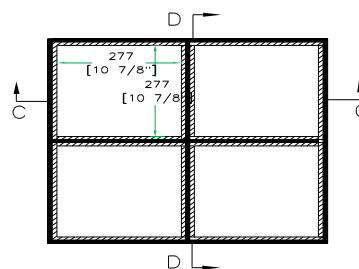

TOP VIEW OF BASE

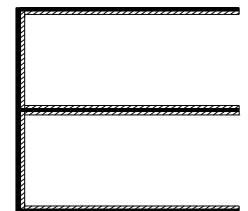

D-D VIEW