

# CA MOUNTS

## CEILING TO BACK OF THE ENCLOSURE

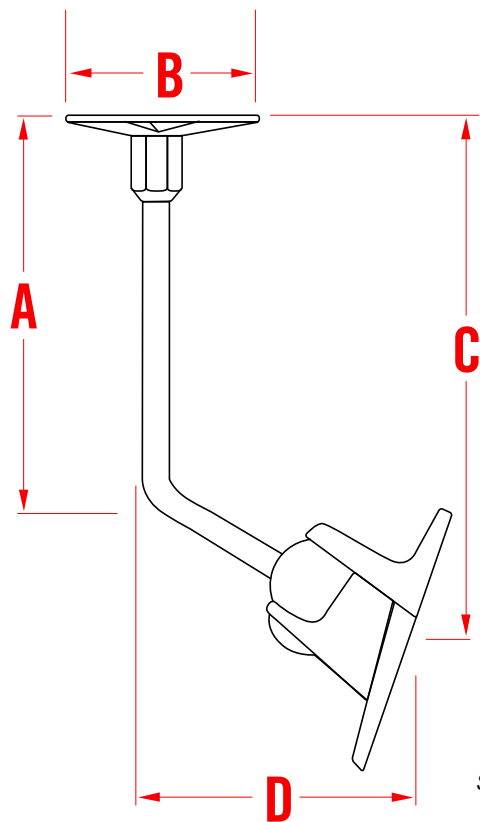

Shown with optional mounting plate.

### TECHNICAL SPECIFICATIONS

(Model number indicates weight capacity of the model in pounds)

#### 20.5 CA

A	6.25"	158.75mm
B	3.12"	79.38mm
C	8.75"	222.25mm
D	4.38"	111.13mm

#### 30.0 CA

A	6.75"	171.45mm
B	4.25"	107.95mm
C	9.25"	234.95mm
D	5.25"	133.35mm

#### 60.0 CA

A	9.00"	228.60mm
B	4.25"	107.95mm
C	13.25"	336.55mm
D	7.00"	177.80mm

#### 120.0 CA

A	13.00"	330.20mm
B	6.75"	171.45mm
C	18.25"	463.55mm
D	9.00"	228.60mm



Shown with optional mounting plate.

CA mounts are designed to attach to the back of an enclosure, then to the ceiling or any other horizontal surface. With the accessories offered, the mount can be used almost anywhere and will provide 360° of horizontal coverage and up to 90° of vertical coverage.