

world's most responsive two part high-torque motor

Numark

www.ttx1.com
00.00.01

Numark TTX1 Start Time vs.
Industry Standard

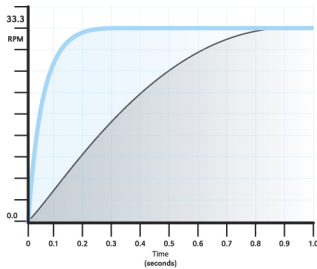

Numark TTX1 Torque vs.
Industry Standard

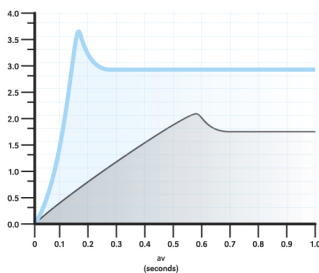

The industry's **only** two-component motor
capable of delivering a competition-
crushing torque of **3.7 kg | cm**

Reacts instantaneously to your hand while
providing the utmost in stability

Brushless DC motor with open construction

+3.7
kg/cfm

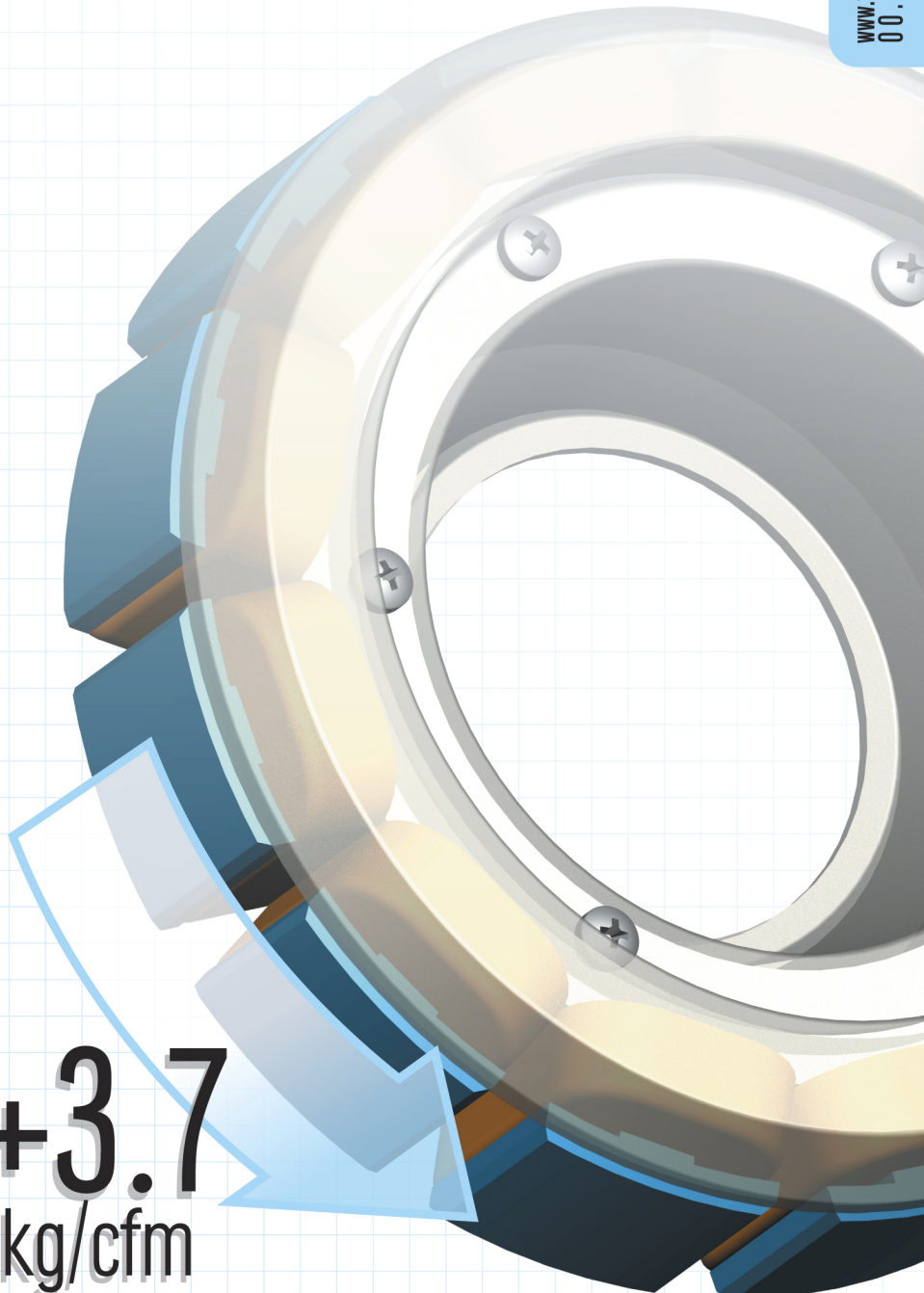

TTX
PREMIUM TURNTABLE

www.ttx1.com

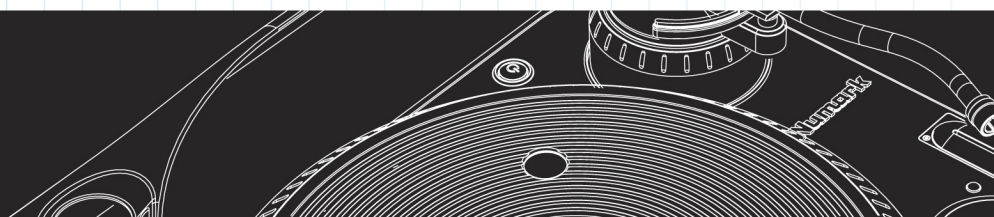

interchangeable pitch fader cartridge & button cartridge

Numark

www.ttx1.com
00.00.02

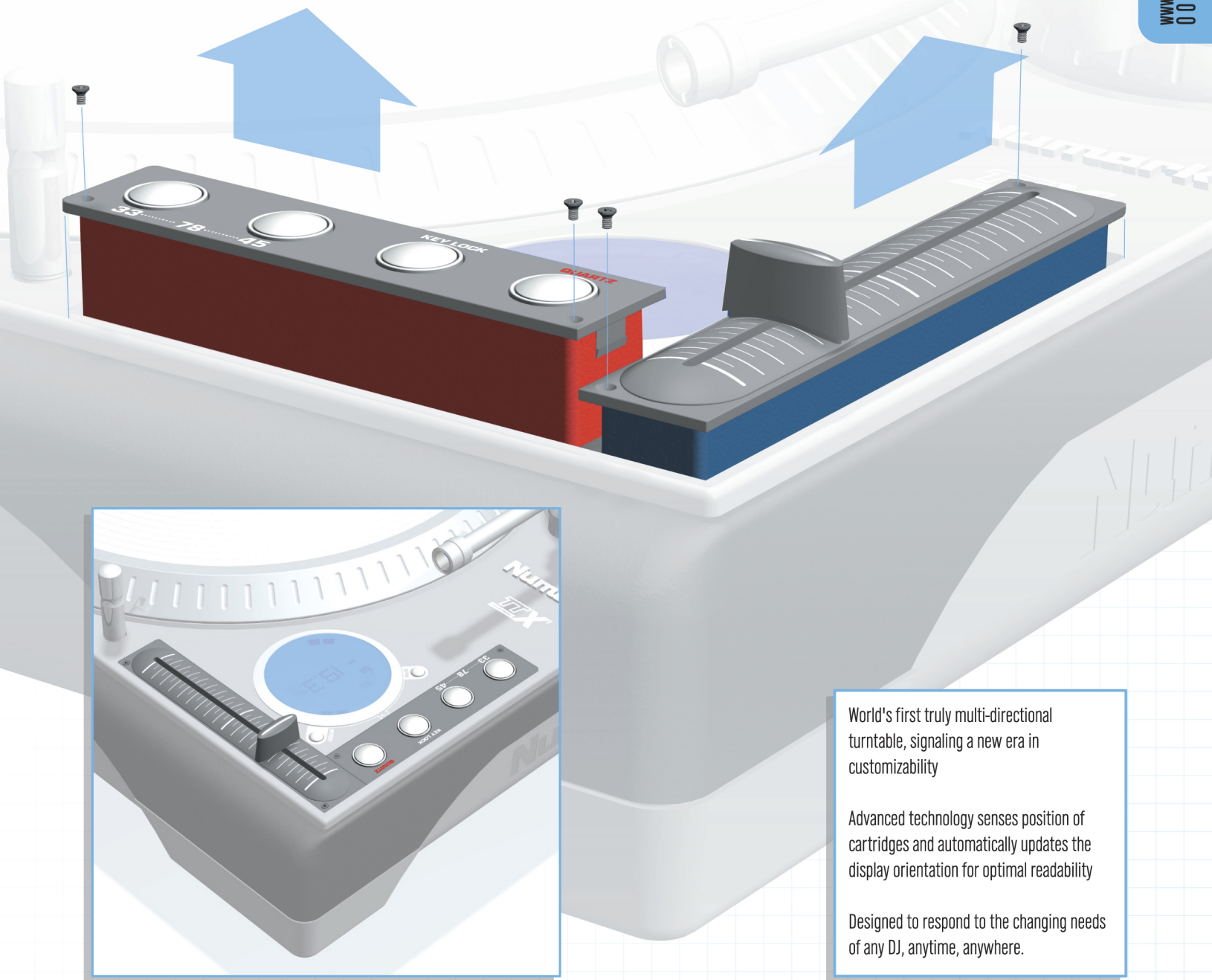

World's first truly multi-directional turntable, signaling a new era in customizability

Advanced technology senses position of cartridges and automatically updates the display orientation for optimal readability

Designed to respond to the changing needs of any DJ, anytime, anywhere.

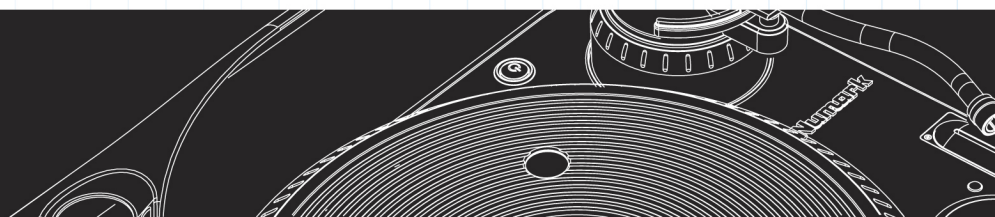

aluminum die-cast tonearm *assembly*

Numark

www.ttx1.com
00.00.03

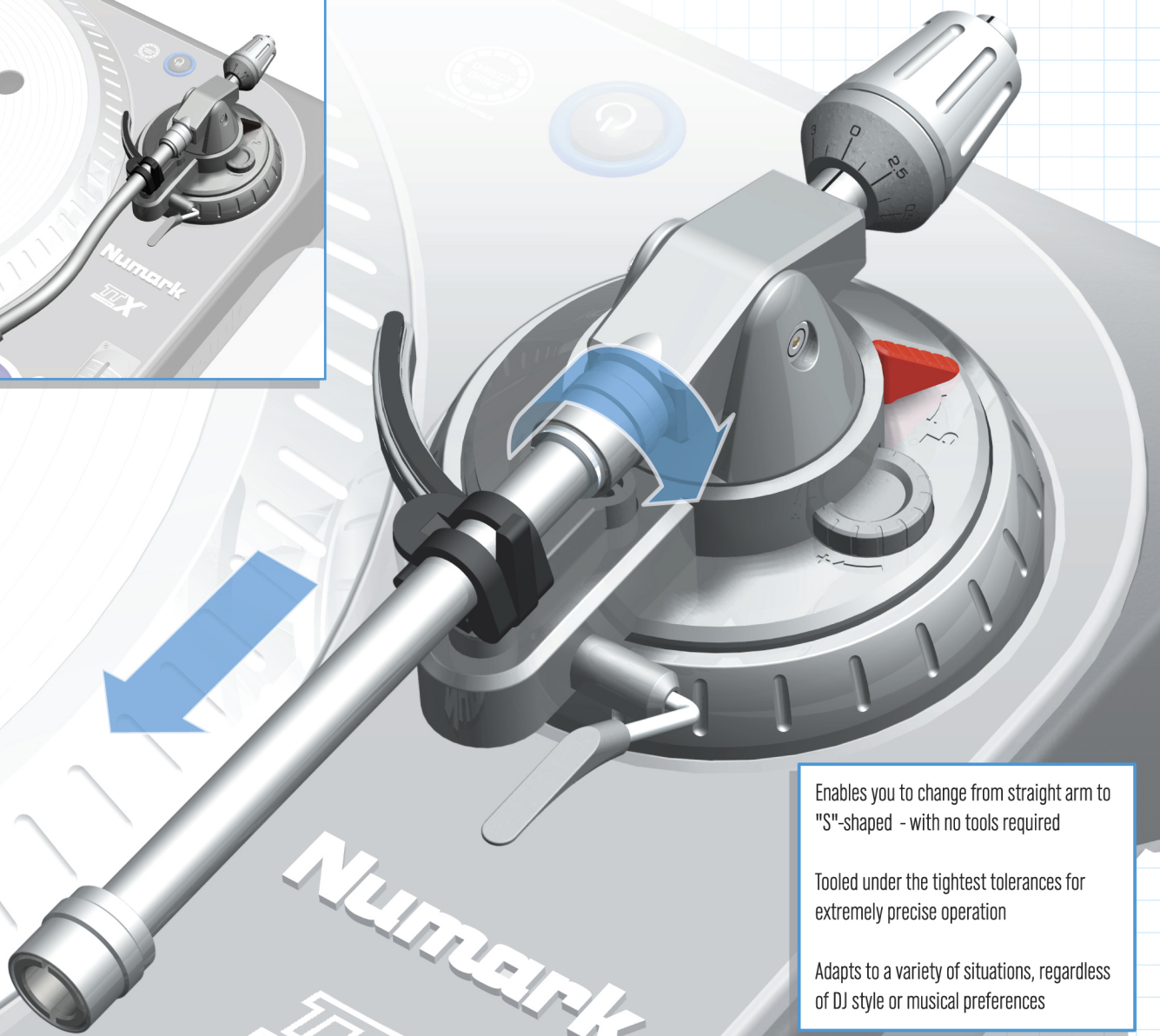

Enables you to change from straight arm to "S"-shaped - with no tools required

Tooled under the tightest tolerances for extremely precise operation

Adapts to a variety of situations, regardless of DJ style or musical preferences

TTX
PREMIUM TURNTABLE

www.ttx1.com

built to
shut out exterior noise
and vibration

Numark

www.ttx1.com
00.00.04

