

7508 Multi-Format Composite Video or s-Video to SDI Format Converter

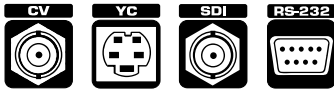

FEATURES

- **Bandwidth** - 0.2dB to 5MHz.
- **Dual SDI Outputs.**
- **Multi-Standard** - PAL(M/N), SECAM, NTSC (3.58/4/43).
- **NTSC Decoding Options** - With or without IRE 7.5 setup (pedestal).
- **Non-Volatile Memory.**
- **Resolution** - 10-bit digital processing.
- **Control** - RS-232 (Windows® - based software is included).
- **Proc-Amp Control** - Brightness, contrast color (saturation) and hue (NTSC Only) via RS-232.
- **Compact Size** - Part of the Kramer TOOLS™ family of compact, high quality and cost effective solutions.

The **7508** is a multi-format converter for composite video or s-Video (Y/C) signals. It converts either PAL, SECAM, and NTSC composite or s-Video (Y/C) signals into 2 SDI video (SMPTE 259M) outputs simultaneously.

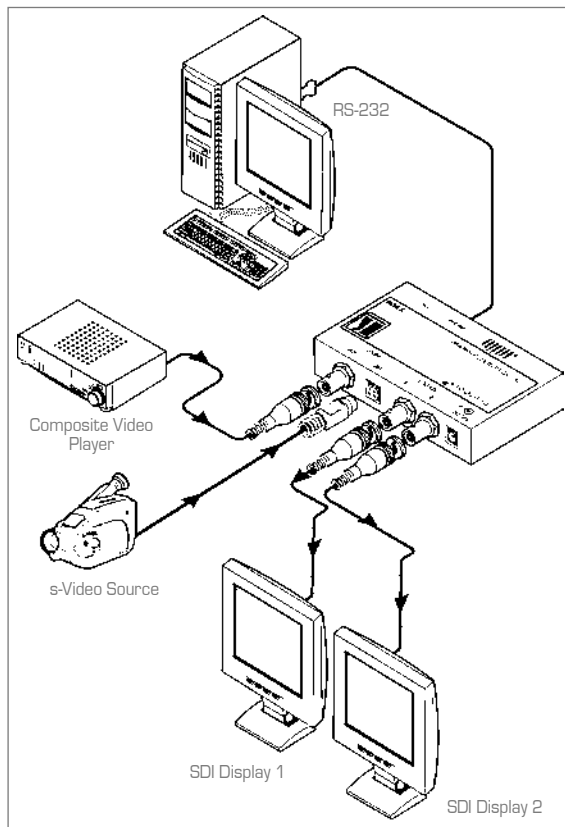

TECHNICAL SPECIFICATIONS

INPUTS:	1 composite video 1Vpp/75Ω on a BNC connector; 1 s-Video 1Vpp, 0.3Vpp/75Ω on a 4p connector.
OUTPUTS:	2 SDI SMPTE-259M, ITU-R BT.601 on BNC connectors.
DIGITAL RESOLUTION:	10 Bits.
BANDWIDTH:	0.2dB to 5MHz.
SIGNAL TO NOISE RATIO:	57dB.
K-FACTOR:	< 0.2%.
DIFFERENTIAL PHASE:	1%.
DIFFERENTIAL GAIN:	1%.
LUMA NON-LINEARITY:	1%.
CHROMA/LUMA DELAY:	< 15ns.
CONTROL:	Brightness, contrast, hue, saturation, sharpness via RS-232.
DIMENSIONS:	12cm x 7.5cm x 2.5cm (4.7" x 2.95" x 0.98", W, D, H).
WEIGHT:	0.3kg. (0.66lbs.) approx.
POWER SOURCE:	12VDC, 210mA.
ACCESSORIES:	12 VDC power supply, mounting bracket.

