



The Power Protection Series from ETA Systems...

Isolation Transformer / Balanced Power Feature

PD11VABP Performance: Pure, clean power is obtained by using the isolation transformer to generate AC current. The incoming power feels the isolation transformer's primary windings and is regenerated (through electromagnetic induction) as clean power on the isolated secondary windings, which have no physical connection to the primary windings. This is True Isolation! The PD11VABP also provides the ability to switch the isolation transformer's output mode from isolated to balanced power, to further match the system's needs.

Balanced Filtration Circuitry

PD11VABP and PD11VBC have circuits designed to eliminate the AC contamination that is most detrimental to the performance of analog or video components like stereo receivers, VCRs or televisions. The filters are carefully engineered to provide power filtration and inter-component "noise isolation" for both common-mode (line/neutral-to-ground) and normal-mode (line-to-neutral) EMI/RFI. This means that high-frequency interference will be drastically reduced not only from the incoming power, but also from equipment plugged into the other outlet banks, regardless of what mode it occurs in. Even equipment with ungrounded, 2-blade plugs, receives clean power!

High Current Outlets

PD11VABP and PD11VBC have high-current outlets allowing amps and powered subwoofers to work to their full potential. When music reaches a climactic crescendo, amps have to draw large amounts of current to replenish their capacitors. Traditional line conditioners impede this current draw, in effect, starving an amplifier, resulting in a flat, dead sound.

Power Protection Circuitry

PD11VABP, PD11VBC and PD8BC constantly monitor the AC line voltage for unsafe voltage conditions, such as prolonged overvoltages and undervoltages. If it senses an unsafe power condition, it will automatically disconnect your equipment from the power to protect the equipment from damage. Once the voltage returns to a safe level, the power will automatically be reconnected.

SATELLITE & COAX JACKS

Gold-Plated F-Connectors
Optimized for Satellite or Cable TV Signal Line Protection



AV RCA JACKS

RCA Connectors.
Circuits are Optimized for Audio & Video Signal Line Protection

TELEPHONE JACKS

In/Out Connectors for Telephone Line or Pay-Per-View Line Connections.



ACCESSORIES INCLUDED

Telephone Cable, Coax Cables, Power Cord.
Convenience Lamp (PD11VABP).

SEQUENTIAL POWER UP/DOWN

3-Position Slide Switch Controls Timing of 0, 10, 30 Seconds, for Isolation Controlled Outlets or High-Current Outlets

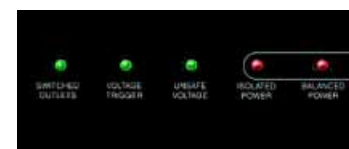
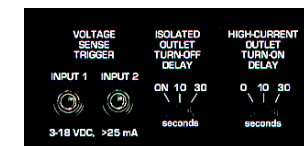

DIAGNOSTIC INDICATOR LEDs

LED Indicator Lights on the Front Panel for Switched Outlets, DC Voltage Trigger and Unsafe Voltage Occurrence

ACCESSORY RACK EARS



Rack Mounting Bracket Kits Available, #PD2MK (2-rack) #PD1MK (1-rack)

- BALANCED POWER
- ISOLATED POWER
- AC REGENERATION
- BALANCED CIRCUITS

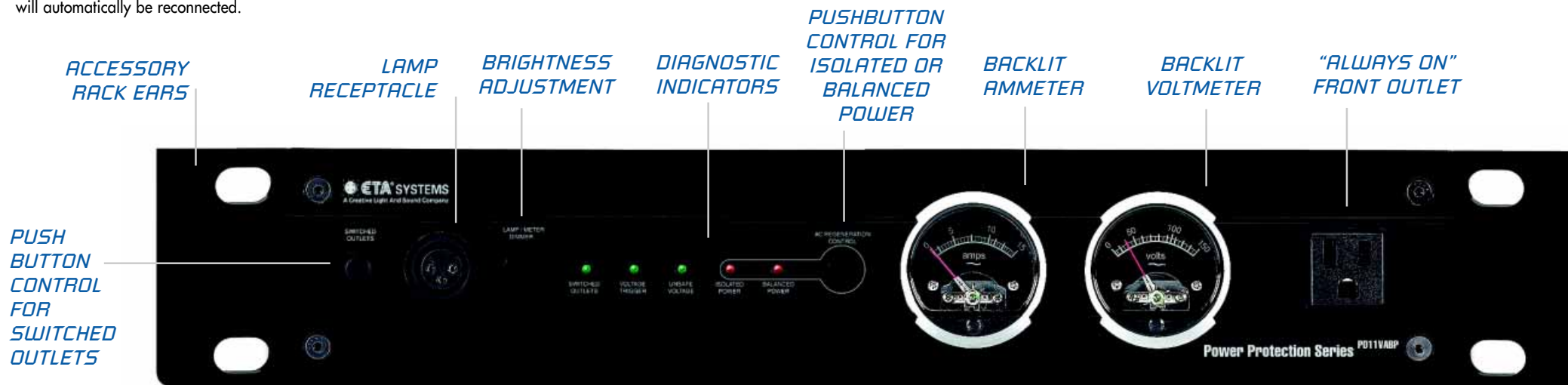

Features	PD11VABP	PD11VBC	PD8BC
AC Power			
Line Voltage	120VAC, 50/60Hz	120VAC, 50/60Hz	120VAC, 50/60Hz
Current Rating	15-Amp	15-Amp	15-Amp
Voltmeter	Analog	Analog	
Ammeter	Analog		
Adjustable Meter Lights	Variable	Variable	
Sequential Start-Up/Shut-Down	Adjustable	Adjustable	
DC Trigger	2 in	1 in and 1 out	1 in
Connector (Mini Plug)	3.5mm, mono	3.5mm, mono	3.5mm, mono
Voltage & Polarity	5-30 VDC	5-30 VDC	5-30 VDC
Current Requirement	>10mA	>10mA	>10mA
AC Outlets, Total	11	11	8
Front	1	1	1
Rear	10	10	7
Power Cord Detachable (IEC 320)	Yes	Yes	
Length	10 feet	10 feet	10 feet
Power Modes			
Isolated Power	Switchable		
Balanced Power	Switchable		
EMI/RFI Noise Filtration			
Isolation Transformer	Yes		
Filtration Modes	Common & Normal		
Specification	120 dB		
Balanced Circuits	2 duplex	2 duplex	1
Filtration Modes	Common & Normal	Common & Normal	Common & Normal
Specification	55 dB	55 dB	50 dB
High Current Circuits	1	1	
Filtration Modes	Normal	Normal	
Specification	50 dB	50 dB	
AC Power Protection			
Overvoltage Shutoff	137±4 VAC	137±4 VAC	137±4 VAC
Undervoltage Shutoff	95±4 VAC	95±4 VAC	95±4 VAC
Circuitry to Disconnect/Connect	Yes	Yes	Yes
Initial Clamping Level	200V	200V	200V
UL 1449 Rating	330V	330V	330V
Protection Modes	L-N, L-G, N-G	L-N, L-G, N-G	L-N, L-G, N-G
Response Time	<1 ns	<1 ns	<1 ns
Single Pulse Energy Dissipation	2325 joules	1790 joules	1650 joules
Peak Impulse Current	91,000A	65,000A	52,000A
Line-Level Signal Protection			
Number of Solid-State Circuits	4		
Clamping Level	6.5V		
Attenuation, 10Hz—6MHz	<0.06dB		
Connectors	RCA, Female		
Satellite Signal Protection			
Number of Solid-State Circuits	2	2	2
Clamping Level	27V	27V	27V
Attenuation, 950Hz—2.0MHz	<1dB	<1dB	<1dB
Attenuation, 2.0GHz—2.20GHz	<2dB	<2dB	<2dB
Shielded	Yes	Yes	Yes
Connectors	Gold "F", Female	Gold "F", Female	Gold "F", Female
CATV Signal Protection			
Number of Solid-State Circuits	1	2	1
Clamping Level	0.7V	0.7V	0.7V
Attenuation, 5MHz—950MHz	<1dB	<1dB	<1dB
Shielded	Yes	Yes	Yes
Connectors	Gold "F", Female	Gold "F", Female	Gold "F", Female
Telephone Line Protection			
Number of Solid-State Circuits	1	1	1
Suppression Mode	Metallic & Longitudinal	Metallic & Longitudinal	Metallic & Longitudinal
Clamping Level	260V	260V	260V
Capacitance	30pf (approx.)	30pf (approx.)	30pf (approx.)
Fuseless Auto-resetting	Yes	Yes	Yes
Wires Protected	2 Wire/1 pr. (pins 4,5)	2 Wire/1 pr. (pins 4,5)	2 Wire/1 pr. (pins 4,5)
Connectors	RJ-11/45 compatible	RJ-11/45 compatible	RJ-11/45 compatible
General			
Rack Mountable Bracket Kit	Optional #PD2MK	Optional #PD2MK	Optional #PD1MK
Gooseneck Lamp	Included		
Height	3.5 inches	3.5 inches	1.75 inches
Width	17.0 inches	17.0 inches	16.9 inches
Depth	12.0 inches	12.0 inches	6.5 inches
Weight	26 lbs.	17 lbs.	5 lbs.
Product Warranty			
	3 years	3 years	3 years

ETA...The Benchmark By Which Professionals Compare.

For over 25 years ETA has developed, manufactured, and sold high amperage theatrical lighting systems from which have evolved an extensive line of rack mounted conditioned power distribution products designed to protect today's sensitive electronic digital equipment.

The "PD" Conditioned Power Distribution Series easily deals with normal AC line power fluctuations, as well as the more drastic abnormalities of the spike and surge variety. Also, the filtering of interferences—caused by electromagnetic (EMI) and radio frequency (RFI) transmissions—is routinely accomplished. More sophisticated ETA models utilize microprocessor technology to regulate AC power and sequence power turn-on—reducing high in-rushes of power.

ETA's sophisticated electronic protection technology is the favorite of professionals who demand flawless operation of digital mixers, processors, amplifiers and PCs—whether in the studio, in the boardroom, on tour, or in a home studio environment.

The Power Protection Series. The next generation.

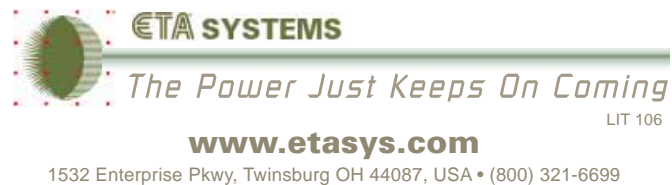

PD11VABP A Must for Pure Power Management

- Balanced Power
- Isolation Transformer
- Balanced Filtered Circuits
- High Current Outlets
- Power Protection Circuitry

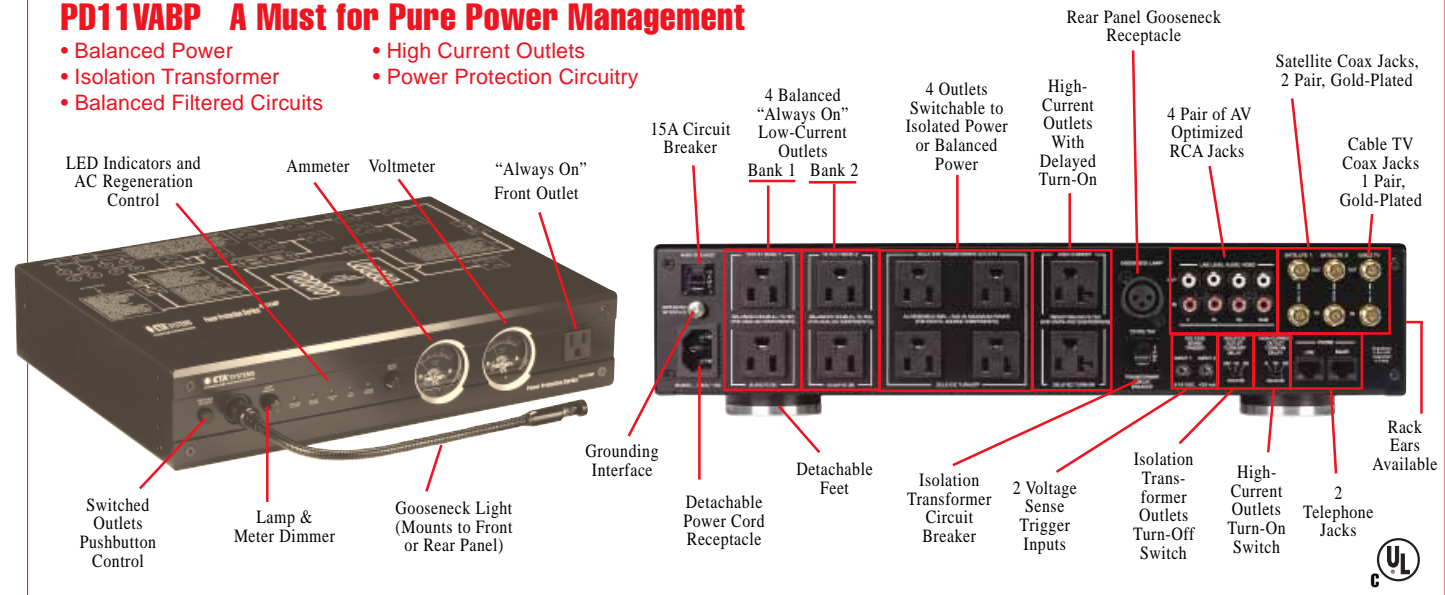

PD11VBC A Perfect Power Solution

- Balanced Circuits
- High Current Outlet
- Power Protection Circuitry

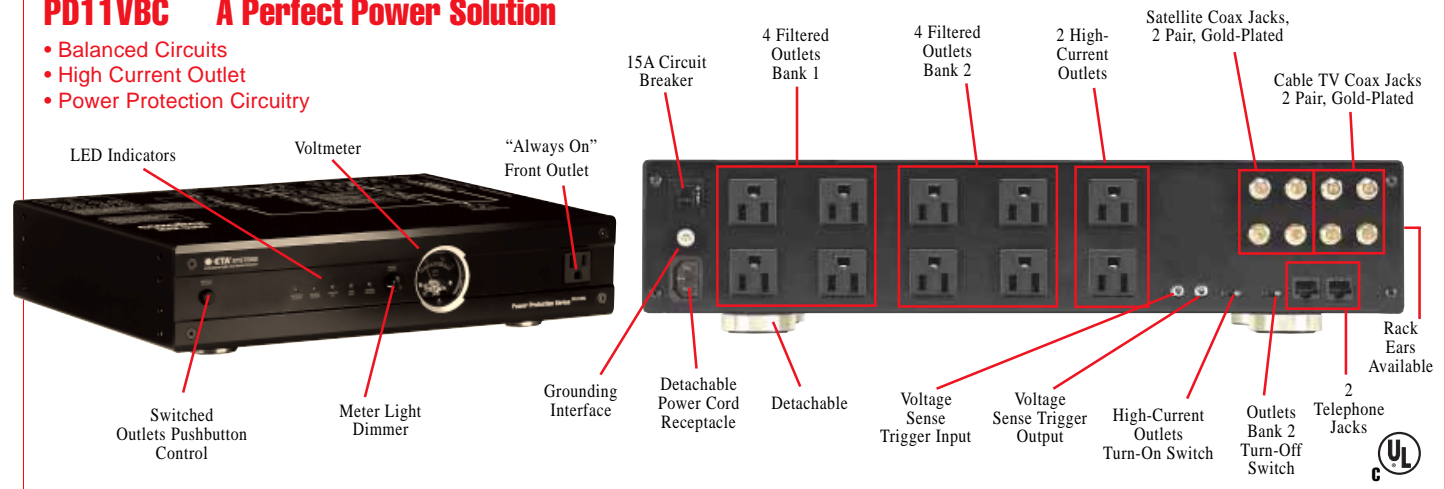

PD8BC A Compact Design, Full Size Clout.

- Balanced Circuit
- Power Protection Circuitry

