

X-Array Install™ SPECIFICATIONS

| MODEL | Xi-2153/64 and Xi-2183/64 | Xi-1183/64 | Xi-1191 | Xi-1152/64 and Xi-1152/94 | Xi-1122/85 |
|---|---|--|---|--|--|
| FREQUENCY RESPONSE: | 40-20,000 Hz | 48-20,000 Hz | 32-160 Hz (26-160 Hz in step-down mode) | 50-20,000 Hz | 60-20,000 Hz |
| CROSSOVER FREQUENCIES: | 125 Hz/1,760 Hz (2183) 400 Hz/1,760 Hz (2153) | 125 Hz 1,760 Hz | 160 Hz max | 1,480 Hz | 1,480 Hz |
| LONG-TERM-AVERAGE POWER HANDLING (PER ANSI/EIA RS-426A 1980), LF/MB/HF: | 1,200/300/75 W | 600/300/75 W | 600 W | 600/75 W | 300/75 W |
| SENSITIVITY (SPL 1 W/1m), ANECHOIC ENVIRONMENT: | 98.5/107/112 dB | 95/107/112 dB | 96 dB | 98/112 dB | 99/110 dB |
| NOMINAL DIRECTIVITY: | 60° H x 40° V (rotatable HF) tripole configured directivity to 200 Hz | 60° H x 40° V (rotatable HF) | Omnidirectional | 60° H x 40° V (64) 90° H x 40° V (94) | 80° H x 55° V |
| TRANSDUCER COMPLEMENT, LF: | Two EVX-180B (2183) Two EVX-155 (1153) (tripole configured) | One EVX-180B | One EVX-180B | One EVX-155 | One 12-inch woofer |
| MB: | One 12-inch mid-bass on 60° H x 40° V horn | One 12-inch mid-bass on 60° H x 40° V horn | N/A | N/A | N/A |
| HF: | One DH6 (1.4-in. exit) on 60° H x 40° V horn | One DH6 (1.4-in. exit) on 60° H x 40° V horn | N/A | One DH6 (2-in. exit) on 60° H x 40° V horn (Xi-1152/64) One DH6 (2-in. exit) on 90° H x 40° V horn (Xi-1152/94) | One DH6 (1.4-in. exit) on 80° H x 55° V horn |
| NOMINAL IMPEDANCE, LF: | 4 ohms | 8 ohms | 8 ohms | 8 ohms | 8 ohms |
| MB: | 12 ohms | 12 ohms | N/A | N/A | N/A |
| HF: | 16 ohms | 16 ohms | N/A | 16 ohms | 16 ohms |
| INPUT CONNECTORS: | Two Neutrik NL8MPR | Two Neutrik NL8MPR | Two Neutrik NL4MPL | Two Neutrik NL4MPL | Two Neutrik NL4MPL |
| RECOMMENDED AMPLIFIER POWER (MINIMUM), LF: | 800 W at 4 ohms | 800 W at 4 ohms | 800 W at 4 ohms | 500 W at 4 ohms | 500 W at 4 ohms |
| MB: | 800 W at 4 ohms | 800 W at 4 ohms | N/A | N/A | N/A |
| HF: | 800 W at 4 ohms | 800 W at 4 ohms | N/A | 500 W at 4 ohms | 500 W at 4 ohms |
| ENCLOSURE CONSTRUCTION: | 18-mm, 13-ply birch | 18-mm, 13-ply birch | 18-mm, 13-ply birch | 18-mm, 13-ply birch | 18-mm, 13-ply birch |
| ENCLOSURE FINISH: | Black textured paint | Black textured paint | Black textured paint | Black textured paint | Black textured paint |
| DIMENSIONS, HEIGHT: | 1,233 mm (48.54 in.) | 914 mm (36.0 in.) | 914 mm (36.0 in.) | 759 mm (29.88 in.) | 584 mm (23.0 in.) |
| WIDTH, FRONT: | 584 mm (23.0 in.) | 586 mm (23.7 in.) | 586 mm (23.7 in.) | 450 mm (17.73 in.) | 375 mm (14.75 in.) |
| WIDTH, BACK: | 354 mm (13.93 in.) | 354 mm (13.93 in.) | 354 mm (13.93 in.) | 248 mm (9.75 in.) | 199 mm (7.84 in.) |
| DEPTH: | 759 mm (29.88 in.) | 759 mm (29.88 in.) | 759 mm (29.88 in.) | 413 mm (16.28 in.) | 356 mm (14.0 in.) |
| NET WEIGHT: | 113.6 kg (250 lb) | 93.2 kg (205 lb) | 68.2 kg (150 lb) | 40.7 kg (89.5 lb) | 31.36 kg (69.0 lb) |
| SHIPPING WEIGHT: | 118.6 kg (261 lb) | 97.3 kg (214 lb) | 72.3 kg (159 lb) | 43 kg (94.5 lb) | 33.6 kg (74 lb) |

Premium touring quality sound. Install it anywhere.



ElectroVoice®

600 Cecil Street, Buchanan, Michigan 49107, Phone: 616/695-6831, Fax: 616/695-1304

Electro-Voice, 345 Herbert St., Gananoque, Ontario, Canada K7G 2V1, Phone: 613/382-2141, Fax: 613/382-7466

Electro-Voice, A.G., Keltenstrasse 11, CH-2563 IPSACH, Switzerland, Phone: 011-41/32-51-6833, Fax: 011-41/32-51-1221

Electro-Voice, Hirschberger Ring 45, D-94302, Straubing, Germany, Phone: 011-49/9421-7060, Fax: 011-49/9421-706265

Electro-Voice, Parc de Courcerin—Allée Lech Walesa, Lognes, F-77185 Marne La Vallée, France, Phone: 011-33/1-6480-0090, Fax: 011-33/1-6006-5103

Electro-Voice, 2-5-60 Lzumi, Suginami-ku, Tokyo, Japan 168, Phone: 011-81/3-3325-7900, Fax: 011-81/3-3325-7789

Electro-Voice, Unit 24, Block C, Slough Business Park, Slough Ave., Silverwater, N.S.W. 2141, Australia, Phone: 011-61/2-648-3455, Fax: 011-61/2-648-5585

Electro-Voice, Unit E & F, 21/F., Luk Hop Industrial Bldg., 8 Luk Hop St., San Po Kong, Kowloon, Hong Kong, Phone: 011-852/351-3628, Fax: 011-852/351-3329

©Telex Communications, Inc., 1998 • Litho in U.S.A. • Part Number 535036 9804

X-Array Install™

*Premium touring quality sound.
Install it anywhere.*

Now, fixed installations and small-to-medium arrays benefit from the finest touring system technology available.

X-Array™

The best technology for accurate sound reproduction at all power levels.

Introducing a family of advanced sound reinforcement products for everyone who desires the sound quality of Electro-Voice's X-Array™ touring systems. X-Array Install™ is the ideal choice for small-to-medium array configurations and fixed installations of any size.

Inspired by the most demanded features of EV's acclaimed X-Array™ touring systems, the X-Array Install™ series incorporates a potent combination of very high output, medium- to long-throw "cells," and Ring-Mode Decoupling (RMD™).

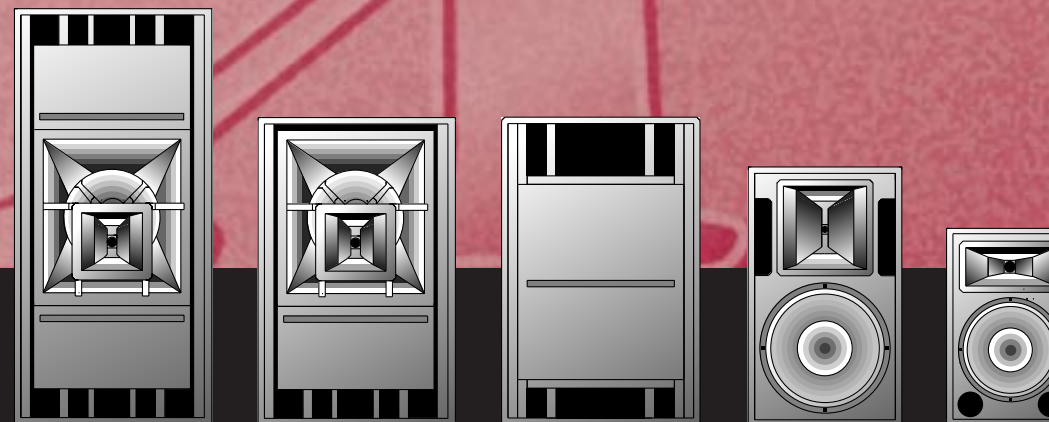

Ev
ElectroVoice®

Ev
ElectroVoice®

RMD™

RMD™ (Ring-Mode Decoupling) is the same advanced technology built into the X-Array™ touring series. RMD™ produces substantially improved tonal character and fidelity whether operated at low or extremely high sound pressure levels. RMD™ attacks time domain "ringing modes" at their sources. Mechanical solutions solve mechanical issues, acoustical solutions address acoustical modes found in all sound reinforcement systems. The combination of each RMD™ technique provides improved tonal character and fidelity at increasing drive levels. The result is cleaner, even sound quality with vastly improved intelligibility.



DH6 LARGE-FORMAT DRIVER

All multiway systems in the series are equipped with EV's newly developed DH6 large-format compression driver. The DH6 compression driver incorporates many RMD™ techniques, including a new titanium diaphragm with increased internal mechanical damping that provides clear, intelligible upper vocal performance. The phase plug placed close to the diaphragm improves acoustic damping and boosts output in the 10 to 20 kHz range.



ROTATABLE HORNS

X-Array Install™ speakers use rotatable high-frequency horns that provide the ultimate in coverage flexibility for different applications.



SIGNAL PROCESSING SUPPORT

Full system configuration parameters are available for crossover, signal delay, parametric EQ and compression/limiting functions, in these products: Merlin ISP-100, Klark Teknik DN8000 and Electro-Voice Dx34A.

X-Array Install™

MAGNETICS

Mid-bass and high frequency drivers in X-Array Install™ products use ferrite magnetics instead of the neodymium magnetics used in X-Array™ touring systems. While neodymium drivers provide unmatched output capabilities, the advanced RMD™ technology used in X-Array Install™ produces world class sound reinforcement at very high levels.



RIGGING

X-Array Install™ features two-point L-track top/bottom rigging designed to heavy-duty, 8:1 load-factor ratings. This contrasts with the "spinal" backbone rigging of X-Array™ touring systems, designed for rapid load-in/load-out. The track accepts New Haven NH32102-2 double-stud fittings (for touring) or New Haven NH8192-2S or Ancra 42546-10 single-stud fittings (for installs).



TRIPOLE DESIGN FLEXIBILITY

The X-Array Install™ series allows greater flexibility through tripole designs that permit extended vertical polar control in the Xi-2183 and Xi-2153 models. Reduced output above and below the systems increases clarity and intelligibility, and can reduce feedback under an array.



POWER

X-Array Install™ products are fully supported by Electro-Voice Precision Series™ power amplifiers. All P-series amplifiers exhibit very high peak output (140+ volts for the P3000) for unrivaled fidelity at and near full power. Full dual power supplies allow sub and mid, or high channel combining, without signal alteration.



Xi-2153/64 and Xi-2183/64 TRIPOLARS

These triamp-ready, three-way systems in a unique tripole configuration are designed for use in reverberant spaces. Dual spaced woofers flank and work with the central mid-bass horn to form the tripole, extending vertical directivity control to below 200 Hz. Such wide-bandwidth control and the medium-Q (60° x 40°) pattern provide superior direct-to-reflected SPL ratios and improved system intelligibility, and suppress feedback below arrays.

Two woofer choices are available. Dual 18-inch woofers (EVX-180B) in the Xi-2183/64 produce superior low-frequency output. When optimum directivity control is required, the Xi-2153/64 with dual 15-inch woofers (EVX-155), should be used. The 12-inch mid-bass driver features RMD™ coupled with a 60° x 40° vertical horn.

The high-frequency system uses a DH6 large-format compression driver with a rotatable 60° x 40° horn. It is coaxially mounted, asymmetrically positioned and fully "shrouded" to preserve mid-bass wave-front detail. For extended-bass/subbass, the Xi-2153 and Xi-2183 may be used with the Xi-1191 subwoofer.

Every X-Array Install™ enclosure features trapezoidal design and L-track top/bottom rigging for exceptional flexibility in arrays and installations.

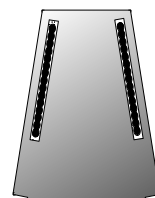

Carrying handles are featured on each side of all X-Array Install™ enclosures.

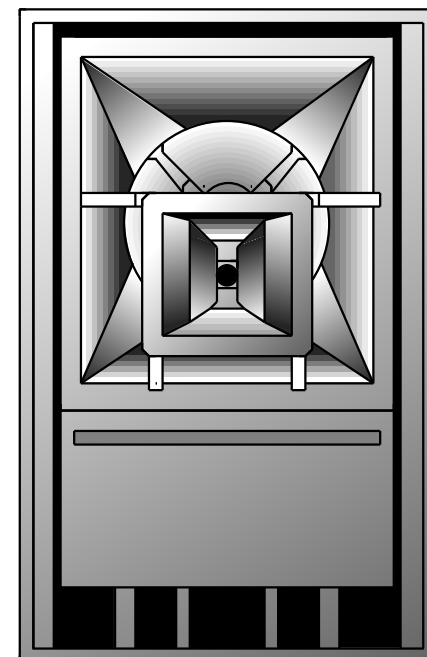
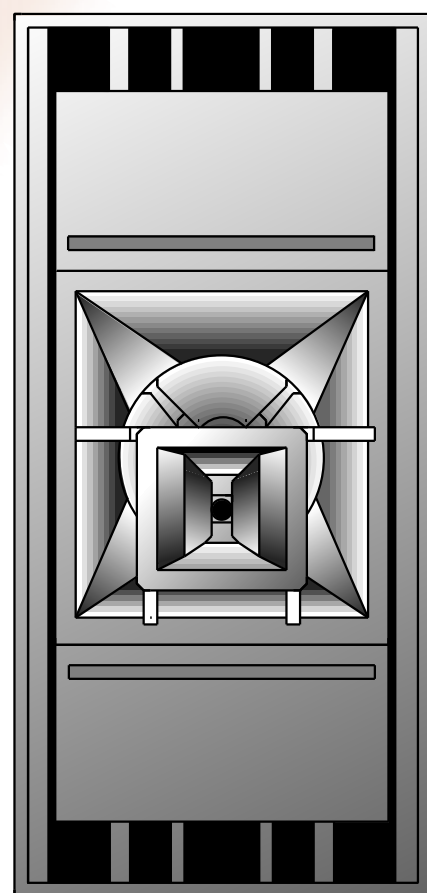
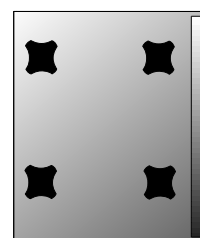

Xi-1183/64

This full-bandwidth, three-way, triamp system is designed for medium- to long-throw applications. Its high-frequency horn/driver section is rotatable to provide proper coverage for vertical or horizontal system installations.

The low-frequency is powered by an 18-inch driver (EVX-180B) in a slot-loaded, closed-box configuration suitable for moderate to moderately high sound pressure levels. When moderately high to very high levels are desired we suggest augmenting

with the Xi-1191. Or, for maximum low-frequency performance, combine in a four-way configuration.

The 12-inch, application-specific mid-bass driver features RMD™ and a 60° x 40° horn. The DH6 high-frequency driver/horn combination is fully "shrouded" to preserve mid-bass wave-front detail.

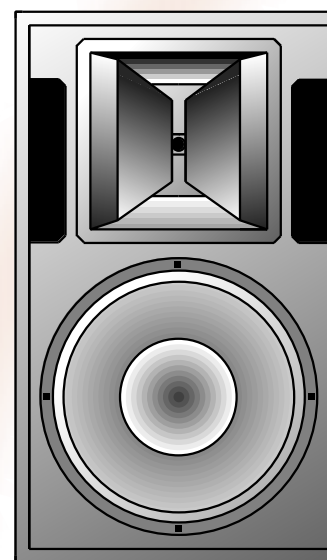

Xi-1152/64 and Xi-1152/94

The Xi-1152/64 and Xi-1152/94 are two-way, biamp-ready, very high output sound reinforcement systems. When high sound pressure levels are required (to 50 Hz) but there are space or size limitations these systems are excellent choices.

The two systems differ only in their high-frequency coverage pattern. The Xi-1152/64 has a rotatable 60° x 40° pattern, the Xi-1152/94 has a rotatable 90° x 40° pattern.

The EVX-155 15-inch woofer features very low distortion at very high pressure levels. The system also features high linear excursion capabilities coupled with very high continuous power rating (600 watts) and low power compression. A DH6 large-format driver provides excellent mid- and high-frequency vocal performance.

An integral stand-mount adapter in addition to the top/bottom rigging allows a wide range of applications.

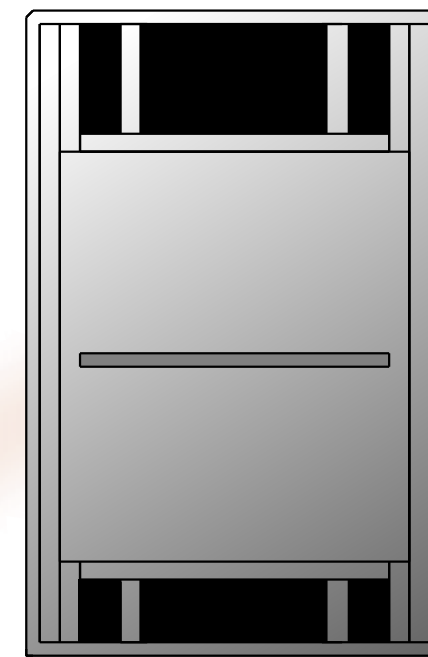

Xi-1191

The Xi-1191 is an extremely high performance, large-rear-volume subwoofer system that combines perfectly with any X-Array Install™ product. Its identical enclosure dimensions mean it can integrate particularly easily with the Xi-1183 and Xi-2153/2183 triamp systems.

Providing the system's high performance is the combination of very high linear excursion capabilities, high continuous power handling (600 watts) and superior power-compression performance.

The system's high acoustic power at low frequencies is generated by a single 18-inch woofer (EVX-180B).

Factory tuning is set at 37 Hz, producing maximum 32 to 50 Hz output to handle the majority of sound reinforcement/public address applications. "Step-down" 26 Hz tuning is also available for very-low-frequency effects and extremely long programs.

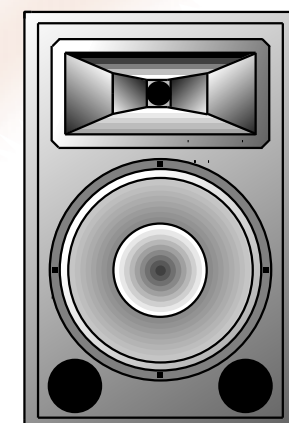

Xi-1122/85

This is a very compact, ultra-high-output, 12-inch, two-way speaker system designed for fixed installation where small size and high output (to 60 Hz) are required.

The Xi-1122/85 uses a high-power-handling 12-inch woofer with RMD™ and a DH6 large-format, high-frequency driver coupled to an 80° x 55° horn.

Compact design and an integral stand-mount adapter provide many application possibilities. In fixed-installations where size and line-of-sight are critical, it can combine with the Xi-1191 subwoofer to provide full 26 to 20,000 Hz operation. The combination produces extremely high performance characteristics in a very small package and the Xi-1191 may be placed "out of sight" for aesthetic considerations.