

## INSTALLATION

With the mounting panel laying horizontal and the speaker face down, position it for even spacing of the mounting clamps. They can be used only in those places around mounting holes where the front gasket doesn't interfere. With clamps in position, outline the slots with a marker then remove the clamps and speaker and drill holes in the slot area anywhere from  $\frac{5}{16}$  to  $\frac{11}{32}$  diameter. Install the T-nuts from the rear, making sure their tubes are inside the holes and the prongs firmly stuck into the panel.

Install the gasket or sealant around the speaker rim clearance hole, and set the speaker in place. Now position the clamps over the holes and install the screws. To avoid possible damage to the system, don't over-tighten. Only a slight compression of the gasket is needed.

**WARRANTY (Limited)** — University Sound Speakers and Speaker Systems (excluding active electronics) are guaranteed for five years from date of original purchase against malfunction due to defects in workmanship and materials. If such malfunction occurs, unit will be repaired or replaced (at our option) without charge for materials or labor if delivered prepaid to University Sound. Unit will be returned prepaid. Warranty does not extend to finish, appearance items, burned coils, or malfunction due to abuse or operation under other than specified conditions, including cone and/or coil damage resulting from improperly designed enclosures, nor does it extend to incidental or consequential damages. Some states do not allow the exclusion or limitation of incidental or consequential damages, so the above exclusion may not apply to you. Repair by other than University Sound will void this guarantee. This warranty gives you specific legal rights, and you may also have other rights which vary from state to state.

Service and repair information for this product: University Sound, Inc.,  
Phone 818/362-9516, FAX 818/367-5292.

Applications and technical information for University Sound products:  
University Sound, Inc., Technical  
Coordinator, Phone 818/362-9516,  
FAX 818/367-5292

Specifications subject to change  
without notice



## SPECIFICATIONS

### Construction:

Heavy-duty die-cast zinc alloy finished in black enamel paint

### Recommended Drivers:

EVM® 12S, EVM® 12L, EVM® 15B, EVM® 15L, EVM® 18B, PRO-12B, SP12C. They can also be used for any other speaker with dimensions compatible with those shown.

### Dimensions,

#### Height:

1.65 cm (0.65 in.)

#### Width:

2.54 cm (1.00 in.)

#### Length:

3.66 cm (1.44 in.)

### Net Weight (4 off):

0.2 kg (0.4 lb)

### Shipping Weight:

0.3 kg (0.7 lb)

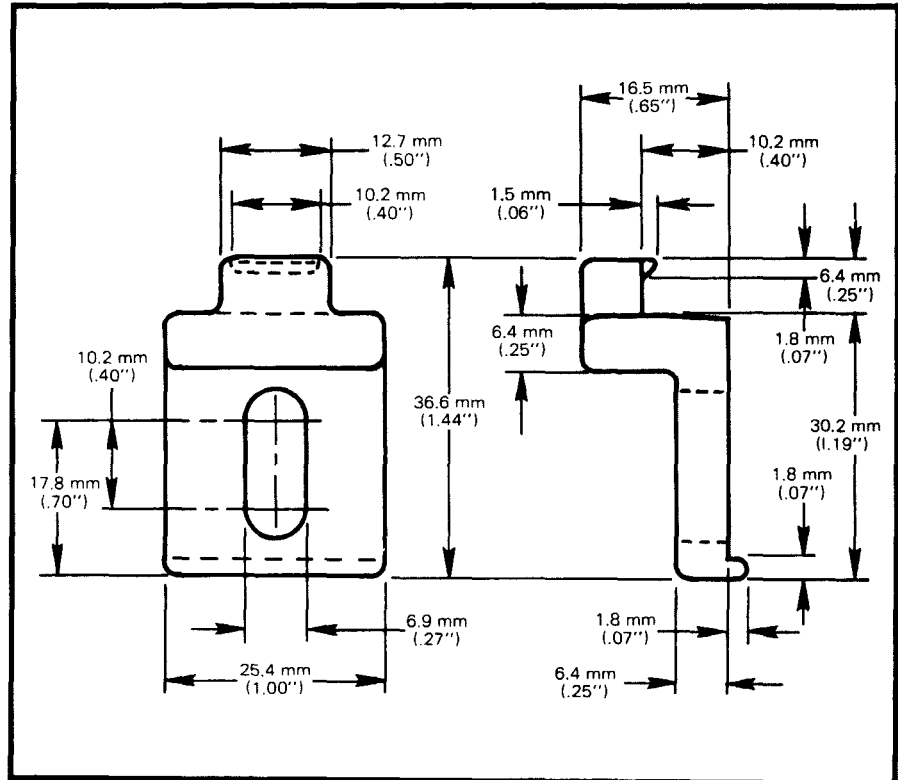

## SMH-1

## Speaker Mounting Hardware Kit

### DESCRIPTION

The SMH-1 Speaker Mounting Kit consists of four clamps and four screws with T-nuts for quick, easy mounting of speakers onto a panel from one-half inch to slightly over one-inch thick. For a greater thickness, longer matching screws must be obtained.

The clamps are of die-cast zinc alloy, finished in black enamel. The T-nuts and machine screws are standard size ¼-20.

Mounting and replacement of matching-size speakers onto a panel is quick and easy using the SMH-1 mounting kit.