



---

MANUAL PART NUMBER: 400-0109-004

**PNP400**

**POP 'N PLUG TOWER**

**USER'S GUIDE**

## TABLE OF CONTENTS

	<b>Page</b>
PRECAUTIONS / SAFETY WARNINGS .....	2
GENERAL .....	2
INSTALLATION.....	2
CLEANING .....	2
FCC / CE NOTICE.....	2
ABOUT YOUR <b>PNP400</b> .....	3
TECHNICAL SPECIFICATIONS.....	3
<b>PNP400</b> DIMENSIONS.....	4
DIAGRAM 1A, 1B,1C, & 1D.....	4
APPLICATION DIAGRAM .....	5
DIAGRAM 2.....	5
DIAGRAM 3.....	6
INSTALLATION .....	7
OPERATION .....	8
HOW TO RELEASE AND REPLACE THE GAS SPRING .....	8
HOW TO INSTALL THE GAS SPRING.....	8
HOW TO REMOVE THE GAS SPRING.....	8
HOW TO INSTALL SECTIONAL PLATES INTO PNP400.....	8
FREQUENTLY ASKED QUESTIONS (FAQ) .....	9
ACCESSORIES.....	9
TROUBLESHOOTING GUIDE .....	10
ALTINEX POLICY.....	10
LIMITED WARRANTY.....	10
RETURN POLICY .....	10
CONTACT INFORMATION .....	10

## PRECAUTIONS / SAFETY WARNINGS 1

Please read this manual carefully before using your **PNP400** Interconnect Tabletop Solution. Keep this manual handy for future reference. These safety instructions are to ensure the long life of your **PNP400** and to prevent fire and shock hazard. Please read them carefully and heed all warnings.

### 1.1 GENERAL

- Unauthorized personnel shall not open the unit since there are high-voltage components inside.
- Qualified ALTINEX service personnel, or their authorized representatives must perform all service.

### 1.2 INSTALLATION

- For best results, place the **PNP400** Interconnect Box in a dry area away from dust and moisture, indoors only.
- To prevent fire or shock, do not expose this unit to rain or moisture. Do not place the **PNP400** Interconnect Tabletop Solution in direct sunlight, near heaters or heat radiating appliances, or near any liquid. Exposure to direct sunlight, smoke, or steam can harm internal components.
- Handle the **PNP400** Interconnect Tabletop Solution carefully. Dropping or jarring can damage internal components.
- Be careful. Serious injury could result because of the sharp edges inside of the **PNP400**.
- Do not place heavy objects on top of the **PNP400**. Do not use excessive force to push down on the top of the unit.
- To turn off main power, disconnect the power cord, which powers the power socket on the **PNP400** outlets.
- We recommend using wall outlets with a Ground Fault Circuit Interrupter (GFCI) for maximum protection.
- Install all cables according to the instructions. Do not force or pull out any

cable or power cord that is attached to the **PNP400** Interconnect Tabletop Solution.

### 1.3 CLEANING

- Surfaces should be cleaned with a dry cloth. Never use strong detergents or solvents, such as alcohol or thinner. Do not use a wet cloth or water to clean the unit.

## ABOUT YOUR PNP400

2

The **PNP400** is designed for installation into a conference room table. The **PNP400** Interconnect Tabletop Solution provides a means of connecting A/V, network and power sources into a presentation system. It is ideal for use together with ALTINEX computer video interfaces, such as VA6804FC. The **PNP400** Interconnect Box can “pop up” into a raised position to provide access to connectors or it can be lowered into a table when not in use. The **PNP400** uses a tower-type construction with pneumatic suspension to accomplish this.

The **PNP400** Interconnect Box has two openings on either side of the unit, servicing both sides of a table. Several optional sectional plates with Computer Video (15-pin HD); Composite Video (RCA), Audio (RCA), Computer Audio (Stereo Mini), Modem (RJ-11), 9-pin D-type RS-232 and Network (RJ-45) input connections can be used with the **PNP400**. For additional information regarding optional connectors, contact the ALTINEX Sales Department.

The **PNP400** Interconnect Box is designed for use with tables ranging from one to three inches thick. The **PNP400** comes in a standard matte black color. The top of the unit can be finished to match the table. This is available on a custom per order basis at an additional charge.

## TECHNICAL SPECIFICATIONS

3

MECHANICAL	PNP400 (standard)
<b>Mechanical</b>	
Width (inches)	6.030in (153mm)
Height (opened)	7.630in (194mm)
Depth (inches)	2.840in (73mm)
Finish	Black
T° Operating	10°C-35°C
T° Maximum	50°C
Humidity	90% non-condensing

Table 1. **PNP400** Mechanical

**PNP400 DIMENSIONS** 4

Diagrams: 1A, 1B, 1C, & 1D

**TOP VIEW  
OF PNP400**

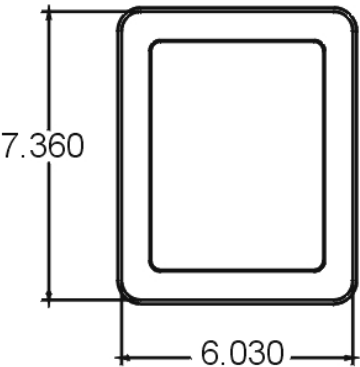

Diagram 1A

**FRONT or BACK VIEW  
(opened PNP400)**

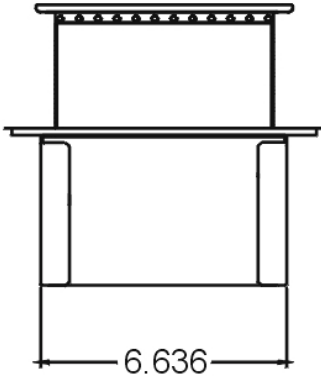

Diagram 1B

**SIDE VIEW  
(opened PNP400)**

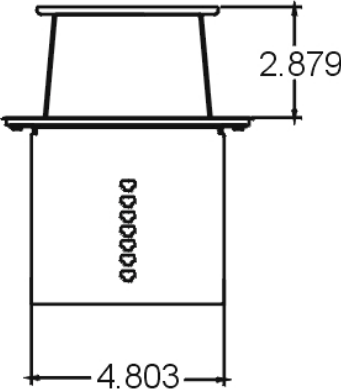

Diagram 1C

**SIDE VIEW  
(closed PNP400)**

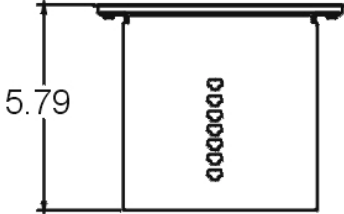
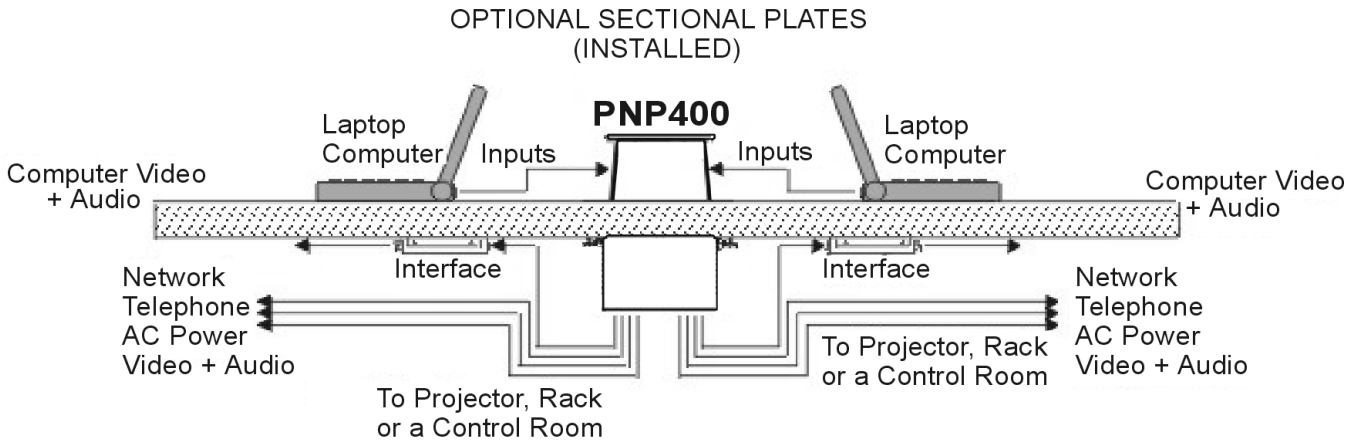

Diagram 1D

**APPLICATION DIAGRAM 5**

**Diagram 2: Application**



Note: Diagram 2 is shown with special connector plates and cables installed. Connectors and cables are not shipped with **PNP400**, they must be ordered separately. For more information regarding connectors and cables designed for the **PNP400**, contact the ALTINEX Sales Department at (714) 990-2300 or visit the ALTINEX website at [www.altinex.com](http://www.altinex.com).

**Diagram 3: Table Cutout Requirements**

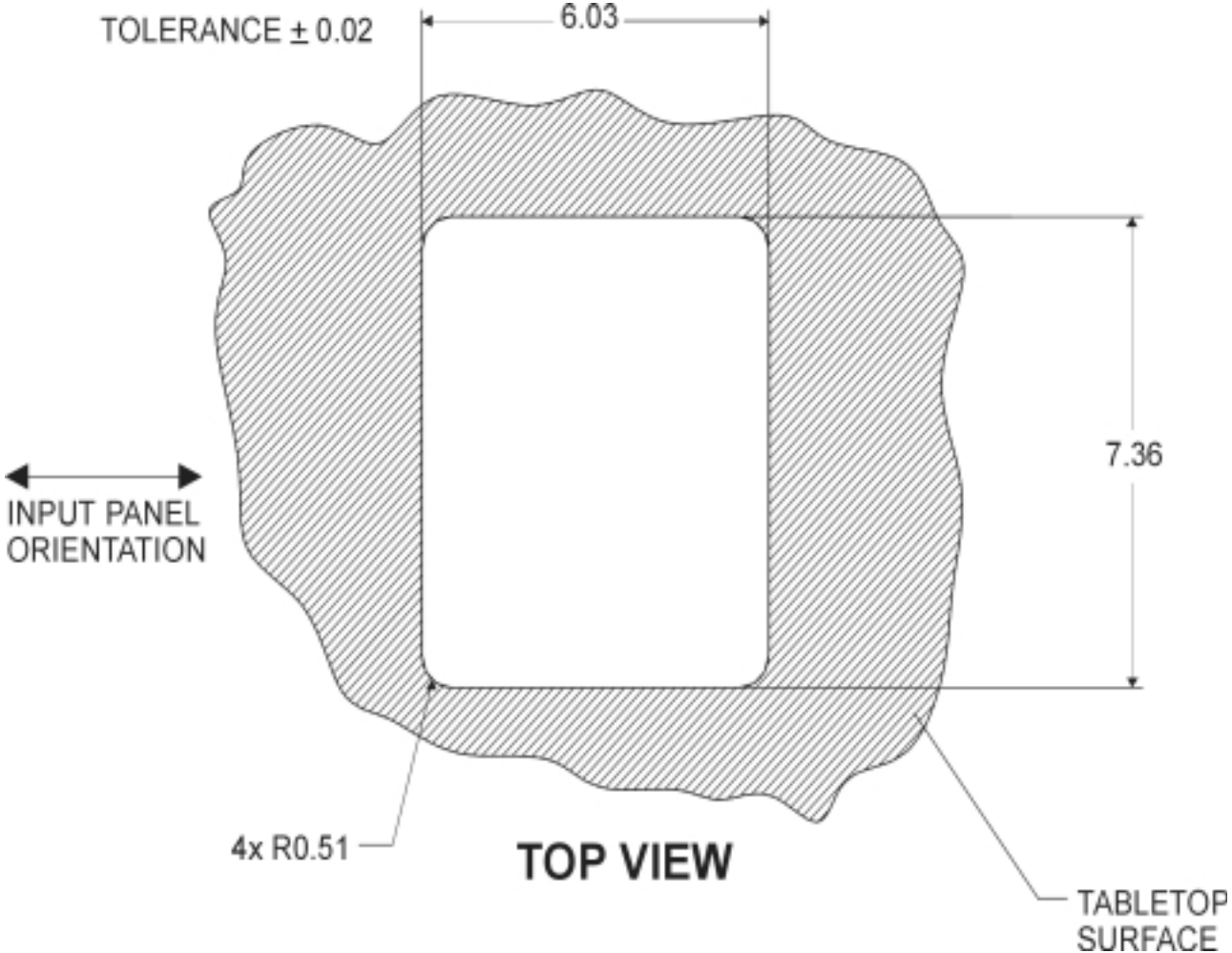

Note: Specifications subject to change without notice. Measurements are NOT to scale. Always confirm measurements before cutting to insure that specifications have not changed. Always make sure to orient cutout in the direction necessary for proper operation of the installed unit.



## INSTALLATION

6

**Step 1.** The **PNP400** ships with a shipping screw. To remove the shipping screw, push down and turn the spring retaining knob by 90 degrees. Then remove the knob from the **PNP400**. The spring retaining knob is the smallest silver colored knob that is located in the center on the bottom of the unit.

Re-engage the gas spring by pushing down on the retaining knob and turning it back to the original position, thereby locking the gas spring into place.

**Step 2.** Cut an opening into the table's surface. Refer to diagram 3 on page 6 of the manual or the ALTINEX website at [www.altinex.com](http://www.altinex.com) for table cutout requirements. Note: The table can be 3 inches or thinner in thickness. Always confirm dimensions before cutting to ensure that specifications have not changed.

**Step 3.** Place the table support brackets under the table and place them between the grooves on the side of the **PNP400** unit. Place the brackets at the desired height and secure them to the bottom of the table using a set screw. There are two support brackets, one for each side of the unit. (See Figure 1)

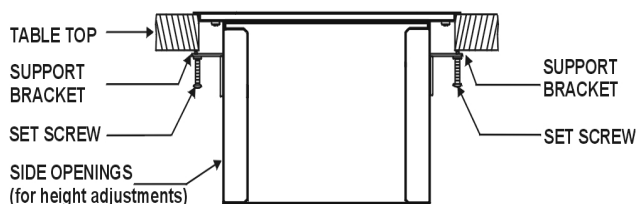

**Figure 1: Attachment of the PNP400 to the table using support brackets and set screws**

**Step 4.** Secure the cables by using a cable clamp. Pass the power cord from the bottom of the housing and attach it to the table using the cable clamp supplied with the **PNP400**

unit. Do not keep the cord too tight or too loose. (See Figure 2)

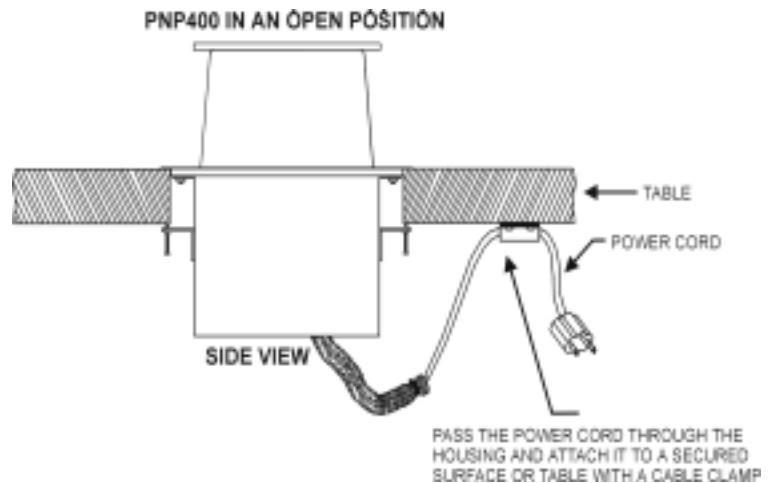

**Figure 2: Cable Clamp Installation for Service Loop (diagram above shows only the power cord not the cables)**

**Step 5.** Connect the appropriate cables with the correct connectors of the media sources (video, audio, etc.) being used on the sectional plates.

**Step 6.** Once you have connected power and the proper cables to the unit, you may raise the unit. To raise the **PNP400** into position, press the top of the unit.

**Step 7.** To lower the unit, push on the top of the **PNP400** until it fits into place.

**For more information, please refer to the FAQ Section or the Troubleshooting Guide.**

7



## OPERATION

7

### 7.1 HOW TO RELEASE AND REPLACE THE GAS SPRING

To replace the gas spring, push up, and turn the knob in the center on the bottom of the **PNP400** by 90 degrees, thereby releasing the gas spring. (See figure 3)

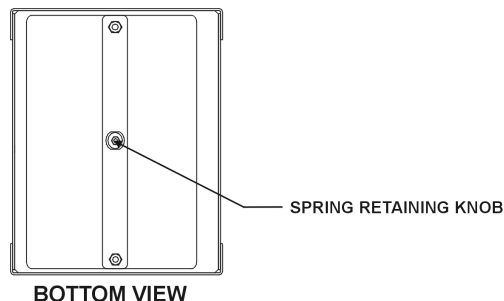

Figure 3: Spring Retaining Knob

Unscrew the spring retaining knob, and then unscrew the gas spring itself from the **PNP400**. Replace the gas spring with a new one by screwing it in, and then replacing the spring retaining knob.

Re-engage the new gas spring by pushing up, and turning the knob by 90 degrees. After you have finished this step, you have completed the installation.

### 7.2 HOW TO INSTALL THE GAS SPRING

Screw the gas spring into the bottom plate with the compression rod facing towards you. Then tighten the gas spring support onto the gas spring compression rod. Insert the gas spring support by compressing the gas spring compression rod into the housing and align it with the mounting holes. Fasten the compression rod using 4-40 hardware. Under normal conditions the gas spring will last more than five years.

### 7.3 HOW TO REMOVE THE GAS SPRING

To release the gas spring support from the housing, remove the mounting screws. Then unscrew the gas spring compression rod from the bottom plate.

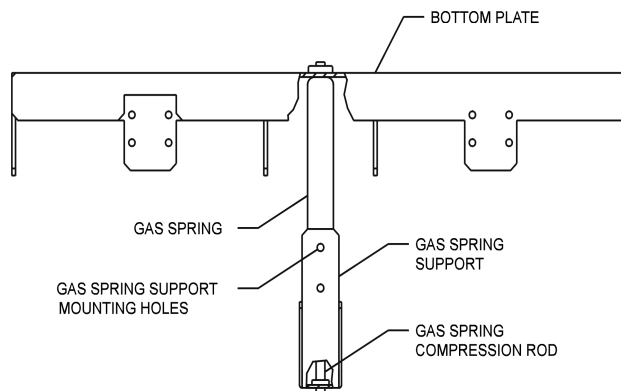

Figure 4: Removing the Gas Spring

### 7.4 HOW TO INSTALL SECTIONAL PLATES INTO PNP400

Install sectional plates in the empty slots on each side of the **PNP400** until the plates snap into place. Secure the plates using the mounting screws as shown in figure 5.

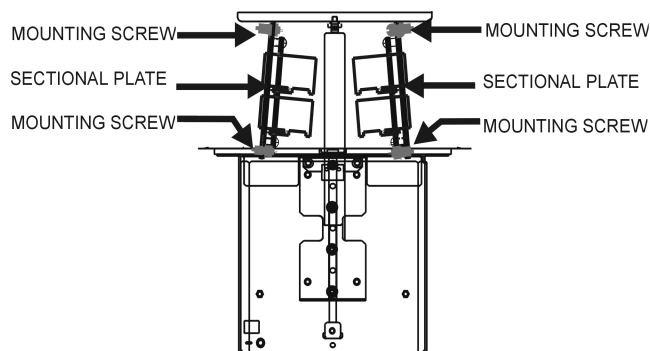

Figure 5: Installing Sectional Plates (Internal view of PNP400)

8

## FREQUENTLY ASKED QUESTIONS (FAQ) 8

No:	Question	Answer
1.	What happens if the spring breaks?	The unit will not stay open.
2.	What do I do if the <b>PNP400</b> won't stay open?	Replace the gas spring. Call ALTINEX for service information.
3.	How much room is taken up on the underside of the table?	The unit is 4.5 inches deep maximum below the table; to this dimension add about 2.5 inches for cable clearance.
4.	What if my table is thicker than 3 inches?	Then the area under the table near the <b>PNP400</b> must be reduced to 3 inches of thickness.
5.	Are cables available for connecting a PC/laptop to the <b>PNP400</b> available?	Consider using MS8126CA (3ft) or MS8156CA (6ft) for VGA connection.
6.	Does ALTINEX honor any warranty on field modifications?	Anything modified by non-ALTINEX personnel is not covered by warranty.

## ACCESSORIES 9

Model No.	Description
<b>INPUT/OUTPUT LABELS</b>	
<b>MS8301LB</b>	Adhesive label with text
<b>COVER CUTOUTS</b>	
<b>CVR1001</b>	Cover cutouts for PNP or TNP units
<b>SECTIONAL PLATES</b>	
<b>SP2107US</b>	Dual AC Power Outlet for United States & Canada with 2 slots and 12ft metal conduit
<b>SP2201UK</b>	AC Power Outlet for United Kingdom, Singapore & Hong Kong
<b>SP2301CE</b>	AC Power Outlet for Continental Europe
<b>SP2401AU</b>	AC Power Outlet for Australia & New Zealand
<b>SP3102EP</b>	Dual Empty Snap-in Ports with 1 slot
<b>SP3103EP</b>	Dual Empty Ortronics CAT-6 Snap-in Ports with 1 slot
<b>SP3201AV</b>	15-pin HD-Female to Male + 3.5mm Stereo Female to Male
<b>SP3202AV</b>	15-pin HD-Female to Female Gender Changer + 3.5mm Stereo Female to Terminal Block
<b>SP3204AV</b>	4-pin Mini DIN + RCA Female 3.5mm Stereo with 1 slot (universal plate for PNP400)

## TROUBLESHOOTING GUIDE 10

The **PNP400** supplied unit was carefully tested and no problems were detected; however, we would like to offer the following suggestions:

- Please make sure that the highest quality video, audio, network, and telephone cables or connectors are used.
- If there has been damage, then do not use the **PNP400** unit. Immediately contact the ALTINEX Sales Department to have the unit repaired.

## ALTINEX POLICY 11

### 11.1 LIMITED WARRANTY

ALTINEX warrants that its products and cables are free from defects in materials under normal use and service. This warranty is limited to repairing at company's factory any part or parts of the product that shall within 2 years (90 days for cables) from date of shipment to the purchaser be returned to company with transportation charges pre-paid. The company's examination shall disclose product(s) to be thus defective. The warranty is expressly instead of all other warranties expressed or implied. ALTINEX neither assumes nor authorizes any other person to assume for it any other liability concerning the sale of the products. This warranty shall not apply to any product that shall have been repaired or altered outside of company's factory in any way so as, in its judgment, to affect its stability or reliability, or that has been subject to misuse, negligence or accident.

### 11.2 RETURN POLICY

It is very important to ALTINEX that you receive all products that you have ordered and that this product fulfills your needs. In the unlikely event, that an ALTINEX product needs to be returned please follow the policies below:

ALTINEX will accept all product returns for a period of 30 days from authorized ALTINEX dealers. Products must be returned in an unopened package.

If a product has been opened, the restocking fees will apply. For the restocking fee, please contact an ALTINEX Sales Representative.

If the product is in your possession for more than 30 days, the restocking fees will apply.

ALTINEX will not accept any returns on cables or custom products.

If your product is in warranty and needs service, contact the ALTINEX Sales Department for an RMA (Return Material Authorization). Products returned without an RMA number may experience a delay in service.

If your product is out of warranty and needs service, contact the ALTINEX Sales Department for an RMA (Return Material Authorization). Products returned without an RMA number may experience a delay in service. The service charges will be quoted to you before the actual repairs are done.

### 11.3 CONTACT INFORMATION

#### ALTINEX, INC.

592 Apollo Street  
Brea, CA 92821 USA

TEL: 714-990-2300

TOLL FREE: 1-800-ALTINEX

WEB: [www.altinex.com](http://www.altinex.com)

E-MAIL: [solutions@altinex.com](mailto:solutions@altinex.com)

FAX: 714-990-3303