



MANUAL PART NUMBER: 400-0028-003
PRODUCT REVISION: 1

DA1901SX

VGA LINE ATTENUATOR

USER'S GUIDE

SPECIAL APPLICATION

INTRODUCTION

Altinex appreciates your purchase of the **DA1901SX** Line Attenuator. We are sure you will find it to be reliable and simple to use.

Superior performance for the right price, backed by solid technical and customer support is what Altinex has to offer.

The product you are holding in your hands is designed using state-of-the-art technology and is superior to anything available on the market. You will find this and our other products reliable, long lasting, and simple to operate.

We are committed to providing our customers with signal management solutions to the most demanding audio-visual installations at very competitive pricing.

We appreciate your selection of our products and are confident that you will join the ranks of our many satisfied customers throughout the world.

This manual covers:

DA1901SX - VGA Line Attenuator.

TABLE OF CONTENTS

	Page
PRECAUTIONS / SAFETY WARNINGS	2
GENERAL	2
RACK MOUNT SAFETY GUIDELINES	2
INSTALLATION	2
CLEANING	2
FCC / CE NOTICE	2
ABOUT YOUR DA1901SX	3
TECHNICAL SPECIFICATION	3
DA1901SX DESCRIPTION	4
APPLICATION DIAGRAM	5
INSTALLATION	5
OPERATION	5
FREQUENTLY ASKED QUESTIONS	6
CABLES AND ACCESSORIES	6
ALTINEX POLICY	7
LIMITED WARRANTY	7
RETURN POLICY	7
CONTACT INFORMATION	7

PRECAUTIONS / SAFETY WARNINGS 1

Please read this manual carefully before using your **DA1901SX** Line Attenuator. Keep this manual handy for future reference. These safety instructions are to ensure the long life of your **DA1901SX** and to prevent fire and shock hazard. Please read them carefully and heed all warnings.

1.1 GENERAL

- Unauthorized personnel shall not open the unit since there are high-voltage components inside.
- Qualified Altinex service personnel, or their authorized representatives must perform all service.

1.2. SAFETY GUIDELINES FOR THE RACK-MOUNTING OF THE DA1901SX

- Maximum operating ambient temperature is 35 (degrees C).
- Never restrict the airflow through the devices' fan or vents.
- When installing equipment into a rack, distribute the units evenly. Otherwise, hazardous conditions may be created by an uneven weight distribution.
- Connect the unit to a properly rated supply circuit.
- Reliable Earthing (Grounding) of Rack-Mounted Equipment should be maintained.

1.3 INSTALLATION

- For best results, place the **DA1901SX** Line Attenuator on a flat, level surface in a dry area away from dust and moisture.
- To prevent fire or shock, do not expose this unit to rain or moisture. Do not place the **DA1901SX** Line Attenuator in direct sunlight, near heaters or heat radiating appliances, or near any liquid. Exposure to direct sunlight, smoke, or steam can harm internal components.
- Handle the **DA1901SX** Line Attenuator carefully because dropping or jarring the unit can damage internal components.

- Do not place heavy objects on top of the **DA1901SX**.

1.4 CLEANING

- Unplug the **DA1901SX** before cleaning. Clean surfaces with a dry cloth. Never use strong detergents or solvents, such as alcohol or thinner. Do not use a wet cloth or water to clean the unit.

1.5 FCC / CE NOTICE

- This device complies with Part 15 of the FCC Rules. Operation is subject to the following two conditions: (1) This device may not cause harmful interference, and (2) this device must accept any interference received, including interference that may cause undesired operation.
- This equipment has been tested and found to comply with the limits for a Class A digital device, pursuant to part 15 of the FCC Rules. These limits are designed to provide reasonable protection against harmful interference when the equipment is operated in a commercial environment. This equipment generates, uses, and can radiate radio frequency energy and, if not installed and used in accordance with the instruction manual, may cause harmful interference to radio communications. Operation of this equipment in a residential area is likely to cause harmful interference in which case the user will be required to correct the interference at his own expense.
- Any changes or modifications to the unit not expressly approved by Altinex, Inc. could void the user's authority to operate the equipment.

ABOUT YOUR DA1901SX 2

The **DA1901SX** is a unique device, which provides a cost efficient manner of adjusting the individual red, green, and blue primary color components of a VGA-type signal. The **DA1901SX** is extremely compact and completely passive requiring no power.

The **DA1901SX** offers a single 15-pin HD (VGA) input and single 15-pin HD output. The **DA1901SX** passes RGBHV and RGBS type signals. Sources and displays using BNC connectors require the use of adapter cables.

The input to the **DA1901SX** offers three toggle switches. Each allows 75Ohms termination of one of the primary colors. Three dial knobs located on the output side allow attenuation of each of the three colors. These knobs may be removed, after being positioned to the proper settings to prevent accidental changes.

The attenuation controls allow the adjustment of the signal level to minus 30% of the incoming level. By using the attenuation controls with the input termination switches, a standard video signal can be adjusted above or below 0.7 V.

The **DA1901SX** is used frequently for computer video wall applications where slight adjustments may be made to each monitor to insure that the colors of all of the monitors are equivalent.

TECHNICAL SPECIFICATION 3

FEATURES/ DESCRIPTION	DA1901SX
GENERAL	
No of Inputs	One
Input Connector	15-pin HD Female
No of Outputs	One
Output Connector	15-pin HD Female (passive)
Compatibility	VGA, SVGA, XGA, UXGA, , RGBS, RGsB, Component Video (Y, R-Y, B-Y), S- Video (Y/C) and Composite Video

Table 1. **DA1901SX** General

MECHANICAL	DA1901SX
Width (inches)	1.56in (40mm)
Height (inches)	2.31in (59mm)
Depth (inches)	1.63in (41mm)
Weight (pounds)	0.2lb. (0.09kg)
Ship Weight (pounds)	0.8lb. (0.36kg)
Material	0.1" Al
Finish	Gray
Side Panels	Lexan Overlay
T° Operating	10°C-35°C
T° Maximum	50°C
Humidity	90% non-condensing
MTBF (calculations)	40,000hrs (min.)

Table 2. **DA1901SX** Mechanical

ELECTRICAL	DA1901SX
Input Video Signal	
Level	Unterminated/ 75 Ohms Terminated (switch selectable)
Output Video Signal	
Level	Attenuation control provides 0-30% reduction in signal level
Power	
Consumption	Passive device

Table 3. **DA1901SX** Electrical

SPECIAL APPLICATION

DA1901SX DESCRIPTION

4

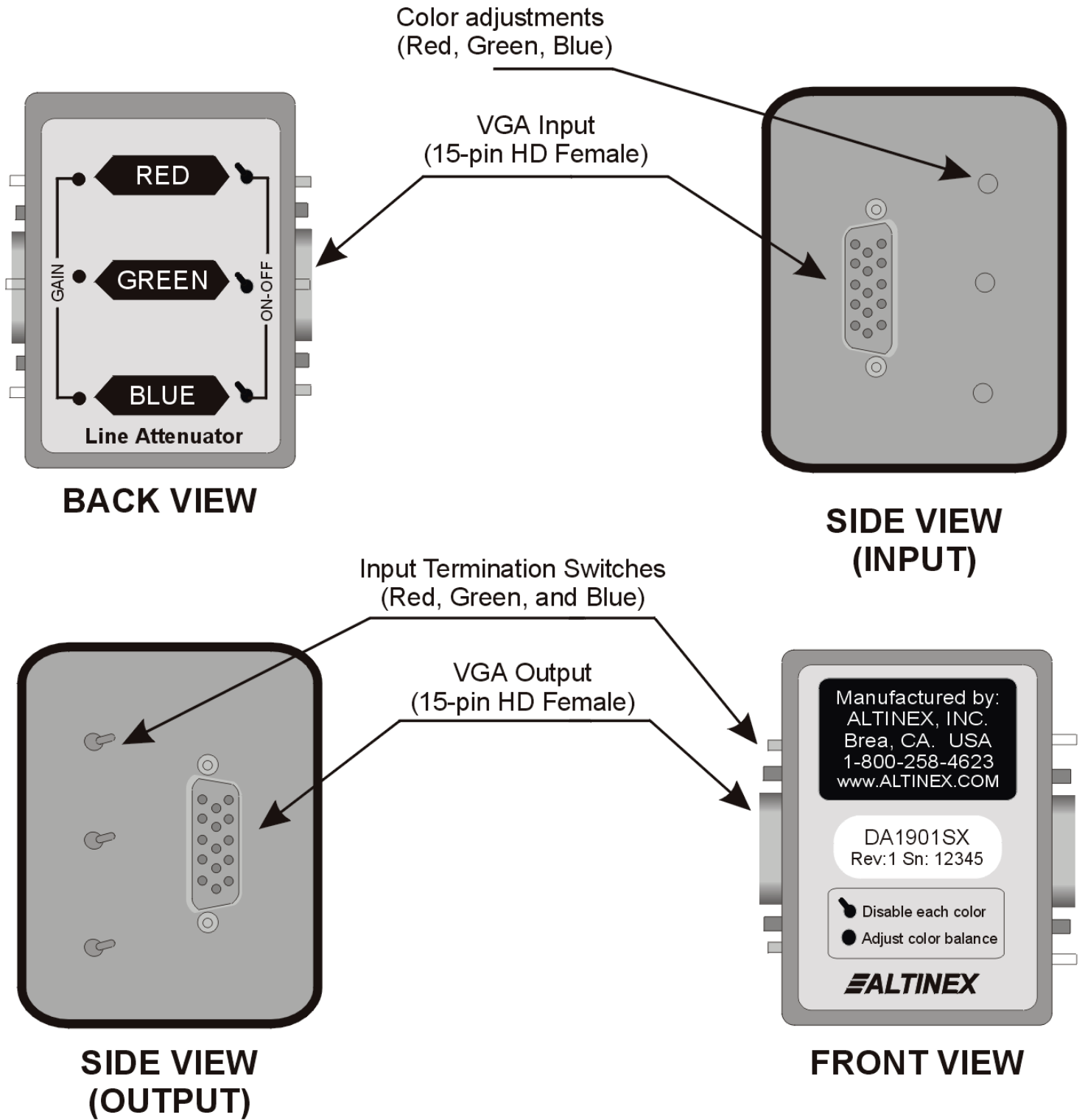

4

ALTINEX

SIGNAL
MANAGEMENT
SOLUTIONS

SPECIAL APPLICATION

APPLICATION DIAGRAM 5

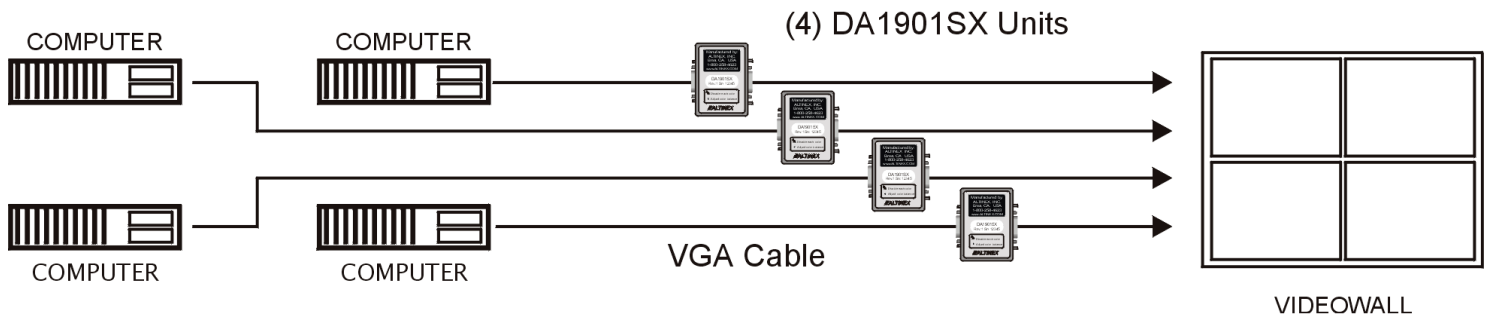

INSTALLATION 6

- Step 1.** Connect the cables from the video source (computer) to the input connector. Connect the output connector to the display devices (monitor or projector). Shielded, high quality coaxial cables are recommended for video cable runs.
- Step 2.** Verify that the display and the audio equipment operate properly and result in a perfect image and sound.
- Step 3.** Please remove the dial knobs located on the output side to allow attenuation of each of the three colors: red, green, and blue. Verify that the quality of the picture is perfect. If the quality of the picture is not perfect, use the color adjustment knobs.

CONGRATULATIONS! YOU ARE DONE.

If you experience any problems, please call
1-800-258-4623 or 1-714-990-2300 for
international calls

OPERATION 7

The settings of the **DA1901SX** can be adjusted using the Input Termination switches located on the input side. If needed, the quality of picture may be adjusted using the color adjustment knobs. There are no other adjustments necessary to operate the unit. The **DA1901SX** will operate successfully as long as the cables are attached properly and other technical specifications are followed.

SPECIAL APPLICATION

FREQUENTLY ASKED QUESTIONS 8

No	Question	Answer
1	When should I use the DA1901SX ?	The DA1901SX is used for computer video-wall applications where slight adjustments may need to be made to each monitor to insure that the colors of all of the monitors are equivalent.
2	Which type of signal may I pass through the DA1901SX ?	You may pass VGA, SVGA, XGA, UXGA, RGBS, RGsB, Component Video (Y, R-Y, B-Y), S-Video (Y/C) and Composite Video through the DA1901SX .
3	Why can't I remove the Color Adjustment knobs before installation?	These knobs can be removed only after installation to prevent accidental changes.

CABLES AND ACCESSORIES 9

Model No.	Description
	MALE TO MALE VGA CABLE
CB3703MR	3 feet
CB3706MR	6 feet
CB3712MR	12 feet
CB3725MR	25 feet
CB3750MR	50 feet
CB3775MR	75 feet
CB37100MR	100 feet
CB37150MR	150 feet
	FEMALE TO FEMALE VGA CABLE
CB3803HR	3 feet
CB3806HR	6 feet
CB3812HR	12 feet
CB3825HR	25 feet
CB3850HR	50 feet
CB3875HR	75 feet
CB38100HR	100 feet
CB38150HR	150 feet
	MALE TO FEMALE VGA CABLE
CB3903HR	3 feet
CB3906HR	6 feet
CB3912HR	12 feet
CB3925HR	25 feet
CB3950HR	50 feet
CB3975HR	75 feet
CB39100HR	100 feet
CB39150HR	150 feet
	VGA TO RGB ADAPTER CABLES
MS8102CA	15-pin HD Male to 5 BNC Male, 6 feet
MS8104CA	15-pin HD Male to 5 BNC Male, 12 feet
MS8105CA	15-pin HD Male to 5 BNC Male, 50 feet
MS8106CA	15-pin HD Male to 5 BNC Female, 6 feet

ALTINEX POLICY

10

10.1 LIMITED WARRANTY

Altinex warrants that its products and cables are free from defects in materials under normal use and service. This warranty is limited to repairing at company's factory any part or parts of the product, which upon company's examination shall disclose to be, thus defective. Products shall be returned to company with transportation charges pre-paid within 2 years (90 days for cables) from date of shipment to the purchaser. The warranty is expressly instead of all other warranties expressed or implied. Altinex neither assumes nor authorizes any other person to assume for it any other liability in connection with the sale of the products. This warranty shall not apply to any product that shall have been repaired or altered outside of company's factory in any way so as, in its judgment, to affect its stability or reliability, or that has been subject to misuse, negligence or accident.

10.2 RETURN POLICY

It is very important to Altinex that you receive the products that you have ordered and that this product fulfills your need. In the unlikely event, that an Altinex product needs to be returned please follow the policies below:

Altinex will accept product returns for a period of 30 days from authorized Altinex dealers. Products must be returned in an unopened package.

If a product has been opened, the restocking fees will apply. For the restocking fee amount, please contact an Altinex Sales Representative.

If the product is in your possession for more than 30 days, the restocking fees will apply.

Altinex will not accept any returns on cables or custom products.

If your product is in warranty and needs service, contact the Altinex Sales Department for an RMA (Return Material Authorization). Products returned without an RMA number may experience a delay in service.

If your product is out of warranty and needs service, contact the Altinex Sales Department for an RMA (Return Material Authorization). Products returned without an RMA number may experience a delay in service. The service charges will be quoted to you before the actual repairs are done.

10.3 CONTACT INFORMATION

Sales Department

Phone: 714-990-2300

Fax: 714-990-3303

Accounting Department

Phone: 714-990-6088

Fax: 714-990-5778