

# ALESIS DM PRO Electronic Percussion System **KIT™ RACK SET UP**

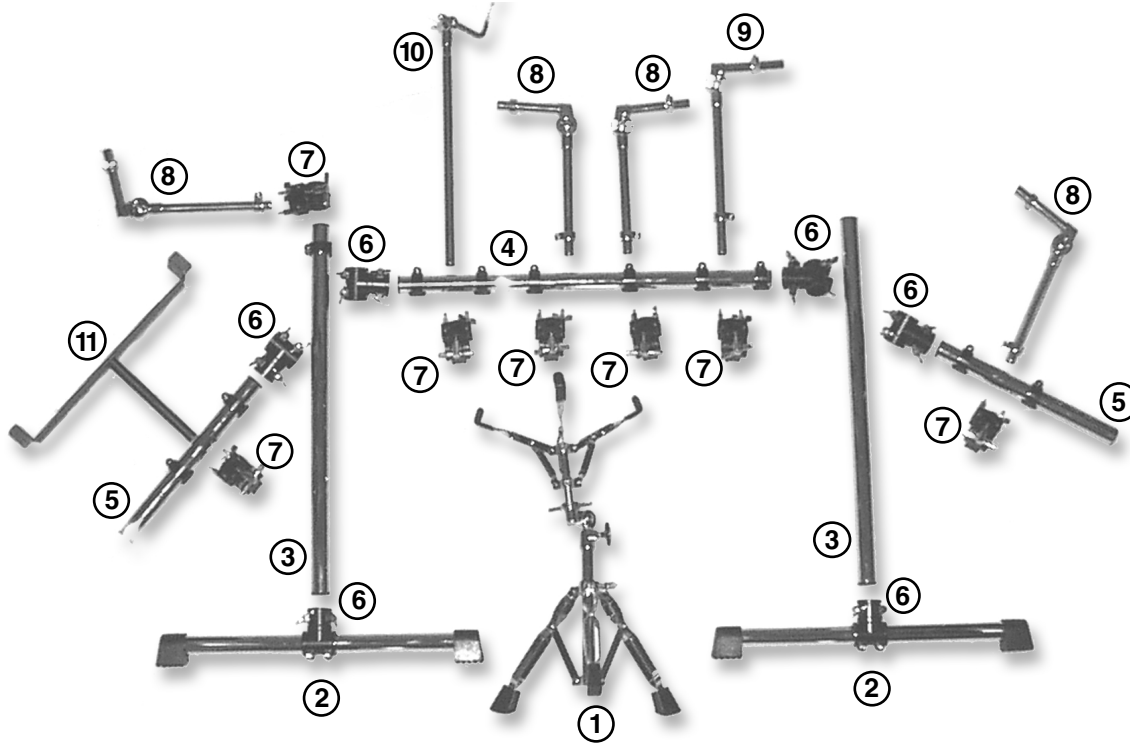

NO.	QTY	PART NAME
①	1	<b>SNST</b> Snare Stand
②	2	<b>TLGA</b> T-Leg assembly
③	2	<b>RTU</b> Rack Tube Upright
④	1	<b>RTCB</b> Rack Tube Cross Bar
⑤	2	<b>RTX</b> Rack Tube Extension
⑥	6	<b>TCL</b> Tube Clamp
⑦	7	<b>RCL</b> Tom/Cymbal Clamp
⑧	4	<b>TMA</b> Tom Arm
⑨	1	<b>LTMA</b> Long Tom Arm (Ride)
⑩	1	<b>CYB</b> Cymbal Arm (Crash)
⑪	1	<b>MMT</b> Module Mount

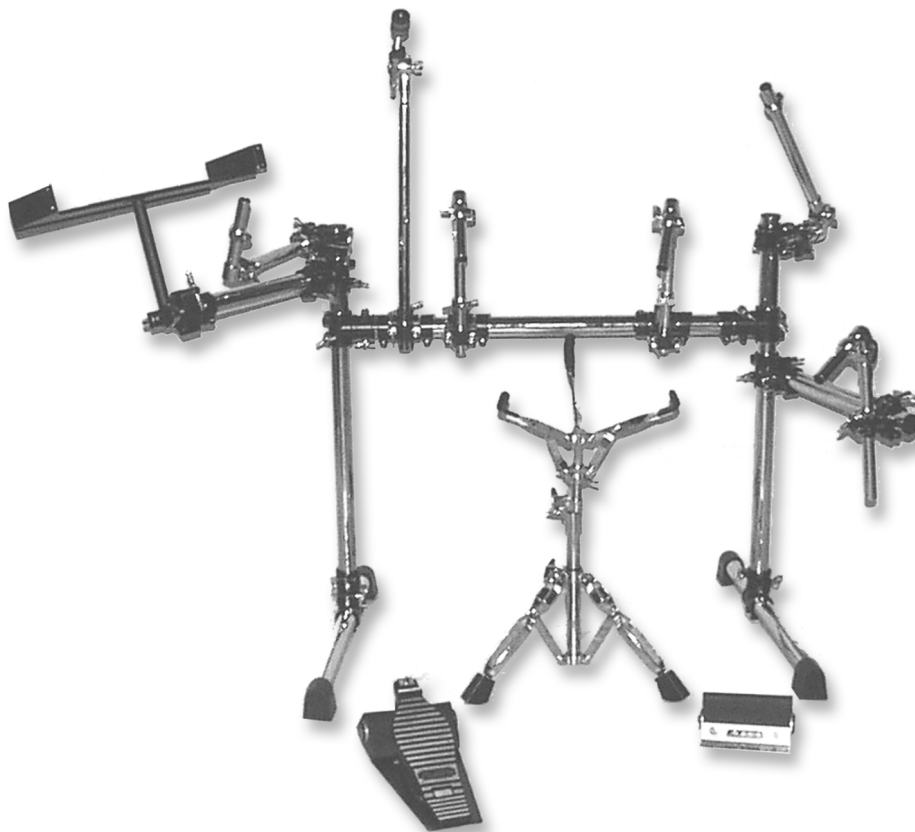

**NOTE:** These pictures show one possible configuration. You should set up and position your drum kit so that it best suits your playing style and taste. Don't be afraid to experiment! If you have questions you can call 800-5-ALESIS or email us at [support@alesis.com](mailto:support@alesis.com).