



# SMITH & WESSON

## 9MM AUTOMATIC PISTOL DOUBLE ACTION MODEL No. 59



### PARTS LIST • INSTRUCTIONS FOR USE • MAINTENANCE • SPECIFICATIONS

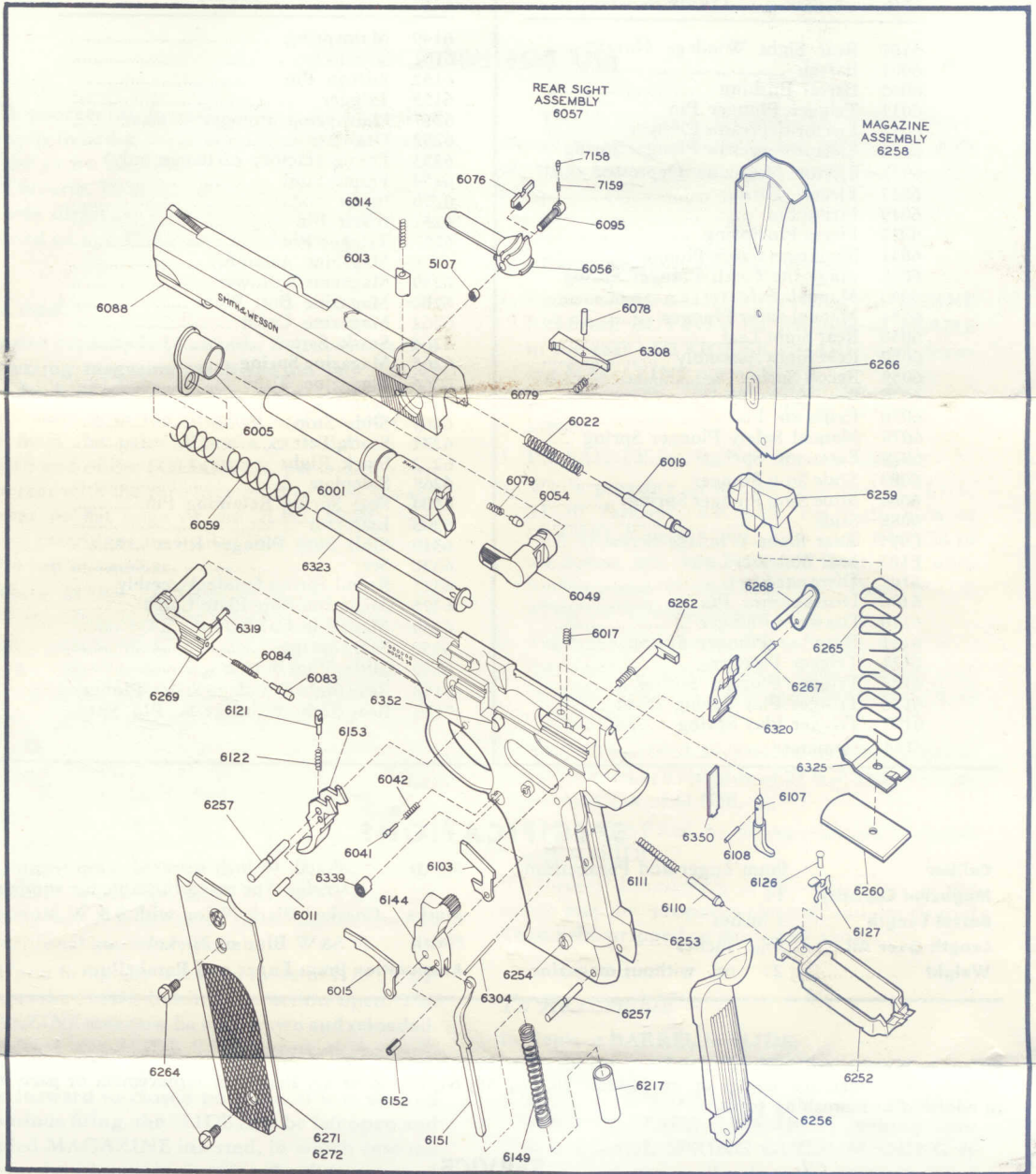

This schematic diagram and parts list conform to the current specifications provided by our Engineering Department. From time to time improvements are made in all our models. For this reason, the gun which you own may not correspond exactly with the information provided on this sheet. When requesting information or ordering parts for your gun, please provide the serial number and approximate date of purchase.

11-74



# SMITH & WESSON 9MM AUTOMATIC PISTOL DOUBLE ACTION MODEL No. 59

## PARTS LIST

No.	Name	No.	Name
1507	Rear Sight Windage Nut .....	6149	Mainspring .....
6001	Barrel .....	6151	Stirrup .....
6005	Barrel Bushing .....	6152	Stirrup Pin .....
6011	Trigger Plunger Pin .....	6153	Trigger .....
6013	Ejector-depressor Plunger .....	6217	Mainspring Plunger .....
6014	Ejector-depressor Plunger Spring ..	6252	Drawbar .....
6015	Ejector Magazine Depressor .....	6253	Frame (factory exchange only) ...
6017	Ejector Spring .....	6254	Frame Stud .....
6019	Firing Pin .....	6256	Insert .....
6022	Firing Pin Spring .....	6257	Insert Pin .....
6041	Magazine Catch Plunger .....	6257	Trigger Pin .....
6042	Magazine Catch Plunger Spring ..	6258	Magazine Assembly .....
6049	Manual Safety .....	6259	Magazine Follower .....
6054	Manual Safety Plunger .....	6260	Magazine Butt Plate .....
6056	Rear Sight Leaf .....	6262	Magazine Catch .....
6057	Rear Sight Assembly .....	6264	Stock Screw .....
6059	Recoil Spring .....	6265	Magazine Spring .....
6076	Rear Sight Slide .....	6266	Magazine Tube .....
6078	Extractor Pin .....	6267	Sear Pin .....
6079	Manual Safety Plunger Spring .....	6269	Slide Stop .....
6079	Extractor Spring .....	6271	Stock, Left .....
6083	Slide Stop Plunger .....	6272	Stock, Right .....
6084	Slide Stop Plunger Spring .....	6268	Sideplate .....
6088	Slide .....	6304	Sear Spring Retaining Pin .....
6095	Rear Sight Windage Screw .....	6308	Extractor .....
6103	Sear Release Lever .....	6319	Slide Stop Plunger Rivet .....
6107	Disconnecter .....	6320	Sear .....
6108	Disconnecter Pin .....	6323	Recoil Spring Guide Assembly .....
6110	Drawbar Plunger .....	6325	Magazine Butt Plate Catch .....
6111	Drawbar Plunger Spring .....	6339	Magazine Catch Nut .....
6121	Trigger Plunger .....	6350	Sear Spring .....
6122	Trigger Plunger Spring .....	6352	Slide Stop Button .....
6126	Trigger Play Spring Rivet .....	7158	Rear Sight Windage Screw Plunger
6127	Trigger Play Spring .....	7159	Rear Sight Windage Sc. Plg. Sprg.
6144	Hammer .....		

## SPECIFICATIONS

<b>Caliber</b> .....	9mm Luger and Parabellum	<b>Sights</b> .....	Fixed, 1/8-inch serrated ramp front; Patridge type rear adjustable for windage
<b>Magazine Capacity</b> .....	14	<b>Stocks</b> .....	Checked Black Nylon with S & W Monograms
<b>Barrel Length</b> .....	4 inches	<b>Finish</b> .....	S&W Blue or Nickel
<b>Length Over All</b> .....	7 7/16 inches	<b>Ammunition</b>	9mm Luger and Parabellum
<b>Weight</b> .....	27 oz. without magazine		

Smith & Wesson will refinish handguns of its own manufacture. No change of finish is offered on the Victory or Airweight® model or on Models 28, 39, 59, 64, 65, 66 or 67. Repair or replacement of parts are in addition to refinishing price.

## SERVICE

Should your Smith & Wesson revolver require adjustment, repair, or refinishing, we recommend most sincerely that the weapon be returned to the factory or authorized service center. There is no other way to insure that the work will be done in a properly equipped and staffed shop.

Charges are very reasonable, being based on the cost of parts replaced plus a labor charge for the time expended on the job. A labor charge for one hour is usually sufficient to cover all but very extensive overhaul jobs.

Revolvers returned to the factory or authorized service center should be MARKED FOR THE ATTENTION OF THE SERVICE DEPARTMENT.

A letter of instructions should be enclosed with the gun, and shipment by individuals must be made Prepaid. Adherence to these suggestions will prevent loss of time in handling at the factory.

When returning guns for service, please remove custom stocks and holsters. We cannot assume responsibility for these items.

When your revolver arrives for service, it will be very carefully inspected, together with your letter of instructions. Next, a quotation covering total cost of work to be performed will be sent to you. No actual work will be commenced before receiving your approval of our quotation unless you specifically authorize us to do so.

SEE YOUR AUTHORIZED SMITH & WESSON  
SERVICE CENTERS LIST FOR YOUR LOCAL SERVICE CENTER

