



## PARTS LIST

# SPORT-KING PUMP ACTION

.22 CALIBER RIFLE

MODEL P-100

### HOW TO ORDER REPAIR PARTS

The following information must be furnished when ordering replacement parts:

1. Model Name and Number
2. Catalog Number
3. Number and Name of Parts

### RIFLE SHIPPING INSTRUCTIONS

**CAUTION:** For safety of all concerned — Be absolutely certain rifle is empty . . . with no shells or cartridges in chamber and magazine. Rifles should be securely packaged in a throwaway carton to prevent damage in transit. Do not ship rifles to the factory in gun carrying case or other special containers which must be returned by our service department.

Rifles should be shipped to the factory — Express Prepaid or insured parcel post.

**REMEMBER:** All Shipments to the factory must be Prepaid.

### FACTORY SERVICE

If parts are to be fitted at the factory, send rifles marked for the attention of our SERVICE DEPARTMENT, furnishing complete and specific repair instructions. A cost estimate of the parts and labor charges will be immediately sent for your approval before work is started. Unless a flat rate charge is specified, a MINIMUM of \$6.50 will be charged on servicing rifles at the factory.

### MINIMUM ORDER \$1.00

A minimum charge of \$1.00 is made on all orders where the normal cost would be less than \$1.00. If you wish, order extra parts to make up the minimum charge.

### PAYMENT

All parts shipments will be made by Parcel Post C.O.D. unless advance remittance is made. PLEASE DO NOT SEND CASH OR STAMPS. Checks, Money Orders, or Drafts are acceptable and will save you C.O.D. charges.

**THE HIGH STANDARD MANUFACTURING CORPORATION, Hamden, Conn.**

## SPECIFICATIONS

Length of Pull 13  $\frac{1}{8}$  inches  
 Drop at Heel 2  $\frac{3}{8}$  inches  
 Drop at Comb 1  $\frac{5}{16}$  inches  
 Barrel Length 24 inches  
 Over-All Length 41  $\frac{3}{4}$  inches  
 Weight of Gun Approx. 6 Lbs.  
 Butt Stock & Fore-end American Walnut

Magazine Capacity 17 L.R., 19 Long,  
 or 24 Short  
 Front Sight Rocky Mountain partridge  
 type with serrated blade  
 Rear Sight for elevation at 25 yard  
 intervals.

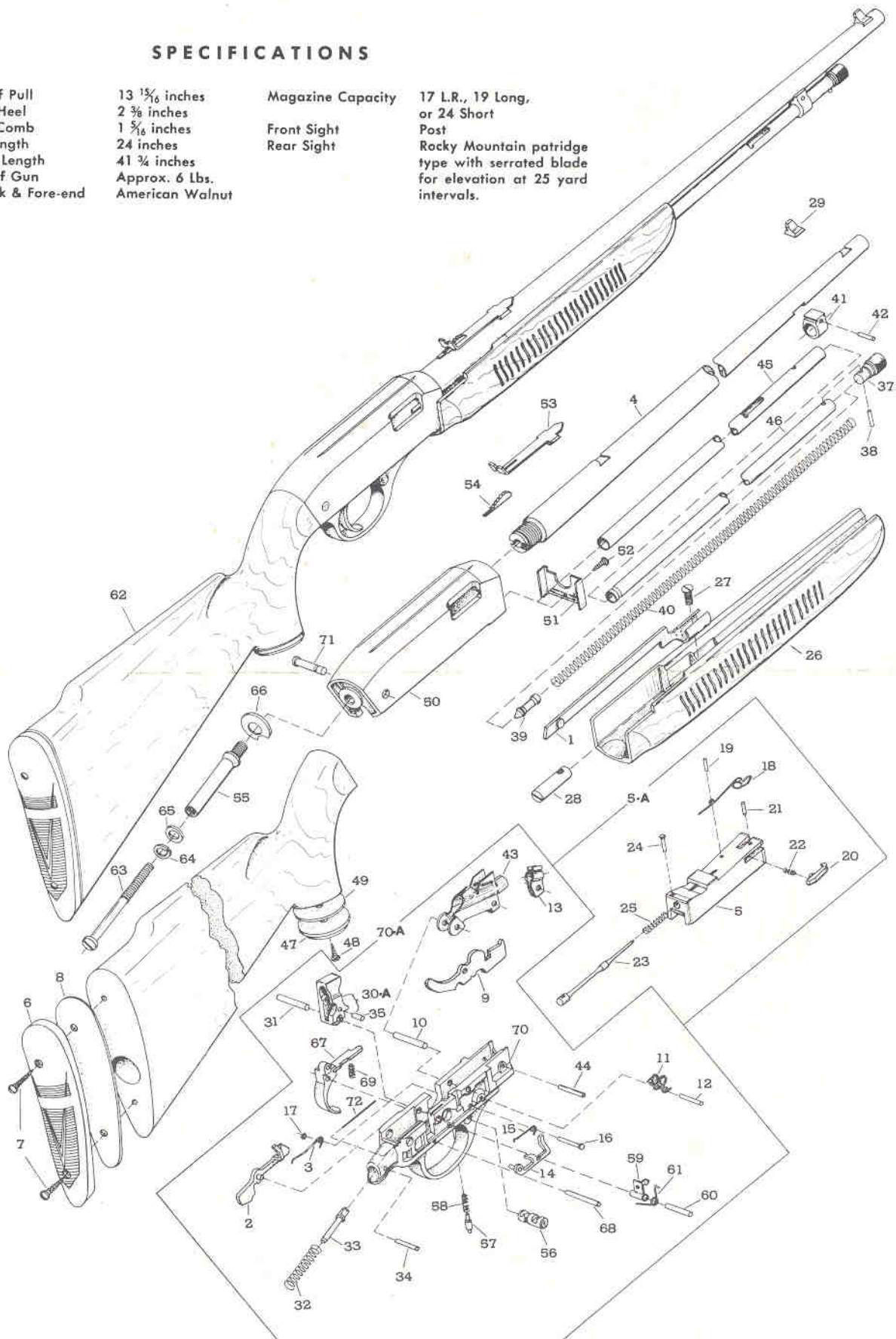

**CAUTION:** FOR SAFETY'S SAKE DO NOT ATTEMPT TO REPAIR RIFLES WITHOUT RECEIVING RELIABLE A



PARTS LIST FOR

SPORT-KING PUMP ACTION CAT. #8004 MODEL P-100

WHEN ORDERING REPAIR PARTS, ALWAYS GIVE THE FOLLOWING INFORMATION AS SHOWN IN THIS LIST:

1. THE PART NUMBER.
2. THE PART NAME.
3. RIFLE MODEL NUMBER AND NAME.
4. THE CATALOG NUMBER.

All parts identified with a (†) must be fitted to the gun at the factory. Do not order repair parts by key number, always use the part number.

(Prices Subject to Change Without Notice)

KEY NO.	PART NO.	DESCRIPTION	RETAIL PRICE EACH	KEY NO.	PART NO.	DESCRIPTION	RETAIL PRICE EACH
1	3530	† Action Bar Assembly	\$ 3.50	39	3417	Magazine Follower	\$ .40
2	4006-M	Action Bar Locking Lever Assembly	1.10	40	4040	Magazine Spring	.40
3	4014	Action Bar Locking Lever Spring	.25	41	4018	Magazine Support	.95
4	8990	Barrel	11.00	42	338	Magazine Support Pin	.25
5	3511	Bolt	8.00	43	3435	Magazine Throat & Pin Assy.	1.25
5A	3533	Bolt Assembly	10.50	44	310	Magazine Throat Retaining Pin	.25
6	8601	Butt Plate	1.30	45	4070	Magazine Tube, Outer	1.40
7	345	Butt Plate Screw (2)	.25	46	3420	Magazine Tube, Inside	1.40
8	8622	Butt Plate Trim (3)	.80	N.I.	3432	Magazine Tube, Inside Assembly (Complete)	2.25
9	3412	Cartridge Lifter	1.70	47	8625	Pistol Grip Cap	.40
10	308	Cartridge Lifter Pin	.25	48	403	Pistol Grip Cap Screw	.25
11	460	Cartridge Lifter Spring	.25	49	8626	Pistol Grip Cap Trim (3)	.40
12	4026	Cartridge Lifter Spring Retaining Pin	.25	50	3513	† Receiver (Not Sold As Replacement Part)	10.50
13	3413	Cartridge Cut Off Spring	.25	51	524	Receiver Shoe	.40
14	4028-M	† Disconnecter Assembly	1.00	52	525	Receiver Shoe Screw	.25
15	463	Disconnecter Spring	.25	53	3479	Rear Sight	1.00
16	4012	Disconnecter Spring Retaining Pin	.25	54	479	Rear Sight Elevator	.30
17	4011	Disconnecter Spring Retaining Washer	.25	55	150	Receiver Tang	.75
18	4030	Ejector	.55	56	4043	Safety Button	.75
19	4039	Ejector Retaining Pin	.25	57	4044	Safety Button Plunger	.25
20	3426	Extractor RH	1.50	58	360	Safety Button Plunger Spring	.25
21	466	Extractor Retaining Pin	.25	59	428	† Sear	.50
22	523	Extractor Spring	.25	60	4026	Sear Pin	.25
23	468	Firing Pin	1.55	61	351	Sear Spring	.25
24	469	Firing Pin Retaining Pin	.25	62	8992	Stock Assembly	9.75
25	320	Firing Pin Spring	.25	63	353	Stock Bolt	.50
26	4017	Forearm	7.75	64	354	Stock Bolt Lockwasher	.25
27	4019	Forearm Screw	.25	65	182	Stock Bolt Washer	.25
28	4020	Forearm Stud	.40	66	424	Stock Washer	.25
29	3477	Front Sight, High	.50	67	427-M	Trigger and Trigger Extension Assembly	1.50
30A	4078	Hammer Assembly	2.60	68	359	Trigger Pin	.25
31	325	Hammer Pin	.25	69	360	Trigger Spring	.25
32	326	Hammer Spring	.25	70	3514	Trigger Guard	6.50
33	327	Hammer Spring Guide	.40	70A	3536	Trigger Guard Assembly (Complete)	21.00
34	328	Hammer Spring Pin	.25	71	376	Trigger Guard Retaining Pin	.25
35	328	Hammer Strut Pin	.25	72	377	Trigger Guard Retaining Pin Spring	.25
37	331	Magazine Cap	.40				
38	328	Magazine Cap Pin	.25				

(N.I.-Not Illustrated)

# INSTRUCTIONS FOR OPERATION AND CARE OF YOUR HI-STANDARD SPORT-KING RIFLE

## Cat. No. 8004 Model P-100

You're looking at the slickest .22-caliber pump-action rifle ever made. It's accurate, rugged, dependable! In the field or on the range, this Sport-King will give you the kind of performance that means shooting success. Your Sport-King uses regular or high-speed ammunition in .22-caliber rimfire Short, Long, or Long Rifle interchangeably and without adjustment. The magazine holds 17 Long Rifle, 19 Long, or 24 Short .22-caliber cartridges.

**IMPORTANT:** Before firing this rifle, be sure to clean barrel thoroughly of grease or obstructions.

### CLEANING & LUBRICATING

Should any powder or dirt accumulate in the barrel, it can easily be removed. To clean barrel, empty the gun and open the action by pulling forearm fully back (see Operating Instructions). Push a patch, moistened with a good solvent, through the barrel from the muzzle end. Soak a brass brush made for a .22-caliber rifle in solvent and push it through the entire bore several times, using long, even strokes. Push clean patches through the bore in the same manner until the last patch comes out clean. Then push a lightly oiled patch through the length of the bore. Use a wire brush soaked in solvent to remove any powder residue from trigger assembly, bolt, extractors, and other operating parts. Wipe parts dry, oil lightly, and replace.

Your Sport-King is treated with new siliconized and polarized oil. This exclusive, patented process gets down into the pores of the steel and protects against perspiration and other corrosive elements which cause rust. It gives the best lubrication of any oil tested and it protects and beautifies stock and forearm.

### OPERATING INSTRUCTIONS

For trouble-free operation clean heavy protective oils from your rifle before firing. After cleaning, coat parts lightly with light gun oil. For protection, your rifle also should be cleaned and oiled lightly after shooting and before storage.

**TO MAKE GUN SAFE:** Safety is located in trigger guard bow forward of trigger. With hammer cocked, push safety from left to right until red band is covered. This movement locks trigger, and gun cannot be fired. Always lock the trigger when carrying a loaded gun.

**TO RELEASE SAFETY:** Push safety from right to left, exposing red band, and gun is ready to fire.

**TO LOAD MAGAZINE:** With safety on, turn knurled knob on inner magazine tube, pull tube out and insert cartridges into cartridge opening, continuing the operation until last cartridge is visible. The exclusive side loading port permits faster loading. Simply slide cartridges along groove formed by barrel and magazine tube until they drop into port. Grasping knurled portion of inside magazine tube, press down with rotating action until magazine tube is fully down and located in supporting notch.

**TO LOAD CHAMBER:** Open action fully by pulling back on forearm. If forearm does not come back easily, press action slide release located at left-rear of trigger-guard. This unlocks action and forearm can now be brought back. Push forearm forward. This carries a cartridge into the chamber and the gun is ready to fire.

**TO REMOVE CARTRIDGES WITHOUT FIRING:** Be sure gun is on safety, with red band on safety button NOT showing. Remove inside magazine tube and pour cartridges out of front end of magazine tube into hand. Replace inside magazine tube and lock it. Then push down action slide release at left-rear of trigger guard bow and work forearm back and forth. This will remove a cartridge in the chamber. To be certain gun is unloaded, work action again, leaving forearm fully back, and look into chamber from rear to make certain that gun is empty of cartridges.

### DISASSEMBLY

**TO REMOVE TRIGGER GUARD ASSEMBLY:** Turn gun upside-down and push out trigger-guard retaining pin from left to right. Then grasp trigger guard and pull up and toward the butt stock. Trigger-guard assembly will come out of the receiver as a unit.

**TO REMOVE BOLT:** With gun still upside-down, place right hand over bottom of receiver, from where trigger-guard assembly was removed. Turn gun over. Then, with the left hand, pull forearm back slowly and bolt will drop out into right hand.

### ASSEMBLY

**TO ASSEMBLE BOLT:** Turn gun upside-down and insert bolt into bottom of receiver making sure that action bar stud engages slot on side of bolt.

**TRIGGER-GUARD ASSEMBLY:** Make certain that hammer is in cocked position. Replace trigger-guard assembly by inserting lug on front end of assembly into slot in receiver. Press down and forward until it is fully seated. Then, insert trigger-guard retaining pin from right to left.