



# HI-STANDARD PISTOLS



PARTS PRICE LIST — 22 CALIBER (MODELS\* M-100, M-101)

"Dura-Matic"

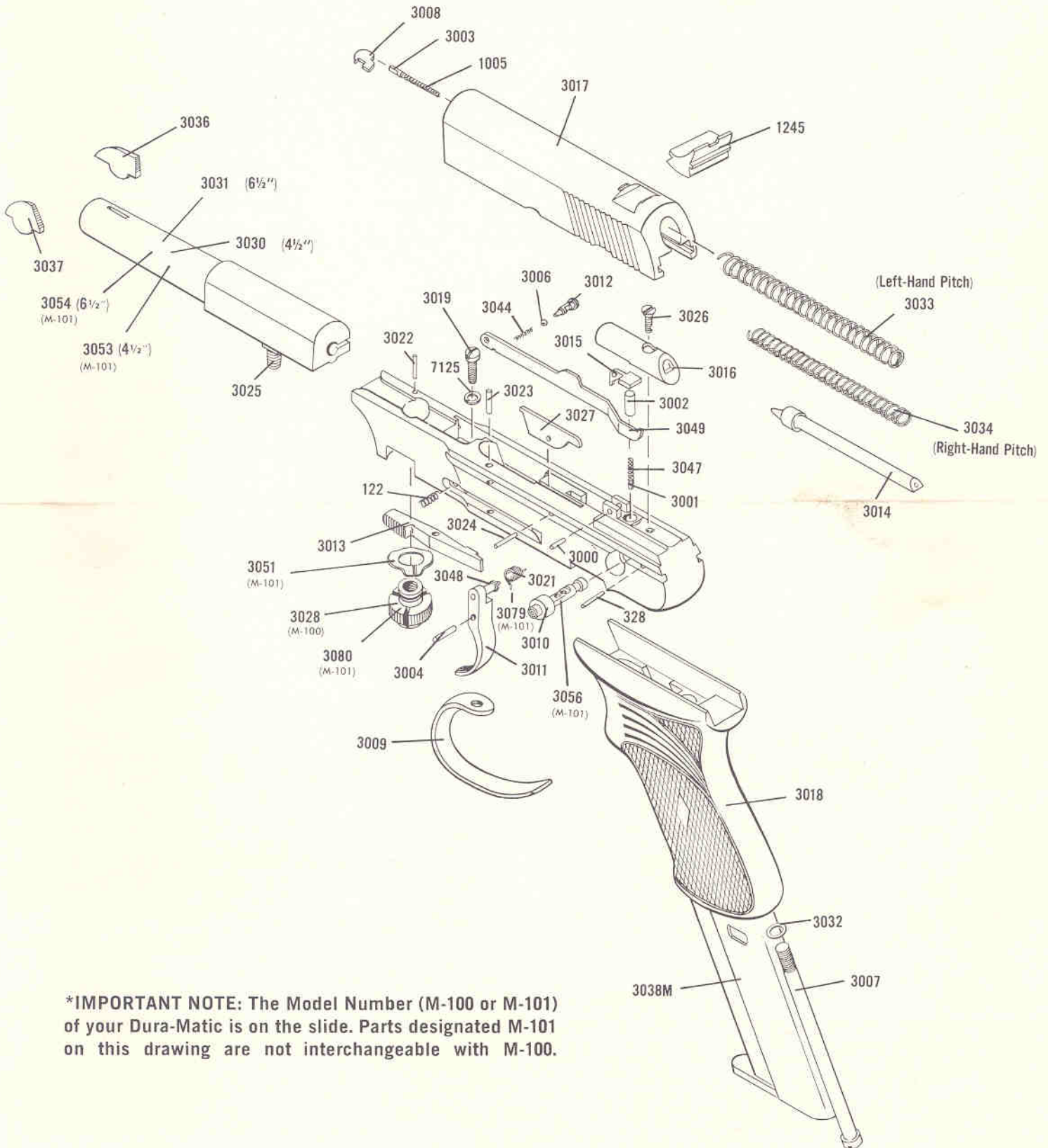

**\*IMPORTANT NOTE:** The Model Number (M-100 or M-101) of your Dura-Matic is on the slide. Parts designated M-101 on this drawing are not interchangeable with M-100.

# HI-STANDARD

## .22 CAL. SEMI-AUTOMATIC PISTOLS

### PARTS LIST AND PRICES

(Prices Subject to Change Without Notice)

MODELS  
Dura-Matic M-100, M-101

★ ★ ★ ★ ★ ★ ★ ★ ★ ★ ★ ★ ★ ★ ★ ★ ★ ★ ★ ★ ★ ★

#### HOW TO ORDER REPAIR PARTS

The following information must be furnished when ordering replacement parts:

1. Model Name and Series Number (M-100 or M-101)
2. Serial Number
3. Number and Name of Parts.

#### MINIMUM ORDER \$1.00

Due to the large amount of clerical and detail work connected with the processing of each shipment, it is necessary to charge a minimum of \$1.00 for each order when the normal value is below \$1.00. If you wish, order extra parts to make up the minimum charge.

#### PAYMENT

All parts shipments will be made by Parcel Post C.O.D. unless advance remittance is made. PLEASE DO NOT SEND CASH OR STAMPS. Checks, Money Orders, or Drafts are acceptable and will save you C.O.D. charges.

\*There is an extra charge of \$4.00 for fitting barrels at the factory.

#### FACTORY SERVICE

If parts are to be fitted at the factory, send pistols marked for the attention of our SERVICE DEPARTMENT, furnishing complete and specific repair instructions. A cost estimate of the parts and labor charges will be immediately sent for your approval before work is started.

Unless a flat rate charge is specified, a MINIMUM of \$6.50 will be charged on servicing pistols at the factory.

#### PISTOL SHIPPING INSTRUCTIONS

BONAFIDE DEALERS IN FIREARMS are permitted by postal regulations to send pistols to the factory by Parcel Post. INDIVIDUALS are not permitted to mail firearms and we recommend shipment by railway express.

All shipments to factory must be prepaid.

PART NO.	PART NAME	MODEL	PRICE EACH	PART NO.	PART NAME	MODEL	PRICE EACH
3030	Barrel 4½"	M-100	11.50	3007	Grip Bolt	M-100, M-101	.35
3053	Barrel 4½"	M-101	11.50	3032	Grip Bolt Washer	M-100, M-101	.30
3031	Barrel 6½"	M-100	11.50	3038M	Magazine Assembly	M-100, M-101	4.75
3054	Barrel 6½"	M-101	11.50	1524	Magazine Button	M-100, M-101	.30
3006	Barrel Lock Ball	M-100	.30	3013	Magazine Catch	M-100, M-101	1.75
3044	Barrel Lock Ball Spring	M-100	.30	3023	Magazine Catch Pin	M-100, M-101	.30
3012	Barrel Lock Plunger	M-100	.30	122	Magazine Catch Spring	M-100, M-101	.30
3022	Barrel Lock Plunger Pin	M-100	.30	1219	Magazine Follower	M-100, M-101	.75
3028	Barrel Nut	M-100	1.00	1120	Magazine Spring	M-100, M-101	.60
3080	Barrel Screw	M-101	1.00	3056	Safety	M-100, M-101	1.50
3051	Barrel Nut Lockwasher	M-101	.30	3001	Safety Detent	M-100, M-101	.30
3025	Barrel Set Screw	M-100	.30	3015	Sear	M-100, M-101	2.50
3027	Ejector	M-100, M-101	.85	3082	Sear Bar and Trigger Pull Pin and Trigger Spring (# 3079) Assembly—Must be sold as an assembly for Model 100 Series guns.	M-100	1.30
3024	Ejector Pin	M-100, M-101	.30	3049	Sear Bar and Trigger Pin Assembly	M-101	1.00
3008	Extractor	M-100, M-101	.75				
3003	Extractor Plunger	M-100, M-101	.30				
1005	Extractor Spring	M-100, M-101	.30				
3018	Grip	M-100, M-101	3.25				

**CAUTION:** FOR SAFETY'S SAKE DO NOT ATTEMPT TO REPAIR PISTOLS WITHOUT RECEIVING RELIABLE

PART NO.	PART NAME	MODEL	PRICE EACH	PART NO.	PART NAME	MODEL	PRICE EACH
3000	Sear Pin	M-100, M-101	.30	3034	Striker Spring	M-100, M-101	.30
3002	Sear Plunger	M-100, M-101	.30	3011	Trigger	M-100, M-101	2.00
3047	Sear Spring	M-100, M-101	.30	3009	Trigger Guard	M-100, M-101	.50
3037	Sight, Front, Short Barrel	M-100, M-101	1.25	3050	Trigger Guard Screw	M-100, M-101	.30
3036	Sight, Front, Long Barrel	M-100, M-101	1.25	7125	Trigger Guard Screw Lock Washer	M-100, M-101	.30
1245	Sight, Rear, Fixed (No Adjustable Rear Sight Available for this Model)	M-100, M-101	1.50	3004	Trigger Pin	M-100, M-101	.30
3017	*Slide (only)	M-100, M-101	13.50	3048	Trigger Pull Pin	M-100	.30
3033	Slide Spring	M-100, M-101	.30	3021	Trigger Spring	M-100	.30
3014	Striker Pin (See "Note" Below)	M-100, M-101	2.50	3079	Trigger Spring	M-101	.30
3016	*Striker Sleeve	M-100, M-101	1.75	3041	*Slide and Rear Sight Assembly (Includes Rear Sight, Extractor, etc.)	M-100, M-101	17.60
3026	Striker Sleeve Screw	M-100, M-101	.30				
3077	Striker Sleeve Screw Locking Pin	M-100, M-101	.30				

\*Slides and Striker Sleeves are not considered interchangeable and must be fitted at the factory.



## BEST FOR FUN and FIELD . . . HI-STANDARD FIREARMS . . .



**FLITE-KING**, 12 and 16 gauge, Pump Action Shotguns shoot all 2¾" shot shells, even rifled slugs. A wide variety to choose from — plain barrel, ventilated rib, adjustable choke, skeet and trap grades.



**SUPERMATIC**, 12 gauge, Autoloading Shotguns, ranging from low priced plain barrel to super grade skeet and trap models.



**FLITE-KING**, 20 and .410 gauge, Pump Action Shotguns. All 20 gauge guns shoot both 2¾" and 3" magnum shot shells. The .410 model feeds both 2½" and 3" shot shells.



**SPORT-KING CARBINE**, .22 autoloading rifle, shoots 12 Long Rifle, 14 Longs, 17 Hi-Speed Shorts interchangeably without manual adjustment. Tubular magazine. Western style American walnut stock with swivels and adjustable sling-strap. Brass butt plate and golden trigger guard, trigger and safety. Receiver dovetailed for scope. Beaded-post front sight. Rocky Mountain Partridge with stepped blade at rear. Convenient manual thumb safety, right hand side. Overall length 38½". Weight about 5½ pounds.



**FLITE-KING**, 12 gauge, Brush guns in 20" or 26" barrel lengths. Guns shoot all 2¾" shot shells and rifled slugs. Cylinder bore. Rifle sights, front sight ramped, copper color bead; rear sight, square notch, adjustable.



**HI-POWER DELUXE**, Bolt Action rifle, .30-06 Springfield or .270 Win. chambering. Capacity: four in magazine and one in chamber. Select American walnut checkered, Monte Carlo stock. Receiver drilled and tapped for all popular top mount scopes and receiver sights. Swivels included. Overall length 42¾". Weight about 7 pounds.

FREE FOLDER ON REQUEST . . .

### THE HIGH STANDARD MANUFACTURING CORPORATION

HAMDEN, CONNECTICUT

WE MAINTAIN A SERVICE DEPARTMENT WHICH WILL PROMPTLY GIVE YOU ADVICE AND SERVICE.



# INSTRUCTIONS FOR OPERATION AND CARE OF YOUR DURA-MATIC PISTOL

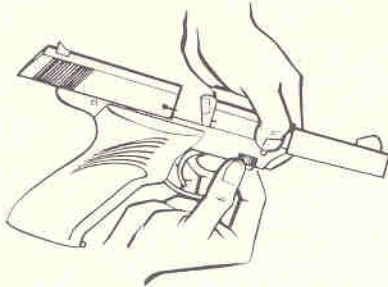

REMOVING BARREL

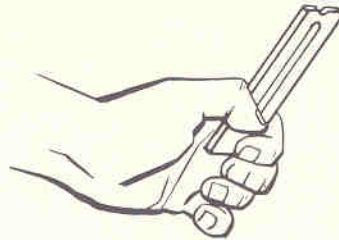

LOADING MAGAZINE

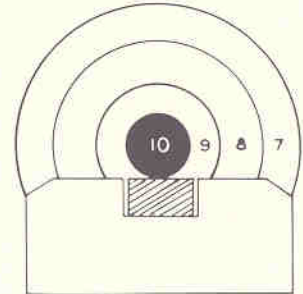

CORRECT SIGHT PICTURE

## DISASSEMBLY:

### NEVER ATTEMPT TO DISASSEMBLE BEFORE UNLOADING

1. Remove magazine by pressing magazine catch and allowing magazine to slide down and out of handle.
2. Pull slide to rear and lock open by moving safety to "on" position. (The safety acts also as a side lock, holding the slide in open position.)
3. **TO REMOVE BARREL ON MODEL-100:** Depress barrel lock plunger and unscrew barrel nut, allowing barrel to move up out of its seat in frame. **NOTE:** Slots in barrel nut permit use of coin to rigidly seat or unseat the nut.
4. **TO REMOVE BARREL ON MODEL-101:** Unscrew barrel nut, allowing barrel to move up out of its seat in frame. **NOTE:** Slots in barrel nut permit use of coin to rigidly seat or unseat the nut.  
**SAFETY:** Safety is in "ON" position when red paint on right side of safety button is not visible. (Safety locks Firing Pin Striker and Slide.)

## ASSEMBLY:

1. Replace slide spring in slide.
2. Replace striker and striker spring in slide. The striker spring rests inside the slide spring. Rotate striker so that flat on striker faces the slot in bottom of slide.
3. Replace slide on frame, lining up the grooves, and pull slide to rearmost position. Hold slide to rear and press safety "on," locking slide to rear.
4. Align barrel with the frame and tighten barrel nut.  
**NOTE:** Slots in barrel nut permit use of a coin to rigidly seat or unseat the nut.
5. Release slide by moving safety to "off" position. This will allow slide to move to battery position.
6. Replace magazine in grip and press until locked in place.

## LOADING AND FIRING:

1. Depress magazine catch, remove magazine and load it.
2. Replace magazine.
3. Pull slide to rear and release, allowing slide to move forward and strip a cartridge from magazine and feed it into the chamber. Gun is now ready to fire by pulling trigger. (This is a semi-automatic pistol and ten successive shots may be fired by simply pulling the trigger for each shot.)
4. Striker is also a visible indicator which shows unafailingly when pistol is cocked and ready to fire (see back end of slide).
5. If gun is not being fired, engage the safety. Always leave safety on until ready to fire. When engaged, the safety also locks the slide closed, making the arm safe to carry.

## SIGHT ADJUSTMENT:

Dura-Matic pistols are sighted in at approximately a 50-foot range. If lateral adjustment is desired because of individual preference in sighting or holding, tap the rear sight gently using a brass or plastic hammer. Move the rear sight in the direction you want the point of impact to move.

## DRY FIRING:

In dummy firing the pistol in practice, it is best to first insert a dummy shell or fired case into the chamber. This will prevent possible damage to the firing pin and the barrel.