

**WARNING: READ THIS OWNERS MANUAL BEFORE USING THIS REVOLVER. THERE ARE IMPORTANT SAFETY INSTRUCTIONS AND WARNINGS WHICH MUST BE UNDERSTOOD AND USED TO AVOID INJURY AND OR DEATH.**

**LEAD WARNING:** Discharging firearms in poorly ventilated areas, cleaning firearms or handling ammunition may result in exposure to lead and other substances known to cause birth defects, reproductive harm, and other serious physical injury. Have adequate ventilation at all times. Wash hands thoroughly after exposure.

## **ROUGH RIDER SINGLE ACTION REVOLVERS**

### **Specifications:**

**Caliber:** 17 HMR, 22LR, Long, Short, CB, Shot & 22WRM (mag)

**Barrel:** 3½", 4¾", 6½" or 9"

**Weight:** 34 Ounces

**Finish:** Blue or Satin

**Action:** Single Action

**Capacity:** 6 Shot Cylinder

**Grips:** Exotic Laminate Hardwoods or  
Mother of Pearl

**Sights:** Open Type

**Features:** Manual Hammer Block

**Made in U.S.A.**



We recommend that you seek instruction in safe firearm handling by a competent firearms instructor. Remember there is no substitute for safe handling. Safety devices are merely tools that in some instances can be manipulated to fail and therefore to rely solely on mechanical devices is to be only half safe.

### **Your Owners Manual**

This manual contains important warnings which must be understood BEFORE using this firearm. Always keep it with the firearm. When you lend, give or sell this firearm, be sure the manual goes with it. You can get extra copies of this manual from Heritage Manufacturing on request.

# 1 USING THE HAMMER BLOCK

- Point the revolver in a safe direction.
- Pull the hammer back to the second notch or click.
- Turn hammer block up as shown.
- Always keep the hammer block in the up position, except when actually firing.



# 2 UNLOADING/ LOADING

- Put the hammer block in the up position.
- Point the revolver in a safe direction.
- Pull the hammer back to the second notch or click and the cylinder will turn freely.
- Open the loading gate to expose the chambers.
- Line up the chamber with the ejector rod, and push out the cartridge. Line up the next chamber and repeat this until all chambers are unloaded. Be sure to double check that all chambers are empty.
- To load: Insert one cartridge in each chamber until the cylinder is loaded and close the loading gate.

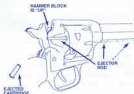

**WARNING:** Do not Carry this revolver with a live round chambered under the hammer and firing pin. Keeping an empty chamber under the hammer with the hammer block in the up position is good insurance against accidental firing.

# 3 FIRING

- Keep the hammer block in the up position.
- Keep your finger out of the trigger guard until you are ready to fire.
- Point the revolver at the target and be sure of what lies behind it.
- Pull the hammer all the way back with a smooth stroke.
- Push the hammer block down to disengage it.
- Put your finger inside the trigger guard and slowly squeeze while you line up the sights on the target.



**WARNING:** Quick draw and or fanning the hammer are dangerous and abusive to your revolver. Never quick draw a loaded revolver. Fanning and quick drawing will void your manufactures warranty.

**DRY FIRE:** Please be sure not to "dry fire" the revolver. If you cock the hammer, pull the trigger when there are no shells in the chamber and the hammer block is not in the "up" position, the hammer will strike the firing pin causing the firing pin to hit the cylinder. When this firing pin hits the cylinder and there is no ammunition in the revolver the cylinder will become damaged, dented and will void the manufacturers warranty.

**SIDE BLAST:** All revolvers have a side blast of cylinder gas. As hot gases push the bullet down the barrel, gas will escape from the gap between the barrel and the cylinder. Be sure that on-lookers are behind you.



**WARNING:** Keep people behind and away from you and keep your hands and body clear of the sides of the revolver when firing. Always wear safety glasses when firing this or any other firearm.

**WARNING:** Exposure to firing without ear protection will lead to hearing loss. Always be sure to wear ear plugs or ear phones when firing. Ask your local dealer to show you what is available to protect your ears from hearing loss.

# 4 CHANGING CYLINDERS

- Keep the hammer block in the up position.
- Pull the hammer back to the second notch or click.
- Check every chamber to be sure it is empty, never change cylinders that are loaded.
- Press the base pin lock nut while pulling the base pin out of the frame.



- Before loading, test the base pin engagement by pulling it forward without pressing in the base pin lock nut. If installed properly you should not be able to pull it out.
- The following ammunition can be fired in the Long Rifle Cylinder: 22LR, LONG, SHORT, CB & SHOT.
- Only 22 Magnum ammo can be fired in the 22 Magnum Cylinder.
- Only 17 Magnum ammo can be fired in the 17 Magnum Cylinder.

**WARNING: Never remove or install a loaded cylinder. If dropped or struck by a hard surface it is possible for the ammunition to fire.**

# 5 CLEANING AND MAINTENANCE

After each firing be sure you unload your Rough Rider and clean it thoroughly.

1. Remove the cylinder, no further disassembly is recommended. This will allow easy access to the firing pin, breech, and the barrel.
2. Using a cleaning brush and bore solvent thoroughly clean and scrub the barrel and chambers. A toothbrush with bore solvent can be used to clean the firing pin area.
3. Using a cleaning rod, thoroughly wipe off any excess bore solvent. Remember that bore solvent is caustic and can remove the finish so wipe off and dry any areas exposed to the solvent.
4. With a clean cotton patch soaked in gun oil be sure to coat the inside of the barrel & chambers with a fine film of oil to prevent rust.
5. The exterior of the revolver should be wiped down with a clean cotton cloth and then a light film of oil should be applied. Be sure to use a light film as too much oil will attract dirt and dust.
6. Store your revolver in a cool dry area and always be sure to secure the revolver out of the reach of children.

# COMMANDMENTS OF SAFETY

- Never point a firearm at anything you don't intend to shoot.
- Never accept a firearm without opening it yourself to check to see if it is loaded.
- Always keep the action open after firing.
- Carry loaded revolvers and pistols with empty chambers under the hammer.
- Always empty handguns before carrying into a home, car, boat or RV.
- Always be sure of what lies behind your intended target.
- Always seek instruction in handgun safety from a qualified instructor or see your dealer.
- Always keep firearms out of the reach of children. Keep guns and ammo separate.
- Always check the barrel of your firearm to be sure it is clear of obstructions.
- Never mix alcohol or drugs with the shooting sports. Be a sober shooter.
- If the gun fails to fire when the trigger is pulled, keep it pointed in a safe direction while unloading.
- Always carry and store your gun in a proper holster and or carrying case. This protects the firearm from damage.
- Never leave a loaded firearm unattended.
- Always be sure your ammunition is the proper caliber for the firearm you are using. Do not use reload or any questionable ammunition.
- Place a gun lock on your firearm when storing it
- Never place a gun lock on a loaded firearm
- Locking your firearm might result in your death due to slow accessibility

# ONE YEAR LIMITED WARRANTY

All Heritage Manufacturing Firearms are warranted to the original retail customer for one year from date of purchase against defects in material and workmanship. All parts and labor or replacement (at our option) are covered. You must send in your factory registration card to obtain warranty coverage.

Transportation to and from our warranty service center, damage caused by failure to perform normal maintenance, sales outside the United States, damage due to the use of high pressure, reloaded or other nonstandard ammunition, or an unauthorized repair, modification, misuse, abuse, including abuse by "fanning" the hammer, or alteration of the product is not covered by this limited warranty. Any implied warranties, including the implied warranties of merchantability and fitness for a particular purpose, are limited to one year from date of original retail purchase. Consequential or incidental damages or expenses, or any other expenses are not covered by this warranty.

To obtain warranty performance and service, send your product with proof of retail purchase, freight prepaid to:



Heritage Manufacturing, Inc.  
Attention Warranty Service Center  
4600 N.W. 135th Street  
Opa Locka, FL 33054

Any questions relating to warranty service should be directed to us at the following number: (305) 685-5966 or [www.heritagemfg.com](http://www.heritagemfg.com)

# PARTS LIST

3.1 Trigger 1/8" wide	\$ 7.00	9.3 Loading Gate Detent	3.00
3.1 Trigger 1/4"	12.00	10.1 Ejec/Rod & Lever 2 & 3"	\$ 6.00
3.2 Trigger Screw	3.00	10.2 Ejec/Rod & Lever 4.75-9"	6.00
3.3 Trigger Spring	5.00	10.3 Ejec/Tube 2 & 3"	9.00
3.4 Trigger Spring Screw	3.00	10.4 Ejec/Tube 4.75-9"	9.00
4.1 Hammer Block	10.00	10.5 Ejec/Spring 2 & 3"	6.00
4.2 Hammer Block Spring	3.00	10.6 Ejector Spring 4.75-9"	6.00
4.3 Hammer Block Detent	2.00	10.7 Ejector Tube Screw	3.00
4.4 Hammer	15.00	11.1 Base Pin	8.00
4.5 Hammer Screw	3.00	11.2 Base Pin Lock Spring	2.00
4.6 Hammer Spring	5.00	11.3 Base Pin Lock Nut	4.00
5.1 Cylinder Hand	8.00	11.4 Base Pin Lock Screw	4.00
5.2 Cylinder Bolt	6.00	12.1 Grips-Wood Regular	16.00
6.1 Cylinder 22 LR	30.00	12.2 Grips-Wood Bird Head	16.00
6.2 Cylinder 22 WMR	30.00	12.3 Grips-	
7.1 Firing Pin	6.00	Mother of Pearl-Regular	30.00
7.2 Firing Pin Spring	2.00	12.4 Grips-	
7.3 Firing Pin Cup	5.00	Mother of Pearl-Bird Head	30.00
7.4 Firing Pin Pin	3.00	13.1 Grip Screw	3.00
8.0 Front Sight	5.00	13.2 Grip Pin	3.00
8.1 Front Red Ramp Sight	7.00	14.1 Back Strap Screws (4)	5.00
8.2 Rear Adj. Sight	18.00	14.2 Back Strap-Front Screw	3.00
Adj. Sight Elevation Screw	6.00	14.3 Back Strap-Regular	
Adj. Sight Spring	2.00	for 1/8" & 1/4" trigger	25.00
9.1 Loading Gate	10.00	14.4 Back Strap-Bird Head	
9.2 Loading Gate Spring	2.00	for 1/8" & 1/4" trigger	25.00

PLEASE SEND \$5.00 SHIPPING AND HANDLING FOR YOUR GUN LOCK

PLEASE SPECIFY BLUE OR SATIN ON YOUR PARTS ORDER

Please Include \$5.00 per order for shipping. All orders must be prepaid by money order or credit card or Via Internet.

**WARNING: This revolver was manufactured to perform properly with the original parts as designed. It is your duty to make sure any parts you purchase are installed correctly and that neither replacements nor originals are altered or changed. Your gun is a complex tool with many parts that must relate correctly to other parts. Putting a firearm together wrong or with altered parts can result in a damaged gun, injury or death. Do not attempt to work on it yourself. This is a small price to pay for your safety.**

Prices are subject to change without notice.

# EXPLODED VIEW DRAWING

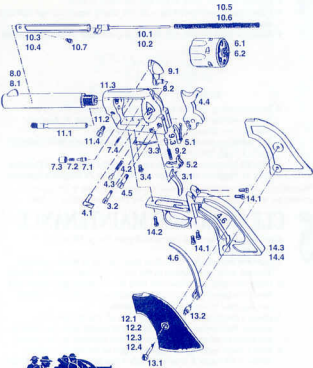

Heritage Manufacturing, Inc.