

SECTION **RSU**
 REAR SUSPENSION

A
 B
 C
 D

RSU

CONTENTS

| | | | | |
|---|---|--|----|---|
| PRECAUTION | 2 | ON-VEHICLE REPAIR | 6 | F |
| PRECAUTIONS | 2 | REAR SUSPENSION ASSEMBLY | 6 | G |
| Precaution | 2 | Component | 6 | |
| PREPARATION | 3 | LEAF SPRING | 8 | H |
| PREPARATION | 3 | Removal and Installation | 8 | |
| Commercial Service Tool | 3 | SHOCK ABSORBER | 10 | I |
| SYMPTOM DIAGNOSIS | 4 | Removal and Installation | 10 | |
| NOISE VIBRATION AND HARSHNESS | | SERVICE DATA AND SPECIFICATIONS | | J |
| (NVH) TROUBLESHOOTING | 4 | (SDS) | 11 | |
| NVH Troubleshooting Chart | 4 | SERVICE DATA AND SPECIFICATIONS | | K |
| ON-VEHICLE MAINTENANCE | 5 | (SDS) | 11 | |
| REAR SUSPENSION ASSEMBLY | 5 | General Specification (Rear) | 11 | L |
| On-Vehicle Inspection and Service | 5 | Wheelarch Height (Unladen*1) | 11 | M |
| | | | | N |
| | | | | O |
| | | | | P |

PRECAUTIONS

< PRECAUTION >

PRECAUTION

PRECAUTIONS

Precaution

INFOID:000000003790497

- **When installing rubber parts, final tightening must be carried out under unladen condition* with tires on ground.**
 - * Fuel, radiator coolant, and engine oil are full. Spare tire, jack, hand tools, and mats are in their designated positions.

PREPARATION

< PREPARATION >

PREPARATION

PREPARATION

Commercial Service Tool

INFOID:000000003790498

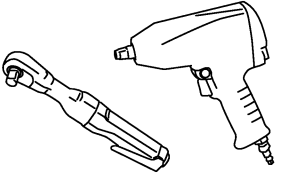
| Tool name | Description |
|--|--|
| <p data-bbox="162 413 272 441">Power tool</p>  <p data-bbox="852 632 922 646">PBIC0190E</p> | <p data-bbox="1015 413 1263 441">Removing nuts and bolts</p> |

A

B

C

D

RSU

F

G

H

I

J

K

L

M

N

O

P

NOISE VIBRATION AND HARSHNESS (NVH) TROUBLESHOOTING

< SYMPTOM DIAGNOSIS >

SYMPTOM DIAGNOSIS

NOISE VIBRATION AND HARSHNESS (NVH) TROUBLESHOOTING

NVH Troubleshooting Chart

INFOID:000000003790499

Use the chart below to help you find the cause of the symptom. If necessary, repair or replace the parts.

| Symptoms | Possible cause and SUSPECTED PARTS | | | | | | | Reference page | | | | | |
|-------------------------------|------------------------------------|--|-----------------------------------|--------------------|----------------|----------------------|--|--|--------------------------------------|------------------------------------|------------------------------------|------------------------------------|-----------------------------------|
| | Improper installation, looseness | Shock absorber deformation, damage or deflection | Bushing or mounting deterioration | Parts interference | Spring fatigue | Suspension looseness | | DLN-126 (2F1310), DLN-134 (2S1410), DLN-143 (3S1410) | DLN-187, "NVH Troubleshooting Chart" | RAX-4, "NVH Troubleshooting Chart" | FSU-4, "NVH Troubleshooting Chart" | FSU-4, "NVH Troubleshooting Chart" | BR-5, "NVH Troubleshooting Chart" |
| Noise | x | x | x | x | x | x | | x | x | x | x | x | x |
| Shake | x | x | x | x | | x | | x | | x | x | x | x |
| Vibration | x | x | x | x | x | | | x | | x | x | | x |
| Shimmy | x | x | x | x | | | | | | x | x | x | x |
| Shudder | x | x | x | | | | | | | x | x | x | x |
| Poor quality ride or handling | x | x | x | x | x | x | | | | x | x | x | |

x: Applicable

REAR SUSPENSION ASSEMBLY

< ON-VEHICLE MAINTENANCE >

ON-VEHICLE MAINTENANCE

REAR SUSPENSION ASSEMBLY

On-Vehicle Inspection and Service

INFOID:000000003790500

- Check the rear suspension parts for any excessive play, cracks, wear, and other damage.
- Shake each rear wheel to check for any excessive play as shown.
- Tighten all of the nuts and bolts to the specified torque. Refer to [RSU-6, "Component"](#).

CAUTION:

When installing the components with rubber bushings, the final tightening of the nuts and bolts must be done with the vehicle in an unladen condition (the fuel, engine coolant, and engine oil full; the spare tire, jack, hand tools and mats in their designated positions) with the tires on the ground.

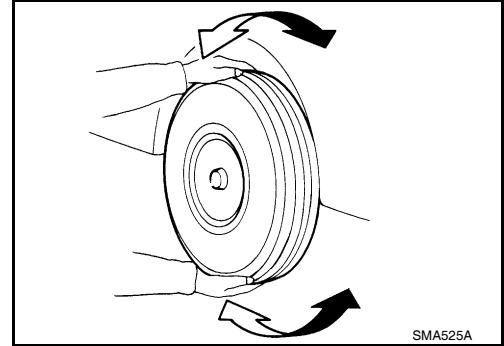

- Check the shock absorbers for oil leaks, deformation, and other damage.
- Check the shock absorber bushings for excessive wear and other damage.

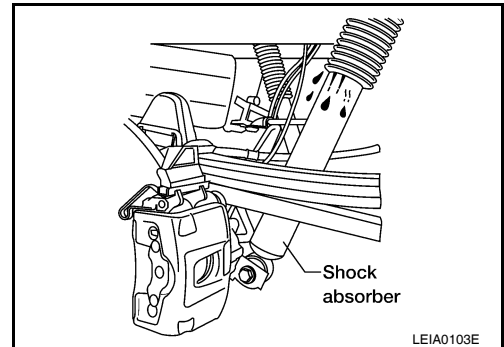

A
B
C
D
RSU
F
G
H
I
J
K
L
M
N
O
P

REAR SUSPENSION ASSEMBLY

< ON-VEHICLE REPAIR >

ON-VEHICLE REPAIR

REAR SUSPENSION ASSEMBLY

Component

INFOID:000000003790501

SEC. 431

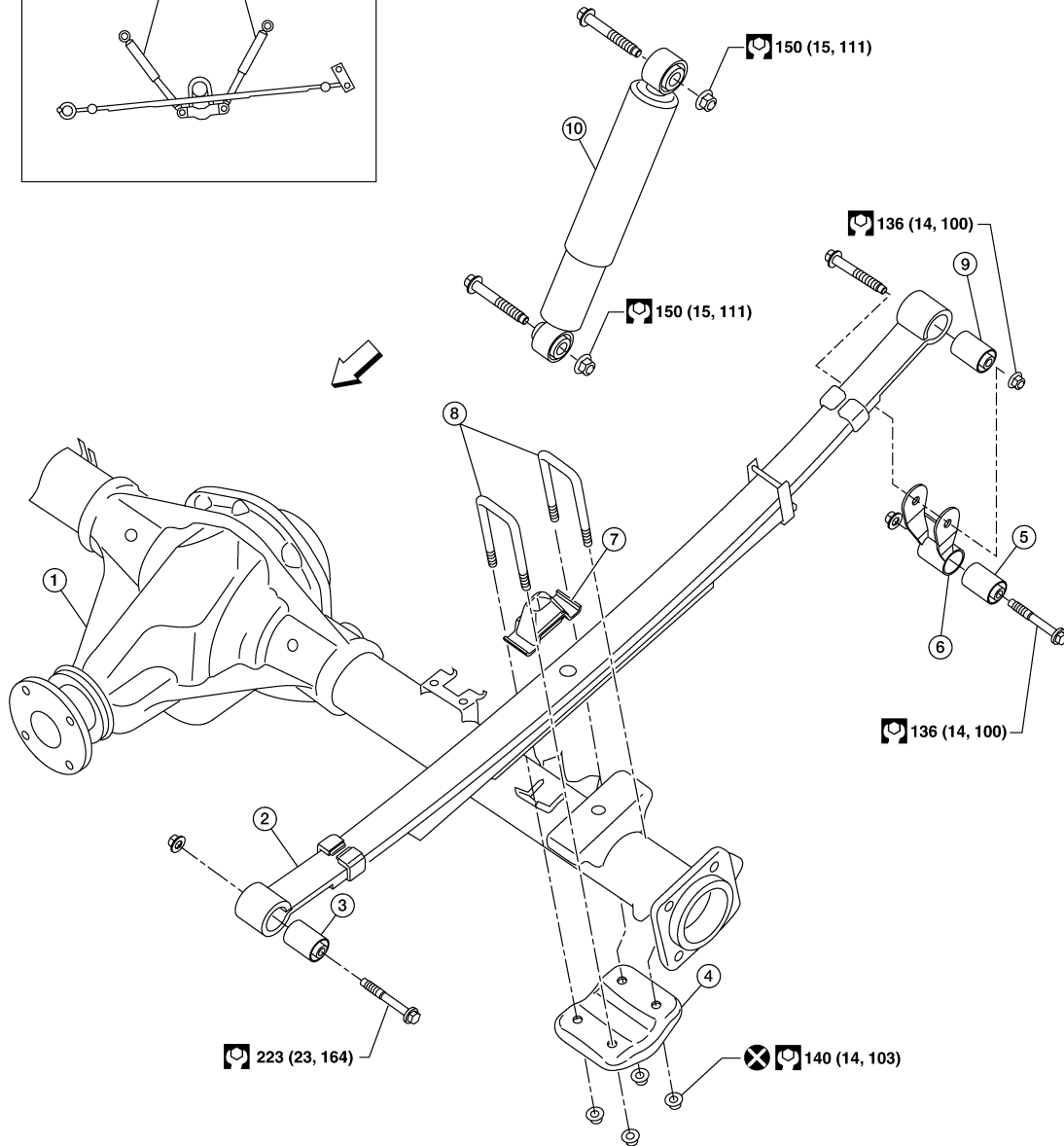
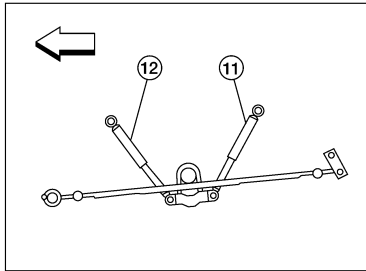

AWEIA0071GB

- | | | |
|---------------------|--------------------------------|---------------------------------|
| 1. Rear final drive | 2. Rear leaf spring | 3. Rear spring bushing (front) |
| 4. Rear spring pad | 5. Rear spring shackle bushing | 6. Rear spring shackle |
| 7. Bumper | 8. Rear spring clip U-bolts | 9. Rear spring bushing (rear) |
| 10. Shock absorber | 11. Shock absorber (left side) | 12. Shock absorber (right side) |
| ← Front | | |

RSU-6

REAR SUSPENSION ASSEMBLY

< ON-VEHICLE REPAIR >

CAUTION:

When installing the components with rubber bushings, the final tightening of the nuts and bolts must be done with the vehicle in an unladen condition (the fuel, engine coolant, and engine oil full; the spare tire, jack, hand tools and mats in their designated positions) with the tires on the ground.

A

B

C

D

RSU

F

G

H

I

J

K

L

M

N

O

P

LEAF SPRING

< ON-VEHICLE REPAIR >

LEAF SPRING

Removal and Installation

INFOID:000000003790502

CAUTION:

When installing the components with rubber bushings, the final nut tightening must be carried out under unladen* conditions with the tires on level ground.

* (Fuel, radiator coolant and engine oil full. Spare tire, jack, hand tools and mats in designated positions.)

REMOVAL

1. Support the rear final drive assembly with a suitable jack to relieve the tension from the leaf spring.
 - The axle weight should be supported, but there should be no compression in the spring.
2. Remove the shock absorber lower nut and bolt using power tool.

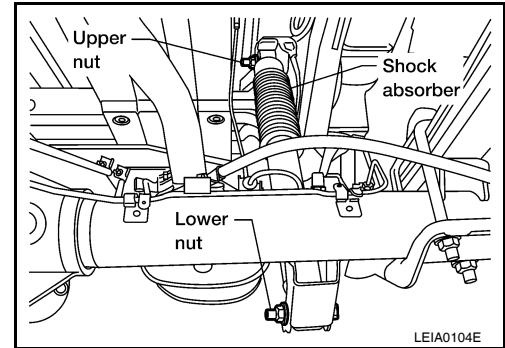

3. Remove the four rear spring clip U-bolt nuts using power tool, then remove the rear spring pad.

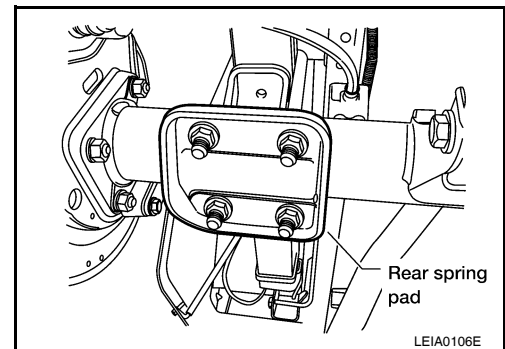

4. Remove the rear spring shackle lower nut and bolt using power tool.
 - If removing the LH rear leaf spring, remove the storage box if equipped, to access the rear spring shackle lower nut and bolt. Refer to [EXT-33. "Removal and Installation"](#).

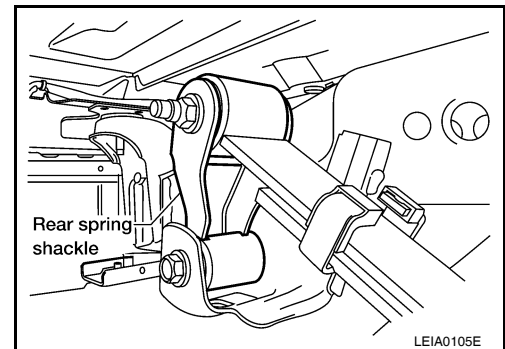

LEAF SPRING

< ON-VEHICLE REPAIR >

5. Remove the rear leaf spring front nut and bolt using power tool.
6. Remove the rear leaf spring.
7. Remove the rear spring shackle from the rear leaf spring as necessary, using power tool.

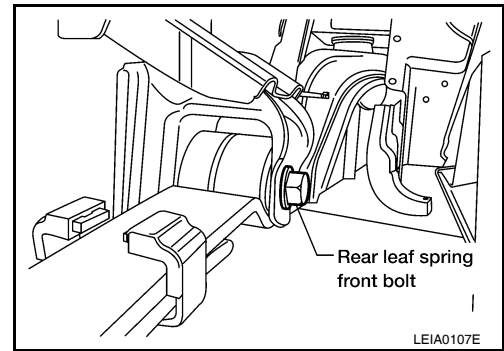

INSPECTION AFTER REMOVAL

- Check the rear leaf spring for any cracks or damage. Replace the rear leaf spring if necessary.
- Check the rear spring shackle, rear spring clip U-bolts, bumper, and rear spring pad for excessive wear, cracks, straightness, and damage. Replace any components if necessary.
- Check all bushings for deformation and cracks. Replace any bushings if necessary.

INSTALLATION

1. Apply soapsuds to all of the rubber bushings.
2. Install the rear spring shackle and rear leaf spring front nut and bolt. Finger-tighten the nuts.
3. Install the rear spring clip U-bolts and bumper on top of the rear leaf spring.
4. Install the rear spring pad, and new rear spring clip U-bolt nuts under the rear final drive axle case.

CAUTION:

Use new rear spring clip U-bolt nuts for installation.

5. Tighten the rear spring clip U-bolt nuts diagonally and evenly using the following sequence:
 - a. Tighten the rear spring clip U-bolt nuts until the rear spring pad contacts the rear final drive axle case.
 - b. Tighten the rear spring clip U-bolt nuts diagonally and evenly to 50 N·m (5.1 kg-m, 37 ft-lb).
 - c. Tighten the rear spring clip U-bolt nuts to specification so the lengths of all the exposed rear spring clip U-bolt threads under the rear spring pad are equal in length as shown.

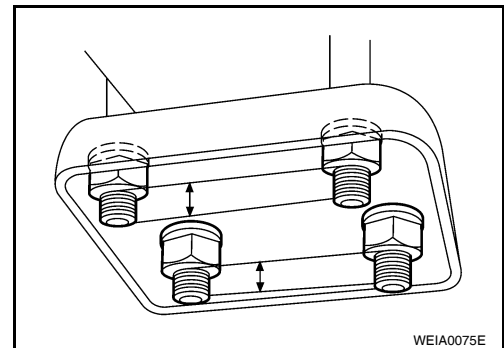

6. Install the shock absorber, and finger-tighten the nuts.
7. Remove the jack supporting the rear final drive assembly and bounce the rear of the vehicle to stabilize the suspension. (unladen)

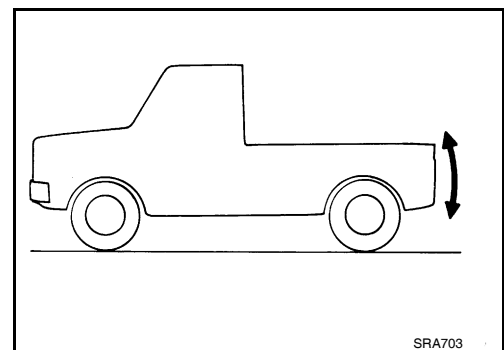

8. Tighten the rear spring shackle nuts, rear leaf spring front nut and shock absorber nuts to specification. Refer to [RSU-6. "Component"](#).

CAUTION:

When installing the components with rubber bushings, the final nut tightening must be carried out under unladen* conditions with the tires on level ground.

*** (Fuel, radiator coolant and engine oil full. Spare tire, jack, hand tools and mats in designated positions.)**

SHOCK ABSORBER

< ON-VEHICLE REPAIR >

SHOCK ABSORBER

Removal and Installation

INFOID:000000003790503

REMOVAL

1. Support the rear final drive and suspension assembly using a suitable jack.
2. Remove the shock absorber upper and lower nuts and bolts using power tool.
3. Remove the shock absorber.

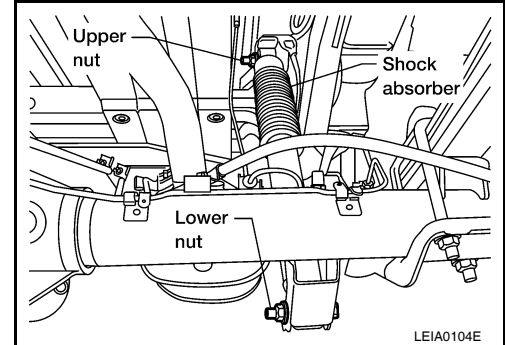

INSPECTION AFTER REMOVAL

Inspect the shock absorber for any oil leaks, cracks, or deformations. Replace the shock absorber as necessary.

INSTALLATION

Installation is in the reverse order of removal.

Shock absorber upper and lower nuts : Refer to [RSU-6, "Component"](#).

SERVICE DATA AND SPECIFICATIONS (SDS)

< SERVICE DATA AND SPECIFICATIONS (SDS)

SERVICE DATA AND SPECIFICATIONS (SDS)

SERVICE DATA AND SPECIFICATIONS (SDS)

General Specification (Rear)

INFOID:000000003790504

| | |
|---------------------|---|
| Suspension type | Rigid axle with semi-elliptic leaf spring |
| Shock absorber type | Double-acting hydraulic |

Wheelarch Height (Unladen*1)

INFOID:000000003790505

Unit: mm (in)

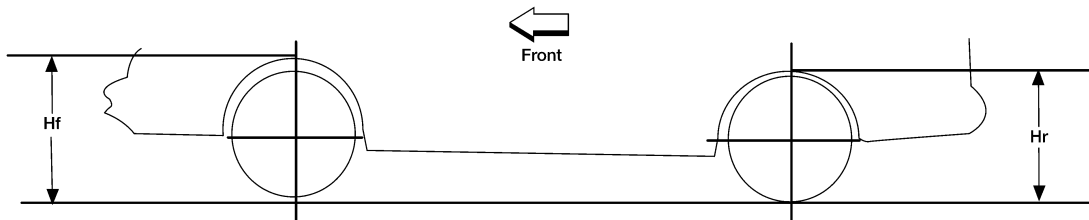

LEIA0085E

| Drive type | 2WD | | | | 4WD*2 | | | | 4WD*3 | | | | |
|------------------------------|------------|-------------|-------------|-------------|-------------|--------------|--------------|--------------|--------------|--------------|--------------|--------------|--------------|
| | Short | | Long | | Short | | Long | | Short | | Long | | |
| Wheel base | King Cab | | Crew Cab | | King Cab | | Crew Cab | | King Cab | | Crew Cab | | |
| Body | King Cab | Crew Cab | King Cab | Crew Cab | King Cab | Crew Cab | King Cab | Crew Cab | King Cab | Crew Cab | King Cab | Crew Cab | |
| Front wheel arch height (Hf) | P265/70R18 | 912 (35.91) | 914 (35.98) | 912 (35.91) | 914 (35.98) | 949 (37.36) | 951 (37.44) | 949 (37.36) | 951 (37.44) | 949 (37.36) | 951 (37.44) | 949 (37.36) | 951 (37.44) |
| | P275/70R18 | 922 (36.30) | 925 (36.42) | 922 (36.30) | 925 (36.42) | 960 (37.80) | 962 (37.87) | 959 (37.76) | 962 (37.87) | 960 (37.80) | 962 (37.87) | 959 (37.76) | 962 (37.87) |
| | P275/60R20 | 917 (36.10) | 919 (36.18) | 917 (36.10) | 920 (36.22) | 955 (37.60) | 957 (37.68) | 954 (37.56) | 957 (37.68) | 955 (37.60) | 957 (37.68) | 954 (37.56) | 957 (37.68) |
| Rear wheel arch height (Hr) | P265/70R18 | 952 (37.48) | 954 (37.56) | 950 (37.40) | 951 (37.44) | 991 (39.02) | 994 (39.13) | 989 (38.94) | 991 (39.02) | 991 (39.02) | 993 (39.09) | 989 (38.94) | 991 (39.02) |
| | P275/70R18 | 962 (37.87) | 965 (37.99) | 960 (37.80) | 962 (37.87) | 1002 (39.45) | 1004 (39.53) | 1000 (39.37) | 1002 (39.45) | 1001 (39.41) | 1004 (39.53) | 1000 (39.37) | 1002 (39.45) |
| | P275/60R20 | 957 (37.68) | 959 (37.76) | 955 (37.60) | 956 (37.64) | 996 (39.21) | 999 (39.33) | 995 (39.17) | 996 (39.21) | 996 (39.21) | 998 (39.29) | 995 (39.17) | 996 (39.21) |

*1: Fuel, radiator coolant and engine oil full. Spare tire, jack, hand tools and mats in designated positions.

*2: Without tow package.

*3: With tow package.