

A
B
C
D
E
F
G
H
I
J
K
L
M
N
O
P

SECTION **VTL**

VENTILATION SYSTEM

CONTENTS

<p>FUNCTION DIAGNOSIS 3</p> <p>SWITCHES AND THEIR CONTROL FUNCTION 3</p> <p style="padding-left: 20px;">System Description3</p> <p>AIR DISTRIBUTION 4</p> <p style="padding-left: 20px;">System Description4</p> <p>PRECAUTION 5</p> <p>PRECAUTIONS 5</p> <p>FOR USA AND CANADA5</p> <p style="padding-left: 20px;">FOR USA AND CANADA : Precaution for Supplemental Restraint System (SRS) "AIR BAG" and "SEAT BELT PRE-TENSIONER"5</p> <p style="padding-left: 20px;">FOR USA AND CANADA : Precaution Necessary for Steering Wheel Rotation After Battery Disconnect5</p> <p>FOR MEXICO5</p> <p style="padding-left: 20px;">FOR MEXICO : Precaution for Supplemental Restraint System (SRS) "AIR BAG" and "SEAT BELT PRE-TENSIONER"5</p> <p style="padding-left: 20px;">FOR MEXICO : Precaution Necessary for Steering Wheel Rotation After Battery Disconnect6</p> <p>PREPARATION 7</p> <p>PREPARATION 7</p> <p style="padding-left: 20px;">Commercial Service Tool7</p> <p>ON-VEHICLE MAINTENANCE 8</p> <p>IN-CABIN MICROFILTER 8</p> <p style="padding-left: 20px;">Exploded View8</p> <p style="padding-left: 20px;">Removal and Installation8</p> <p style="padding-left: 20px;">Replacement8</p> <p>ON-VEHICLE REPAIR 9</p> <p>DUCT AND GRILLE 9</p>	<p style="padding-left: 20px;">Exploded View 9</p> <p>CENTER VENTILATOR GRILLE10</p> <p style="padding-left: 20px;">CENTER VENTILATOR GRILLE : Removal and Installation10</p> <p>CENTER VENTILATOR DUCT10</p> <p style="padding-left: 20px;">CENTER VENTILATOR DUCT : Removal and Installation11</p> <p>SIDE VENTILATOR GRILLE11</p> <p style="padding-left: 20px;">SIDE VENTILATOR GRILLE : Removal and Installation11</p> <p>SIDE VENTILATOR DUCT11</p> <p style="padding-left: 20px;">SIDE VENTILATOR DUCT : Removal and Installation11</p> <p>SIDE DEFROSTER GRILLE12</p> <p style="padding-left: 20px;">SIDE DEFROSTER GRILLE : Removal and Installation12</p> <p>SIDE DEFROSTER DUCT12</p> <p style="padding-left: 20px;">SIDE DEFROSTER DUCT : Removal and Installation12</p> <p>FRONT DEFROSTER GRILLE13</p> <p style="padding-left: 20px;">FRONT DEFROSTER GRILLE : Removal and Installation13</p> <p>FRONT FOOT DUCT13</p> <p style="padding-left: 20px;">FRONT FOOT DUCT : Removal and Installation....13</p> <p>REAR FOOT DUCT 114</p> <p style="padding-left: 20px;">REAR FOOT DUCT 1 : Removal and Installation....14</p> <p>REAR FOOT DUCT 214</p> <p style="padding-left: 20px;">REAR FOOT DUCT 2 : Removal and Installation....14</p> <p>REAR FOOT DUCT 314</p> <p style="padding-left: 20px;">REAR FOOT DUCT 3 : Removal and Installation....14</p> <p>BLOWER MOTOR15</p> <p style="padding-left: 20px;">Exploded View15</p>
---	--

VTL

Removal and Installation	15	Exploded View	16
FAN CONTROL AMPLIFIER	16	Removal and Installation	16

SWITCHES AND THEIR CONTROL FUNCTION

< FUNCTION DIAGNOSIS >

FUNCTION DIAGNOSIS

SWITCHES AND THEIR CONTROL FUNCTION

System Description

INFOID:000000004380421

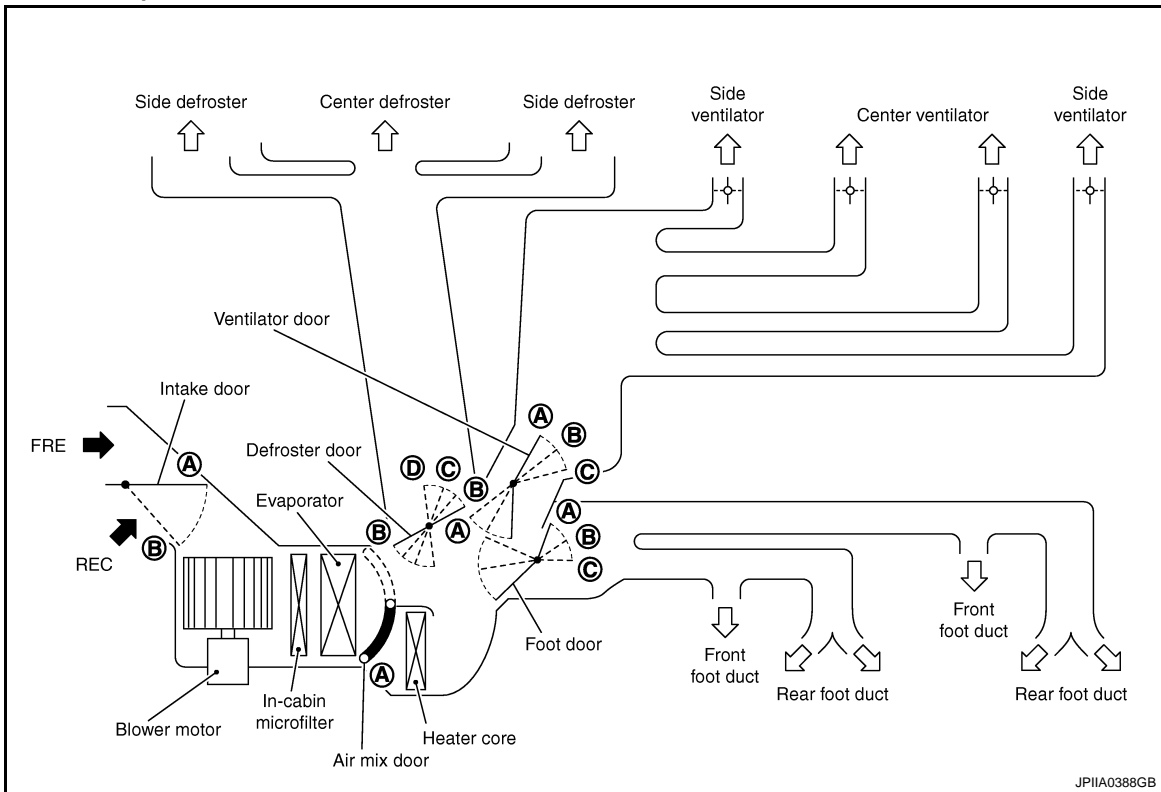

JP11A0388GB

NOTE:

Ventilator door has center ventilator openings and side ventilator openings, side ventilator opening cannot be completely closed.

Door	Position or switch	Mode control dial							Intake switch		Temperature control dial		
		MAX A/C	VENT	B/L	FOOT	FOOT2	D/F	D/F2	DEF	ON	OFF	Full cold ↔ Full hot	
		MAX A/C				—		—					
Ventilator door	(A)	(A)	(B)	(C)	(C)	(C)	(C)	(C)	—	—	—		
Foot door	(A)	(A)	(B)	(C)	(C)	(B)	(B)	(A)	—	—	—		
Defroster door	(A)	(A)	(A)	(B)	(B-C)	(C)	(C-D)	(D)	—	—	—		
Intake door	(A)	—							(B)	(A)	(B)	—	
Air mix door	—								—		(A)	—	(B)

JP11A0390GB

AIR DISTRIBUTION





< FUNCTION DIAGNOSIS >

AIR DISTRIBUTION

System Description





INFOID:000000004380422

WITHOUT REAR FOOT DUCT

Discharge air flow			
Mode door position	Air outlet/distribution		
	VENT	FOOT	DEF
	100%	—	—
	63%	37%	—
	13%	63%	24%
	12%	41%	47%
	18%	—	82%

JPIIA0387GB

WITH REAR FOOT DUCT

Discharge air flow				
Mode door position	Air outlet/distribution			
	VENT	FOOT		DEF
		Front	Rear	
	100%	—	—	—
	60%	26%	14%	—
	13%	42%	24%	21%
	12%	28%	16%	44%
	18%	—	—	82%

JPIIA0386GB

PRECAUTIONS

< PRECAUTION >

PRECAUTION

PRECAUTIONS FOR USA AND CANADA

FOR USA AND CANADA : Precaution for Supplemental Restraint System (SRS) "AIR BAG" and "SEAT BELT PRE-TENSIONER"

INFOID:000000004409834

The Supplemental Restraint System such as "AIR BAG" and "SEAT BELT PRE-TENSIONER", used along with a front seat belt, helps to reduce the risk or severity of injury to the driver and front passenger for certain types of collision. This system includes seat belt switch inputs and dual stage front air bag modules. The SRS system uses the seat belt switches to determine the front air bag deployment, and may only deploy one front air bag, depending on the severity of a collision and whether the front occupants are belted or unbelted. Information necessary to service the system safely is included in the "SRS AIRBAG" and "SEAT BELT" of this Service Manual.

WARNING:

- **To avoid rendering the SRS inoperative, which could increase the risk of personal injury or death in the event of a collision which would result in air bag inflation, all maintenance must be performed by an authorized NISSAN/INFINITI dealer.**
- **Improper maintenance, including incorrect removal and installation of the SRS, can lead to personal injury caused by unintentional activation of the system. For removal of Spiral Cable and Air Bag Module, see the "SRS AIRBAG".**
- **Never use electrical test equipment on any circuit related to the SRS unless instructed to in this Service Manual. SRS wiring harnesses can be identified by yellow and/or orange harnesses or harness connectors.**

FOR USA AND CANADA : Precaution Necessary for Steering Wheel Rotation After Battery Disconnect

INFOID:000000004409882

NOTE:

- This Procedure is applied only to models with Intelligent Key system and NVIS/IVIS (NISSAN/INFINITI VEHICLE IMMOBILIZER SYSTEM - NATS).
- Remove and install all control units after disconnecting both battery cables with the ignition knob in the "LOCK" position.
- Always use CONSULT-III to perform self-diagnosis as a part of each function inspection after finishing work. If DTC is detected, perform trouble diagnosis according to self-diagnostic results.

For models equipped with the Intelligent Key system and NVIS/IVIS, an electrically controlled steering lock mechanism is adopted on the key cylinder.

For this reason, if the battery is disconnected or if the battery is discharged, the steering wheel will lock and steering wheel rotation will become impossible.

If steering wheel rotation is required when battery power is interrupted, follow the procedure below before starting the repair operation.

OPERATION PROCEDURE

1. Connect both battery cables.

NOTE:

Supply power using jumper cables if battery is discharged.

2. Use the Intelligent Key or mechanical key to turn the ignition switch to the "ACC" position. At this time, the steering lock will be released.
3. Disconnect both battery cables. The steering lock will remain released and the steering wheel can be rotated.
4. Perform the necessary repair operation.
5. When the repair work is completed, return the ignition switch to the "LOCK" position before connecting the battery cables. (At this time, the steering lock mechanism will engage.)
6. Perform a self-diagnosis check of all control units using CONSULT-III.

FOR MEXICO

FOR MEXICO : Precaution for Supplemental Restraint System (SRS) "AIR BAG" and

A
B
C
D
E
F
G
H

VTL

J
K
L
M
N
O
P

PRECAUTIONS

< PRECAUTION >

"SEAT BELT PRE-TENSIONER"

INFOID:000000004409835

The Supplemental Restraint System such as "AIR BAG" and "SEAT BELT PRE-TENSIONER", used along with a front seat belt, helps to reduce the risk or severity of injury to the driver and front passenger for certain types of collision. Information necessary to service the system safely is included in the "SRS AIRBAG" and "SEAT BELT" of this Service Manual.

WARNING:

- **To avoid rendering the SRS inoperative, which could increase the risk of personal injury or death in the event of a collision which would result in air bag inflation, all maintenance must be performed by an authorized NISSAN/INFINITI dealer.**
- **Improper maintenance, including incorrect removal and installation of the SRS, can lead to personal injury caused by unintentional activation of the system. For removal of Spiral Cable and Air Bag Module, see the "SRS AIRBAG".**
- **Do not use electrical test equipment on any circuit related to the SRS unless instructed to in this Service Manual. SRS wiring harnesses can be identified by yellow and/or orange harnesses or harness connectors.**

FOR MEXICO : Precaution Necessary for Steering Wheel Rotation After Battery Disconnect

INFOID:000000004409875

NOTE:

- This Procedure is applied only to models with Intelligent Key system and NVIS/IVIS (NISSAN/INFINITI VEHICLE IMMOBILIZER SYSTEM - NATS).
- Remove and install all control units after disconnecting both battery cables with the ignition knob in the "LOCK" position.
- Always use CONSULT-III to perform self-diagnosis as a part of each function inspection after finishing work. If DTC is detected, perform trouble diagnosis according to self-diagnostic results.

For models equipped with the Intelligent Key system and NVIS/IVIS, an electrically controlled steering lock mechanism is adopted on the key cylinder.

For this reason, if the battery is disconnected or if the battery is discharged, the steering wheel will lock and steering wheel rotation will become impossible.

If steering wheel rotation is required when battery power is interrupted, follow the procedure below before starting the repair operation.

OPERATION PROCEDURE

1. Connect both battery cables.

NOTE:

Supply power using jumper cables if battery is discharged.

2. Use the Intelligent Key or mechanical key to turn the ignition switch to the "ACC" position. At this time, the steering lock will be released.
3. Disconnect both battery cables. The steering lock will remain released and the steering wheel can be rotated.
4. Perform the necessary repair operation.
5. When the repair work is completed, return the ignition switch to the "LOCK" position before connecting the battery cables. (At this time, the steering lock mechanism will engage.)
6. Perform a self-diagnosis check of all control units using CONSULT-III.

PREPARATION

< PREPARATION >

PREPARATION

PREPARATION

Commercial Service Tool

INFOID:000000004380431

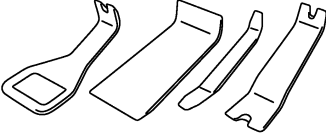
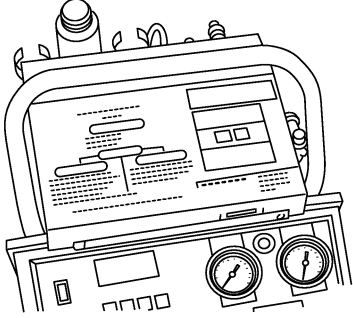
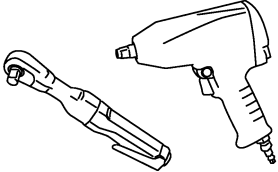
Tool name	Description
<p>Remover tool</p>  <p>PIIB7923J</p>	<p>Remove clips, pawls, metal clips</p>
<p>Refrigerant identifier equipment</p>  <p>RJIA0197E</p>	<p>Checking for refrigerant purity and system contamination</p>
<p>Power tool</p>  <p>PBIC0190E</p>	<p>For loosening bolts and nuts</p>

A

B

C

D

E

F

G

H

VTL

J

K

L

M

N

O

P

IN-CABIN MICROFILTER

< ON-VEHICLE MAINTENANCE >

ON-VEHICLE MAINTENANCE

IN-CABIN MICROFILTER

Exploded View

INFOID:000000004380432

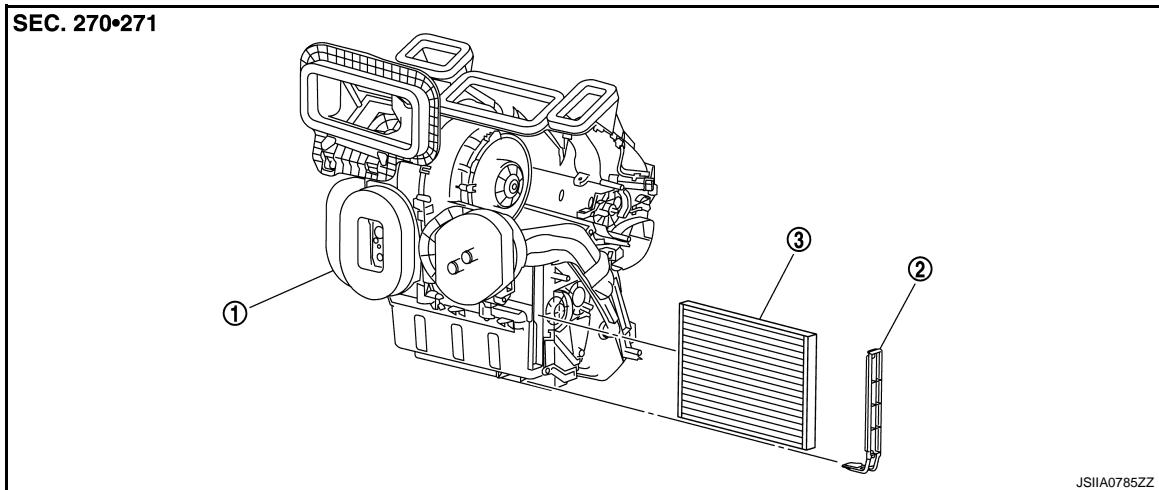

1. A/C unit assembly

2. Filter cover

3. In-cabin microfilter

Removal and Installation

INFOID:000000004380433

REMOVAL

1. Remove instrument driver lower cover. Refer to [IP-12, "Exploded View"](#).
2. Remove accelerator pedal assembly. Refer to [ACC-3, "Exploded View"](#).
3. Remove filter cover (1), and then remove in-cabin microfilter (2).

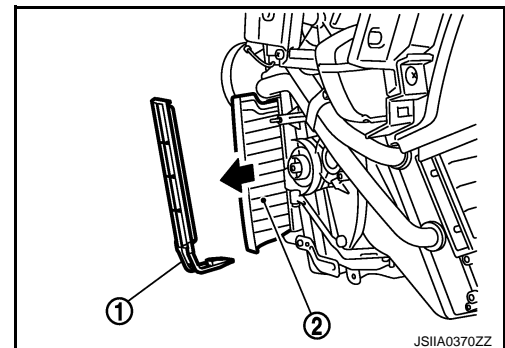

INSTALLATION

Installation is basically the reverse order of removal.

CAUTION:

- If the filter is deformed/damaged when removing, replace it with a new one. Deformed/damaged filter may deteriorate the duct collecting performance.
- When installing, handle the filter with extreme care to avoid deforming/damaging.

Replacement

INFOID:000000004380434

Replace in-cabin microfilter.

Refer to [MA-10, "FOR NORTH AMERICA : Schedule 1"](#) (FOR NORTH AMERICA), [MA-12, "FOR NORTH AMERICA : Schedule 2"](#) (FOR NORTH AMERICA) or [MA-13, "FOR MEXICO : Periodic Maintenance"](#) (FOR MEXICO).

Affix a caution label inside the glove box when replacing filter.

DUCT AND GRILLE

< ON-VEHICLE REPAIR >

ON-VEHICLE REPAIR

DUCT AND GRILLE

Exploded View

INFOID:000000004380436

FRONT

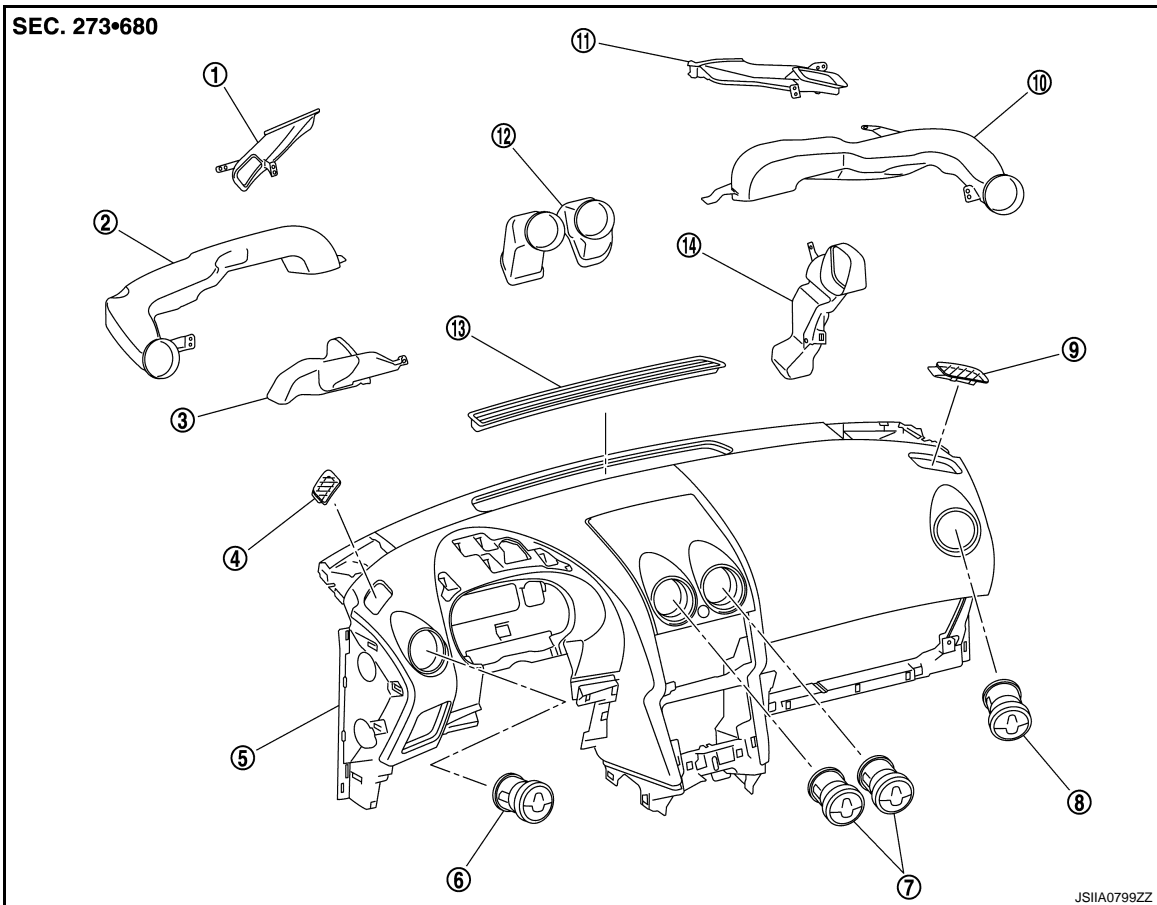

- | | | |
|-----------------------------|------------------------------|------------------------------|
| 1. Side defroster duct LH | 2. Side ventilator duct LH | 3. Front foot duct LH |
| 4. Side defroster grille LH | 5. Instrument panel | 6. Side ventilator grille LH |
| 7. Center ventilator grille | 8. Side ventilator grille RH | 9. Side defroster grille RH |
| 10. Side ventilator duct RH | 11. Side defroster duct RH | 12. Center ventilator duct |
| 13. Front defroster grille | 14. Front foot duct RH | |

REAR

A
B
C
D
E
F
G
H
VTL
J
K
L
M
N
O
P

DUCT AND GRILLE

< ON-VEHICLE REPAIR >

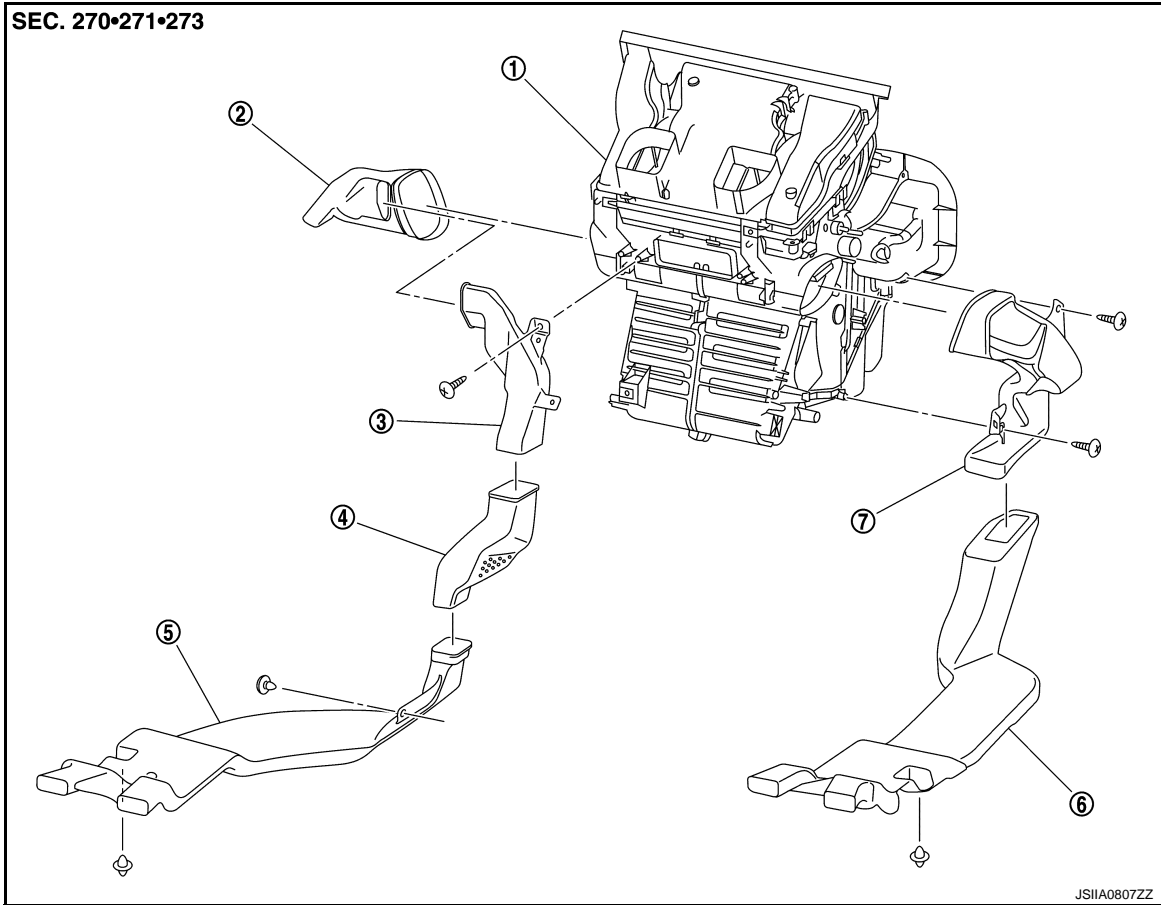

- | | | |
|-----------------------|------------------------|------------------------|
| 1. A/C unit assembly | 2. Front foot duct LH | 3. Rear foot duct 1 |
| 4. Rear foot duct 2 | 5. Rear foot duct 3 LH | 6. Rear foot duct 3 RH |
| 7. Front foot duct RH | | |

CENTER VENTILATOR GRILLE

CENTER VENTILATOR GRILLE : Removal and Installation

INFOID:000000004380437

REMOVAL

1. Remove cluster lid C. Refer to [IP-12. "Exploded View"](#).
2. Remove center ventilator grilles (1).
 - Using flat screwdriver to push the pawls.
 - Pull to remove center ventilator grilles from cluster lid C.

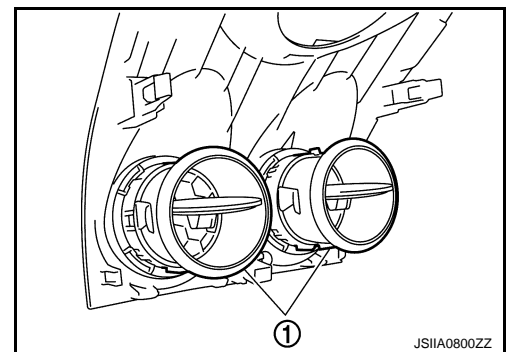

INSTALLATION

Installation is basically the reverse order of removal.

CENTER VENTILATOR DUCT

DUCT AND GRILLE

< ON-VEHICLE REPAIR >

CENTER VENTILATOR DUCT : Removal and Installation

INFOID:000000004380438

REMOVAL

1. Remove instrument panel. Refer to [IP-12, "Exploded View"](#).
2. Remove screw (A), and then remove center ventilator duct (1).

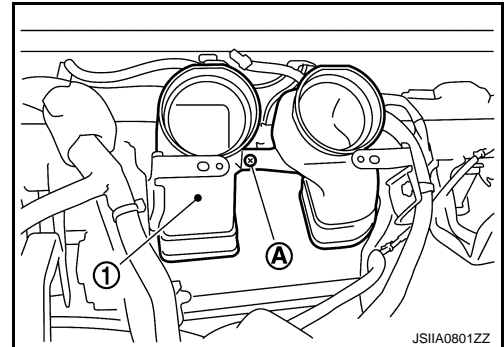

INSTALLATION

Installation is basically the reverse order of removal.

SIDE VENTILATOR GRILLE

SIDE VENTILATOR GRILLE : Removal and Installation

INFOID:000000004380439

REMOVAL

1. Remove side ventilator duct. Refer to [VTL-9, "Exploded View"](#).
2. Remove side ventilator grilles (1).
 - Using flat screwdriver to push the pawls.
 - Pull to remove center ventilator grilles from instrument panel.

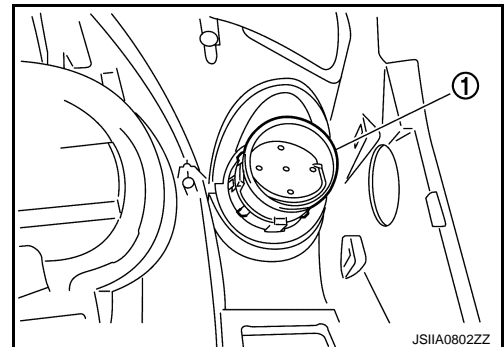

INSTALLATION

Installation is basically the reverse order of removal.

SIDE VENTILATOR DUCT

SIDE VENTILATOR DUCT : Removal and Installation

INFOID:000000004380440

REMOVAL

1. Remove instrument panel. Refer to [IP-12, "Exploded View"](#).

A
B
C
D
E
F
G
H
VTL
J
K
L
M
N
O
P

DUCT AND GRILLE

< ON-VEHICLE REPAIR >

2. Remove screws (A), and then remove side ventilator duct RH (1).

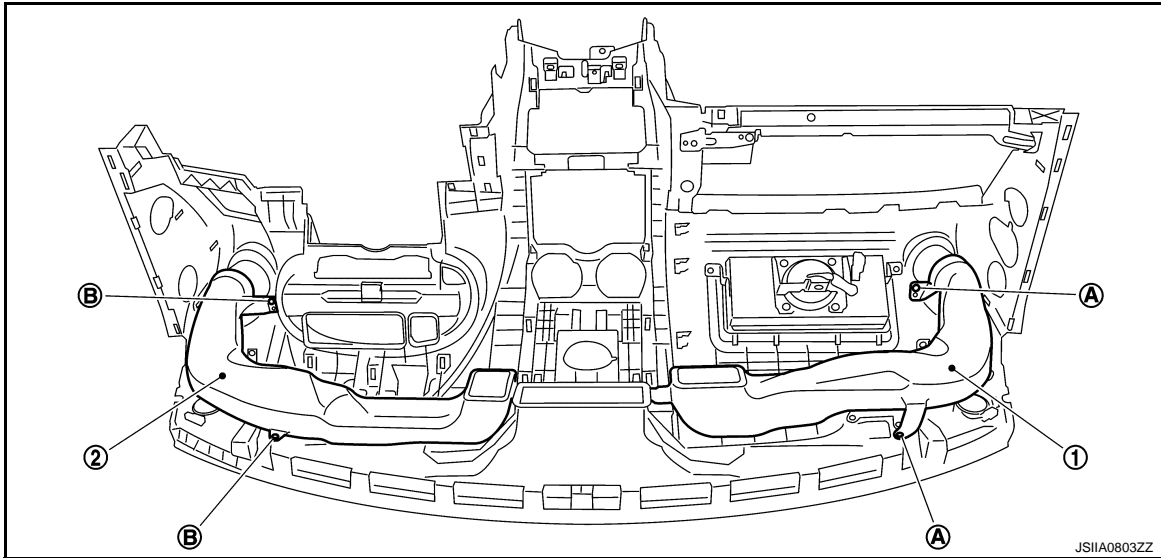

3. Remove screws (B), and then remove side ventilator duct LH (2).

INSTALLATION

Installation is basically the reverse order of removal.

SIDE DEFROSTER GRILLE

SIDE DEFROSTER GRILLE : Removal and Installation

INFOID:000000004380441

REMOVAL

Using remover tool, remove side defroster grilles (1).

CAUTION:

Use shop cloth and all other protection necessities to avoid damage.

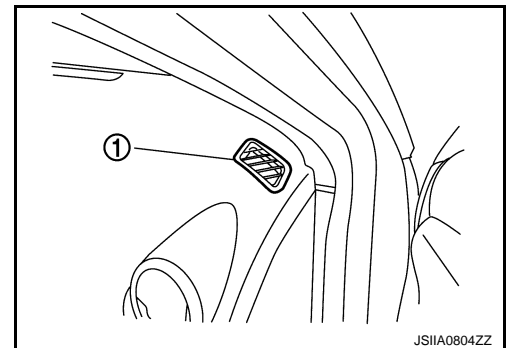

INSTALLATION

Installation is basically the reverse order of removal.

SIDE DEFROSTER DUCT

SIDE DEFROSTER DUCT : Removal and Installation

INFOID:000000004380442

REMOVAL

1. Remove side ventilator duct. Refer to [VTL-9, "Exploded View"](#).

DUCT AND GRILLE

< ON-VEHICLE REPAIR >

2. Remove screws (A), and then remove side defroster duct RH (1).

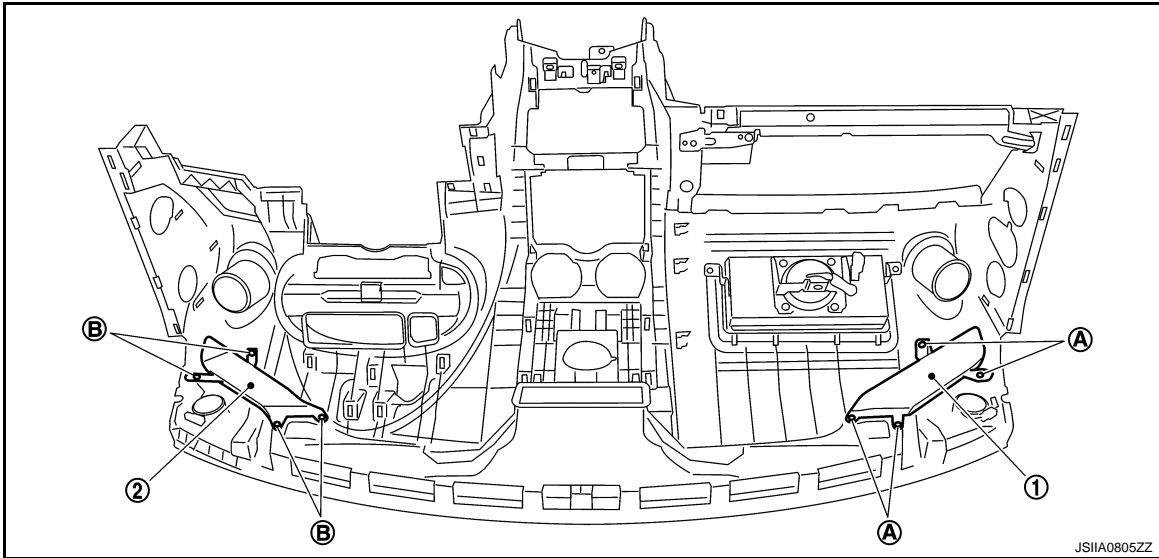

3. Remove screws (B), and then remove side defroster duct LH (2).

INSTALLATION

Installation is basically the reverse order of removal.

FRONT DEFROSTER GRILLE

FRONT DEFROSTER GRILLE : Removal and Installation

INFOID:000000004380443

REMOVAL

Using remover tool, remove front defroster grille (1).

CAUTION:

Use shop cloth and all other protection necessities to avoid damage.

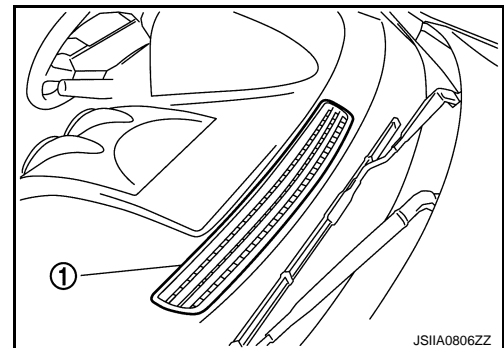

INSTALLATION

Installation is basically the reverse order of removal.

FRONT FOOT DUCT

FRONT FOOT DUCT : Removal and Installation

INFOID:000000004380444

REMOVAL

Driver side

1. Remove instrument driver lower cover. Refer to [IP-12, "Exploded View"](#).
2. Remove knee protector. Refer to [IP-12, "Exploded View"](#).
3. Remove rear foot duct 1 (with rear foot duct). Refer to [VTL-9, "Exploded View"](#).
4. Remove front foot duct LH.

Passenger side

1. Remove glove box assembly. Refer to [IP-12, "Exploded View"](#).
2. Remove mounting screws, and then remove front foot duct RH.

INSTALLATION

A

B

C

D

E

F

G

H

VTL

J

K

L

M

N

O

P

DUCT AND GRILLE

< ON-VEHICLE REPAIR >

Installation is basically the reverse order of removal.

REAR FOOT DUCT 1

REAR FOOT DUCT 1 : Removal and Installation

INFOID:000000004380445

REMOVAL

1. Remove cluster lid C. Refer to [IP-12, "Exploded View"](#).
2. Remove screw, and then remove rear foot duct 1.

INSTALLATION

Installation is basically the reverse order of removal.

REAR FOOT DUCT 2

REAR FOOT DUCT 2 : Removal and Installation

INFOID:000000004380446

REMOVAL

1. Remove instrument lower cover LH. Refer to [IP-12, "Exploded View"](#).
2. Remove rear foot duct 2. Refer to [VTL-9, "Exploded View"](#).

INSTALLATION

Installation is basically the reverse of removal.

REAR FOOT DUCT 3

REAR FOOT DUCT 3 : Removal and Installation

INFOID:000000004380447

REMOVAL

Driver side

1. Peel back floor carpet to a point where rear foot duct 3 LH is visible. Refer to [INT-21, "Exploded View"](#).
2. Remove clips, and then remove rear foot duct 3 LH.

Passenger side

1. Peel back floor carpet to a point where rear foot duct 3 RH is visible. Refer to [INT-21, "Exploded View"](#).
2. Remove clip, and then remove rear foot duct 3 RH.

INSTALLATION

Installation is basically the reverse of removal.

BLOWER MOTOR

< ON-VEHICLE REPAIR >

BLOWER MOTOR

Exploded View

INFOID:000000004380448

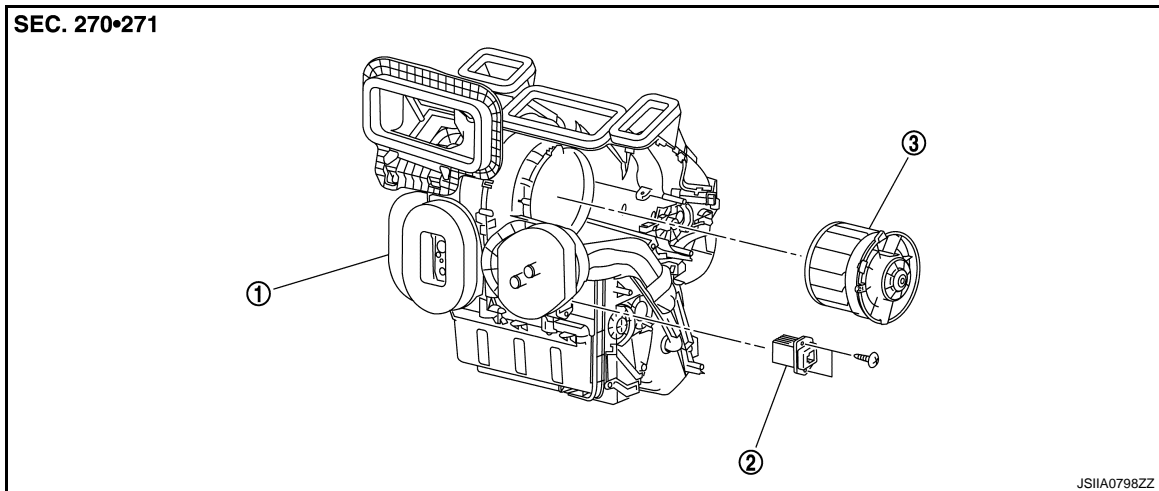

1. A/C unit assembly

2. Fan control amp.

3. Blower motor

Removal and Installation

INFOID:000000004380449

REMOVAL

1. Remove instrument driver lower cover. Refer to [IP-12, "Exploded View"](#).
2. Remove combination meter. Refer to [MWI-86, "Exploded View"](#).
3. Remove knee protector. Refer to [IP-12, "Exploded View"](#).
4. Remove foot duct LH. Refer to [VTL-9, "Exploded View"](#).
5. Remove mode door motor. Refer to [HAC-91, "Exploded View"](#).
6. Remove brake pedal assembly and accelerator pedal. Refer to [BR-18, "Exploded View"](#).
7. Disconnect blower motor connector (A).
8. Press flange holding hook (1). Then turn blower motor counter-clockwise (2).
9. Pull outside (3) and remove blower motor.

CAUTION:

The balance is adjusted when blower fan and blower motor are assembled, so do not replace the individual parts.

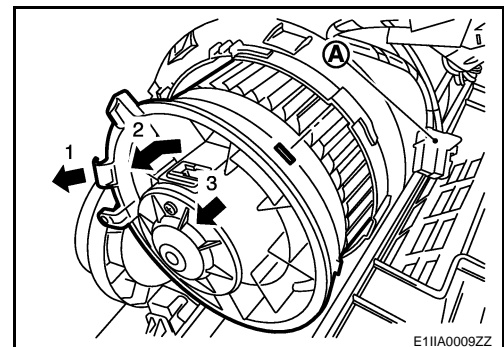

INSTALLATION

Installation is basically the reverse order of removal.

CAUTION:

Install correctly blower motor flange holding hook in A/C unit assembly.

FAN CONTROL AMPLIFIER

< ON-VEHICLE REPAIR >

FAN CONTROL AMPLIFIER

Exploded View

INFOID:000000004413677

Refer to [VTL-15, "Exploded View"](#).

Removal and Installation

INFOID:000000004413678

REMOVAL

1. Remove instrument driver lower cover. Refer to [IP-12, "Exploded View"](#).
2. Remove accelerator pedal assembly. Refer to [ACC-3, "Exploded View"](#).
3. Disconnect fan control amp. connector.
4. Remove mounting screws, and then remove fan control amp.

INSTALLATION

Installation is basically the reverse order of removal.