

NOTICE TO ALL PERSONS RECEIVING THIS DRAWING
 CONFIDENTIAL: Reproduction forbidden without the specific written permission of Atari Games Corporation, Sunnyvale, CA. This drawing is only conditionally issued, and neither receipt nor possession thereof confers any right in, or license to use, the subject matter of the drawing or any design or technical information shown thereon, nor any right to reproduce this drawing or any part thereof. Except for manufacture by vendors of Atari Games Corporation, and for manufacture under the corporation's written license, no right is granted to reproduce this drawing or the subject matter thereof, unless by written agreement with or written permission from the corporation.

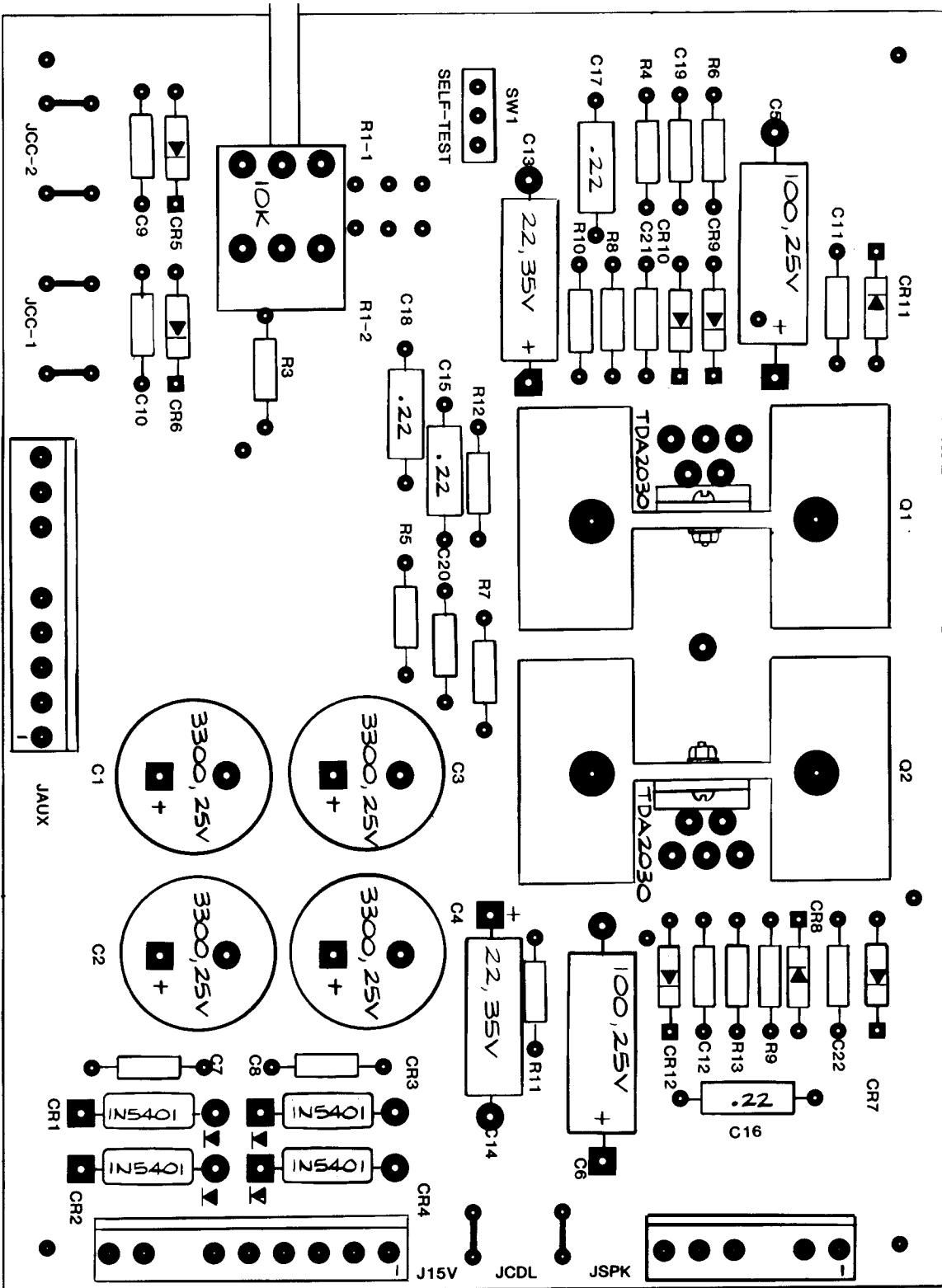

**Figure 5-9 Audio PCB Assembly
 A043354-01 B**

Audio PCB Assembly Parts List

Designator	Description	Part No.
C1-C4	Capacitor, Electrolytic, 3300 μ f, 25 V	123003-338
C5, C6	Capacitor, Electrolytic, 100 μ f, 25 V	24-250107
C7-C12	Capacitor, Ceramic, .1 μ f, 25 V	122002-104
C13, C14	Capacitor, Electrolytic, 22 μ f, 35 V	24-350226
C15-C18	Capacitor, Ceramic, .22 μ f, 25 V	122006-224
C19, C20	Capacitor, Ceramic, .001 μ f, 25 V	122002-102
C21, C22	Capacitor, Ceramic, .1 μ f, 25 V	122002-104
CR1-4	Diode, 1N5401, 100 V, 3A	31-1N5401
CR5-12	Diode, 1N4001, 50 V	31-1N4001
J15V	Connector, Header, 9 Ckt., .156 Ctr.	179213-009
JAUX	Connector, Header, 9 Ckt., .156 Ctr.	179213-009
JCC-1, JCC-2	Term, Fast-on Tab, .187 \times .020	179051-001
JCDL	Term, Fast-on Tab, .187 \times .020	179051-001
JSPK	Connector, Header, 6 Ckt., .156 Ctr.	179213-006
Q1, Q2	Amplifier, TDA-2030	137301-001
R1	Resistor, Pot, 10 k Ω , Dual	119011-103
R3	Resistor, 10 Ω , \pm 5%, 1/4 W	110000-100
R4-R7	Resistor, 22 k Ω , \pm 5%, 1/4 W	110000-223
R8, R9	Resistor, 10 k Ω , \pm 5%, 1/4 W	110000-103
R10, R11	Resistor, 1 k Ω , \pm 5%, 1/4 W	110000-102
R12, R13	Resistor, 1 Ω , \pm 5%, 1/4 W	110000-010
SW1	Self-Test Switch, Slide, Miniature, SPDT	66-004
	Heat Sink, TO-220	178190-032
	Screw, Pan-Head, Cross-Recessed, #6-32 \times 3/8-Inch Long	72-1606S
	Nut/Washer Assy, #6-32	75-99516

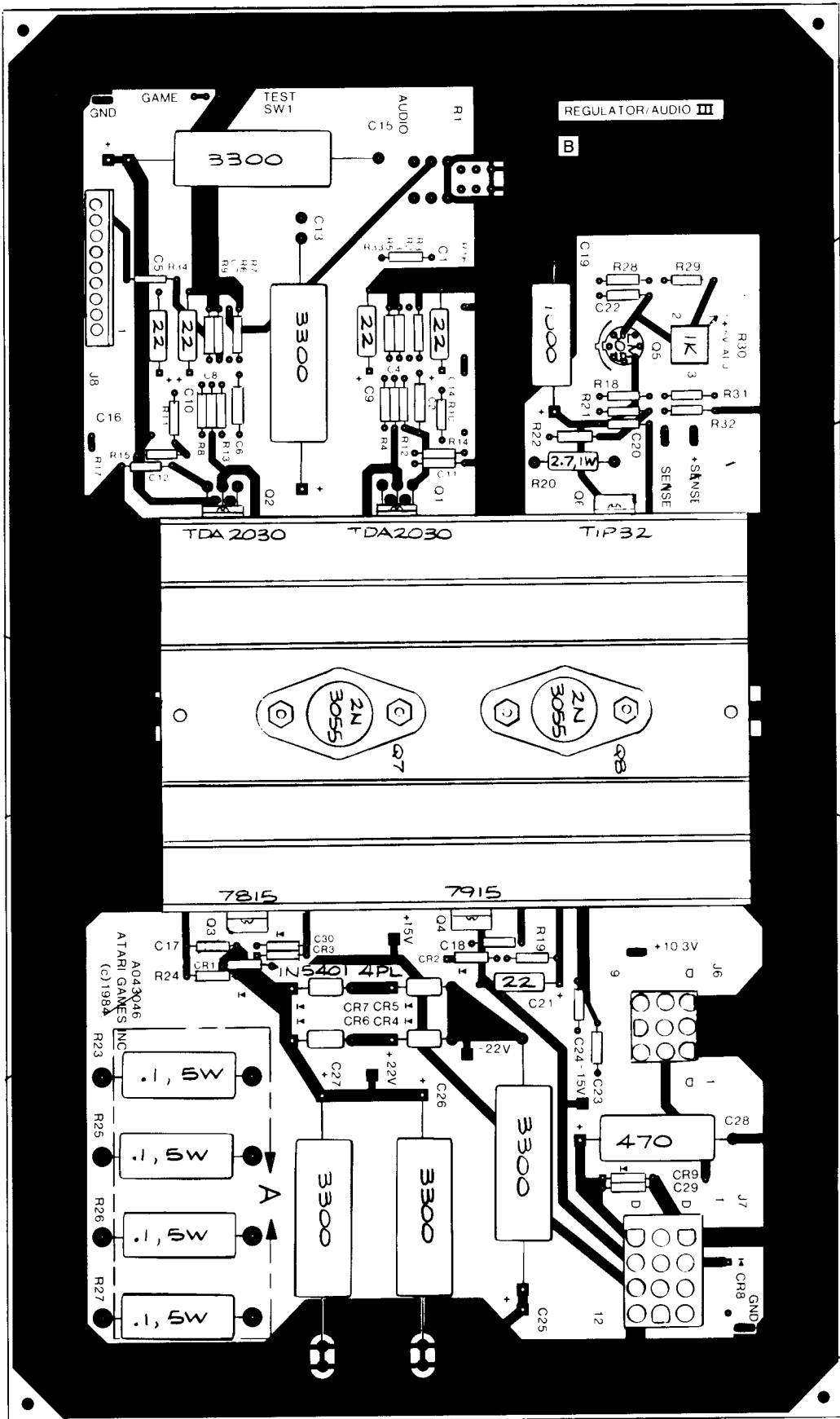

CONFIDENTIAL. Reproduction forbidden without the specific written permission of Atari Games Corporation, Sunnyvale, CA. This drawing is only conditionally issued and neither repair nor possession thereof confers any right in, or license to use, the subject matter of the drawing or any design or technical information shown thereon, nor any right to reproduce this drawing or any part thereof. Except for manufacture by vendors of Atari Games Corporation, and for manufacture under the corporation's written license, no right is granted to reproduce this drawing or the subject matter thereof, unless by written agreement with or written permission from the corporation.

NOTICE TO ALL PERSONS RECEIVING THIS DRAWING

**Figure 5-10 Regulator/Audio III Printed-Circuit Board Assembly
A043046-01 C**

Regulator/Audio III Printed-Circuit Board Assembly Parts List

Designator	Description	Part No.
Capacitors		
C1	22 μ F, 35 V Electrolytic Capacitor	24-350226
C2	0.22 μ F, 25 V Ceramic Capacitor	122004-224
C3	0.001 μ F, 50 V Ceramic Capacitor	122002-102
C4	0.1 μ F, 50 V Ceramic Capacitor	122002-104
C5	22 μ F, 35 V Electrolytic Capacitor	24-350226
C6	0.22 μ F, 25 V Ceramic Capacitor	122004-224
C7	0.001 μ F, 50 V Ceramic Capacitor	122002-102
C8	0.1 μ F, 50 V Ceramic Capacitor	122002-104
C9, C10	22 μ F, 35 V Electrolytic Capacitor	24-350226
C11, C12	0.1 μ F, 50 V Ceramic Capacitor	122002-104
C13	3300 μ F, 35 V Electrolytic Capacitor	24-350338
C14	0.22 μ F, 25 V Ceramic Capacitor	122004-224
C15	3300 μ F, 35 V Electrolytic Capacitor	24-350338
C16	0.22 μ F, 25 V Ceramic Capacitor	122004-224
C17, C18	0.1 μ F, 50 V Ceramic Capacitor	122002-104
C19	1000 μ F, 25 V Electrolytic Capacitor	24-250108
C20	0.1 μ F, 50 V Ceramic Capacitor	122002-104
C21	22 μ F, 35 V Electrolytic Capacitor	24-350226
C22	0.001 μ F, 50 V Ceramic Capacitor	122002-102
C23, C24	0.1 μ F, 50 V Ceramic Capacitor	122002-104
C25-C27	3300 μ F, 35 V Electrolytic Capacitor	24-350338
C28	470 μ F, 25 V Electrolytic Capacitor	24-250477
C29, C30	0.1 μ F, 50 V Ceramic Capacitor	122002-104
Connectors		
J6	9-Position Header Connector	179069-009
J7	12-Position Header Connector	179069-012
J8	9-Position Polarized Header Connector with .156-Inch Centers	179213-009
Diodes		
CR1-CR3	Type-1N4002 Diode	31-1N4002
CR4-CR7	Type-1N5401 Rectifier Diode	31-1N5401
CR9	Type-1N4002 Diode	31-1N4002
Resistors		
R3	12 k Ω , \pm 5%, 1/4 W Resistor	110000-123
R4, R5	100 k Ω , \pm 5%, 1/4 W Resistor	110000-104
R7	12 k Ω , \pm 5%, 1/4 W Resistor	110000-123
R8, R9	100 k Ω , \pm 5%, 1/4 W Resistor	110000-104
R10, R11	1 k Ω , \pm 5%, 1/4 W Resistor	110000-102
R12, R13	100 k Ω , \pm 5%, 1/4 W Resistor	110000-104
R14, R15	10 k Ω , \pm 5%, 1/4 W Resistor	110000-103
R18	100 Ω , \pm 5%, 1/4 W Resistor	110000-101

(Continued on next page)

Regulator/Audio III Printed-Circuit Board Assembly Parts List, continued

Designator	Description	Part No.
R19	5.6 k Ω , \pm 5%, ¼ W Resistor	110000-562
R20	2.7 Ω , \pm 5%, 1 W Resistor	110009-027
R21	27 Ω , \pm 5%, ¼ W Resistor	110000-270
R22	100 Ω , \pm 5%, ¼ W Resistor	110000-101
R23	0.1 Ω , \pm 5%, 5 W Resistor	116007-001
R24	5.6 k Ω , \pm 5%, ¼ W Resistor	110000-562
R25-R27	0.1 Ω , \pm 5%, 5 W Resistor	116007-001
R28	2.7 Ω , \pm 5%, ¼ W Resistor	110000-027
R29	7.5 k Ω , \pm 5%, ¼ W Resistor	110000-752
R31	3.9 k Ω , \pm 5%, ¼ W Resistor	110000-392
R32	2.7 Ω , \pm 5%, ¼ W Resistor	110000-027
R33, R34	22 k Ω , \pm 5%, ¼ W Resistor	110000-223
Transistors		
Q6	TIP-32 Transistor	33-TIP32
Q7, Q8	Type-2N3055 Transistor	34-2N3055
Miscellaneous		
Q1, Q2	Type-TDA-2030 Amplifier	137301-001
Q3	Type-7815, + 15 V Regulator	37-7815
Q4	Type-7915, - 15 V Regulator	37-7915
Q5	Type-LM305 Regulator	37-LM305
R30	1k Horizontal Potentiometer	119002-102
(Q4, Q6)	Thermal Insulator	78-16014
(Q7, Q8)	Thermally Conductive Insulator	78-16008
	RTV Silicon Rubber Sealing Compound	78-13003
	Heat Sink	034531-01
	Test Point (Acceptable substitute is part no. 020670-01)	179051-002